

HADLEIGH
RESIDENTIAL



ETON COLLEGE ROAD, **NW3**

£2,000 PCM

GENEROUSLY PROPORTIONED THROUGHOUT | ONE BEDROOM APARTMENT | 593 SQ. FT. | THIRD FLOOR WITH LIFT |
PURPOSE BUILT BUILDING | GREAT LOCATION FOR BOTH BELSIZE PARK AND CHALK FARM | WELL PRESENTED THROUGHOUT



DESCRIPTION

A generously proportioned one bedroom apartment on the third floor (with lift) of this popular, well presented purpose built block between Chalk Farm and Belsize Park stations. The apartment is well presented throughout and comprises of a bright and generous reception room, separate kitchen, great size double bedroom with fitted wardrobes and bathroom. Offered furnished and available immediately.

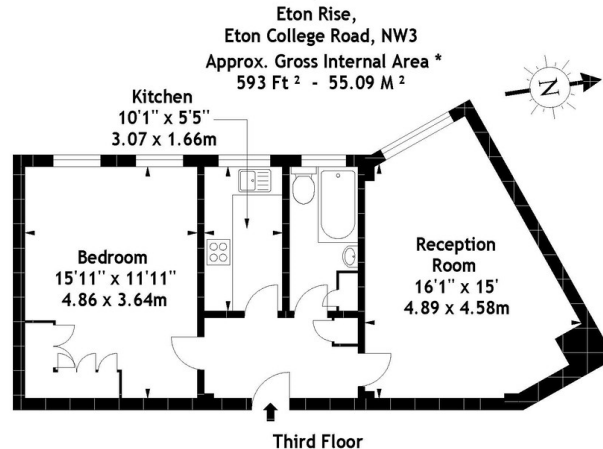

Illustration For Identification Purposes Only. Not To Scale
* As Defined by RICS - Code of Measuring Practice
© International Floorplans.
Tel 0094 115 345958
www.ifplk

ENERGY EFFICIENCY RATING C.