



Property Summary

*** No Chain *** Very nicely presented little starter home for sale in a popular suburb of Oadby. Close to a range of local schools, good bus routes and other shops and amenities. The accommodation comprises entrance hall, kitchen, lounge diner, two double bedrooms, shower room, rear garden and allocated parking.



GROUND FLOOR
267 sq.ft. (24.8 sq.m.) approx.

1ST FLOOR
274 sq.ft. (25.5 sq.m.) approx.

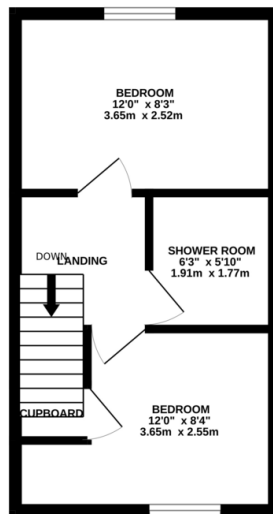
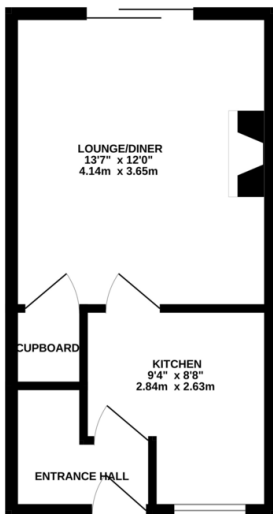

TOTAL FLOOR AREA: 541 sq.ft. (50.3 sq.m.) approx.
Whilst every attempt has been made to ensure the accuracy of the floorplan, measurements of doors, windows, rooms and any other items are approximate and no responsibility is taken for any error, omission or mis-statement. This plan is for illustrative purposes only and should be used as such for any prospective purchaser. The services, systems and appliances shown have not been tested and no guarantee as to their operability or efficiency can be given.
Made with Metropix C2023

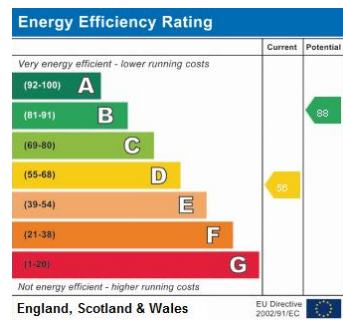

- No Chain
- Two Double Bedrooms
- Mid Town House
- Allocated Parking
- Well Presented Throughout
- Quiet Cul-De-Sac
- Modern Shower Room
- Popular Location

phillips george | sales & lettings

Agents Note: Whilst every care has been taken to prepare these sales particulars, they are for guidance purposes only. All measurements are approximate and for general guidance purposes only and whilst every care has been taken to ensure their accuracy, they should not be relied upon and potential buyers are advised to recheck the measurements

46 Long Street, Wigston, Leicestershire, LE18 2AH

info@phillipsgeorge.co.uk
0116 216 8178

