



THE
ASHFORD

A three bedroom
semi-detached home



BLUEBELL
HOMES

CGI shows two semi-detached Ashford homes. Elevational treatments may vary by plot.

THE ASHFORD

A three bedroom semi-detached home

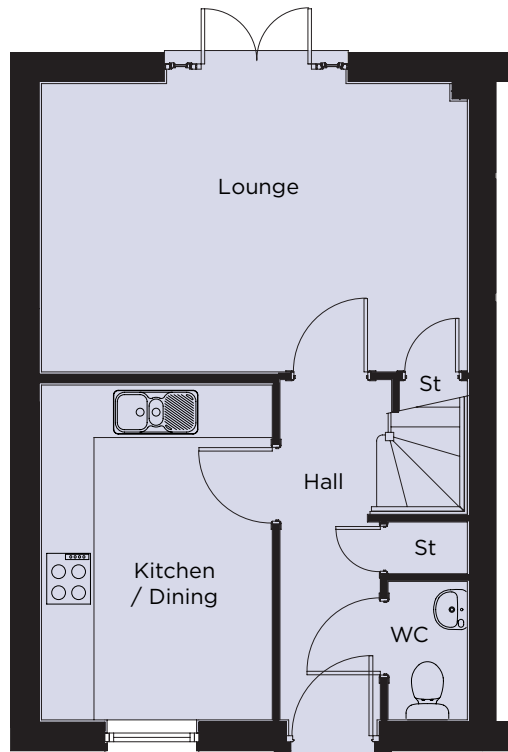

Ground Floor

Kitchen / Dining	3.83m x 2.64m	12'7" x 8'8"
Lounge	4.87m x 3.3m	16'0" x 10'10"

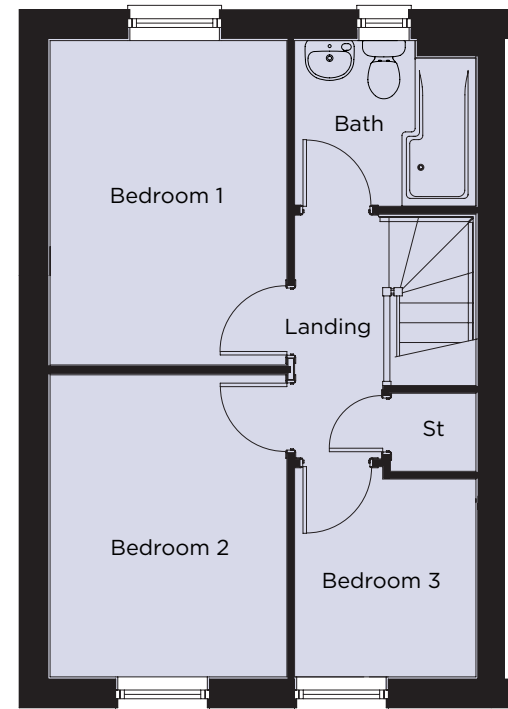

First Floor

Bedroom 1	3.72m x 2.71m	12'3" x 8'11"
Bedroom 2	3.46m x 2.71m	11'4" x 8'11"
Bedroom 3	2.26m x 2.06m	7'5" x 6'9"

**CONSUMER
CODE FOR
HOME BUILDERS**

www.consumercode.co.uk

These images are designed to give an impression of the development and our housetypes - they may not reflect a specific plot and do not form part of any contract. Final finishes, landscaping and detail will vary. This information has been provided in good faith, however all layouts and measurements are approximate only. Some house types include areas of reduced headroom. Bathroom and kitchen layouts are indicative only and designs may change due to our process of continuous product development. Images used in marketing materials may be computer generated or photography of previous developments. Dimensions are taken to the maximum.



**BLUEBELL
HOMES**