



2

Bedrooms

1

Bathroom





**** ATTENTION FIRST TIME BUYERS** - TRADING PLACES** Estate Agents are delighted to offer for sale a modern TWO BEDROOM TOWN HOUSE in a highly convenient location. Situated within walking distance to the recently built Partington shopping centre as well as a short distance to major road and transport networks, this property would suit a variety of prospective purchasers due to it offering NO VENDOR CHAIN. In brief the well presented accommodation comprises; entrance hallway, downstairs WC, a spacious living room with double patio doors leading out to the rear garden, modern fitted kitchen. To the first floor there are TWO BEDROOMS and a modern three piece bathroom suite. The property is gas central heated and uPVC double glazed throughout. Externally the property benefits from an paved garden leading to a single driveway whilst to the front a small garden area. This modern property is ready to move straight into and will appeal to a first time buyer or alternatively a buy to let investor or downsize. An internal inspection is strongly recommended.

GROUND FLOOR

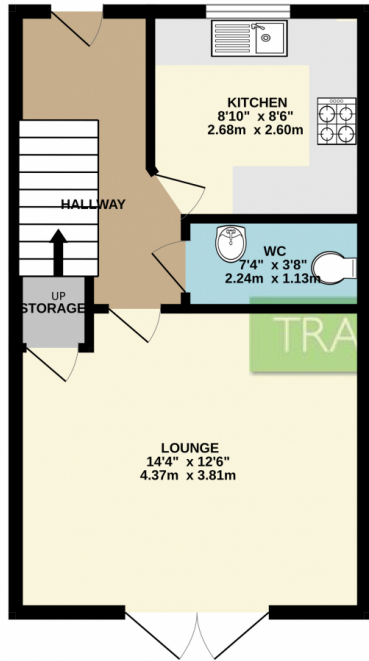

1ST FLOOR

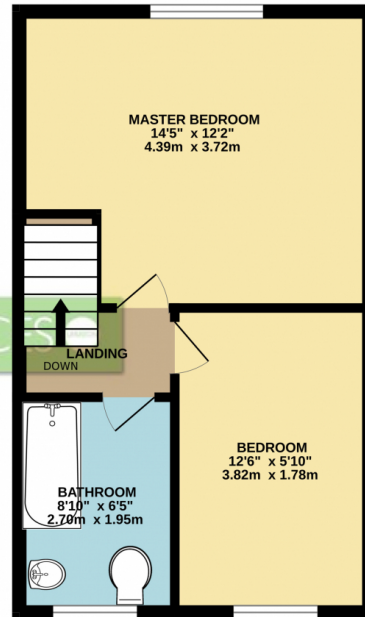

Whilst every attempt has been made to ensure the accuracy of the floorplan contained here, measurements of doors, windows, rooms and any other items are approximate and no responsibility is taken for any error, omission or mis-statement. This plan is for illustrative purposes only and should be used as such by any prospective purchaser. The services, systems and appliances shown have not been tested and no guarantee as to their operability or efficiency can be given.
Made with Metropix ©2023

