



Keswick

Offers over £100,000

Flat 35 Homethwaite House, Eskin Street, Keswick, Cumbria, CA12 4DG

A one bedroom second floor retirement apartment forming part of a private and secure purpose built complex most conveniently situated on a side street within walking distance of Keswick town centre.

Quick Overview

- Second floor one bedroom retirement apartment
- Purpose built private and secure complex
- Fitted kitchen and bathroom
- Residents' lounge and complex manager
- On site laundrette
- 24 hour emergency call system



1



1



1



C



Superfast
80Mbps

Property Reference: KW0275



Living / Dining Room



Living / Dining Room



Living / Dining Room



Kitchen

Accommodation

Ground Floor:

Communal Entrance Hall

With security intercom entrance system, lift and stair case to upper floors.

Second Floor:

Communal Landing

Self Contained Entrance Hall

With telecom entry system control, emergency pull cord, built in cupboard.

Living / Dining Room 17' 5" x 10' 7" (5.31m x 3.23m)

With wall mounted electric heater, emergency pull cord.

Kitchen 7' 3" x 5' 4" (2.21m x 1.63m)

With fitted base and wall units, integrated electric oven, hob and extractor unit, integrated fridge, stainless steel sink unit with mixer tap, ceramic wall tiling.

Double Bedroom 13' 11" x 8' 7" (4.24m x 2.62m)

With built in wardrobe, wall mounted electric heater, emergency pull cord.

Shower Room

With WC, vanity wash hand basin, shower cubicle, heated towel rail, ceramic wall tiling.

Services

Mains water, electricity, and drainage. Electric heating. Pull cord 24 hour emergency call system.

Tenure

Leasehold with a 125 year lease from 1987.

Ground Rent

We are advised the current ground rent payable is £246.87 every 6 months.

Service Charge

We are advised that the current service charge payable is £1697.94 every 6 months.

Occupancy Conditions

Single residents must be aged 60 or over. A secondary resident must be aged 55 or over.

Council Tax

Band B.

Viewings

By appointment with Hackney & Leigh's Keswick office.

Directions

From Keswick town centre proceed from Station Street onto St John's Street and then continue onto Ambleside Road. Eskin Street is the first turning on the left after Acorn Street.

Price

Offers over £100,000 are invited for consideration.



Kitchen



Double Bedroom



Double Bedroom



Shower Room

Flat 35, Homethwaite House, Keswick

Approximate Area = 431 sq ft / 40 sq m

For identification only - Not to scale

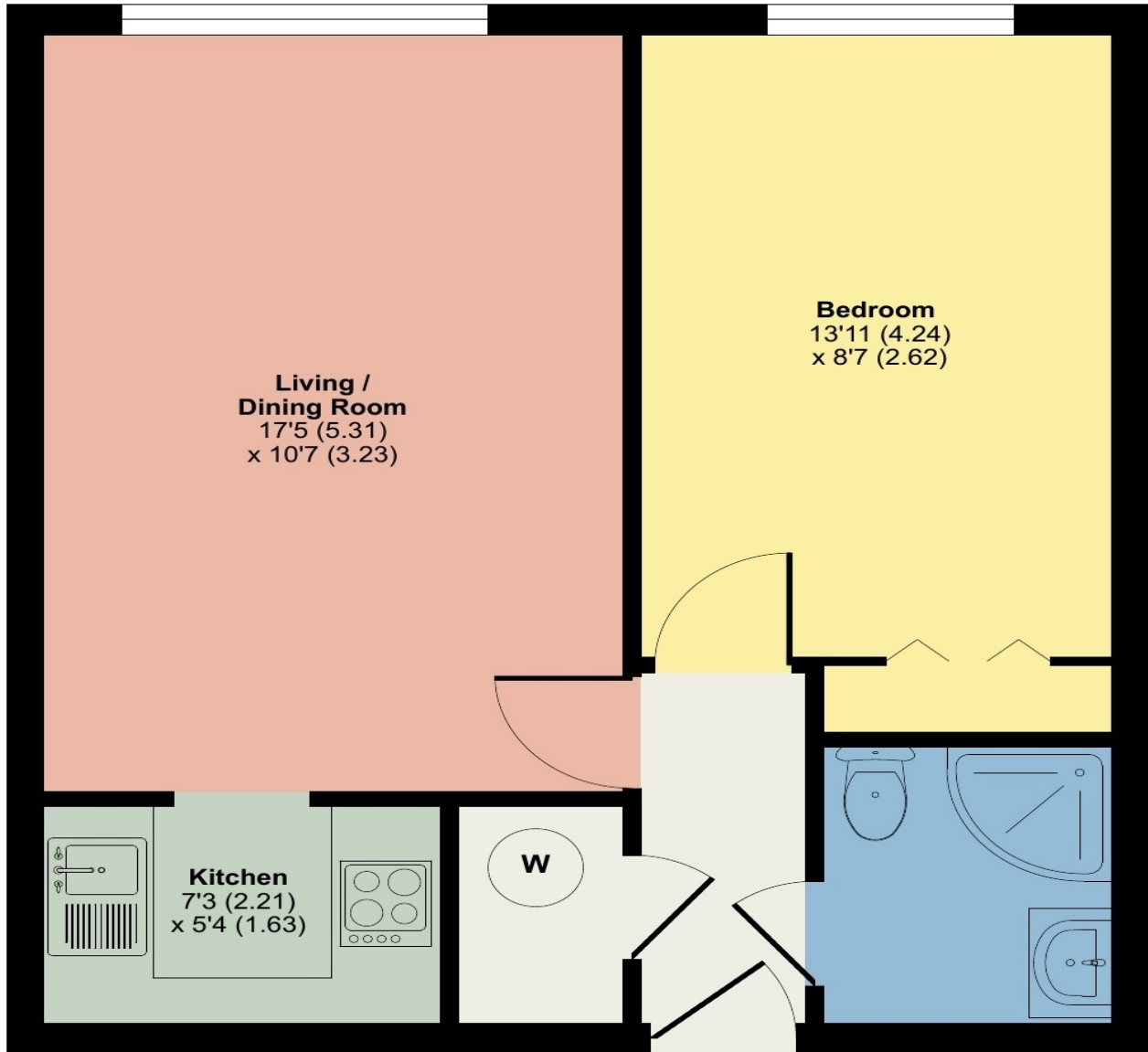

GROUND FLOOR



Floor plan produced in accordance with RICS Property Measurement Standards incorporating International Property Measurement Standards (IPMS2 Residential). © nīchecom 2023. Produced for Hackney & Leigh. REF: 1006789

All permits to view and particulars are issued on the understanding that negotiations are conducted through the agency of Messrs. Hackney & Leigh Ltd. Properties for sale by private treaty are offered subject to contract. No responsibility can be accepted for any loss or expense incurred in viewing or in the event of a property being sold, let, or withdrawn. Please contact us to confirm availability prior to travel. These particulars have been prepared for the guidance of intending buyers. No guarantee of their accuracy is given, nor do they form part of a contract. Broadband speeds estimated and checked by <https://checker.ofcom.org.uk/en-gb/broadband-coverage> on 14/07/2023.

Request a Viewing Online or Call 01768 741741