



LAWRENCE RAND

23 Bempton Drive, Ruislip

Guide Price **£575,000**



23 Bempton Drive

Ruislip, Ruislip

Four-bedroom, two-bathroom extended terraced house offering comfortable family living accommodation over three floors situated in a popular road close proximity to Ruislip Manor and its array amenities and transport links.

Council Tax band: D

Tenure: Freehold

- Two bathrooms
- Modern kitchen
- Off street parking
- En-suite shower-room
- Close to amenities
- Four bedrooms







Bempton Drive, Ruislip, Middlesex, HA4

Approximate Area = 1203 sq ft / 112 sq m (includes garage)

For identification only - Not to scale

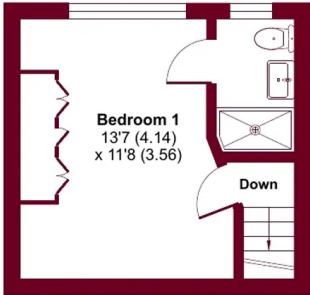
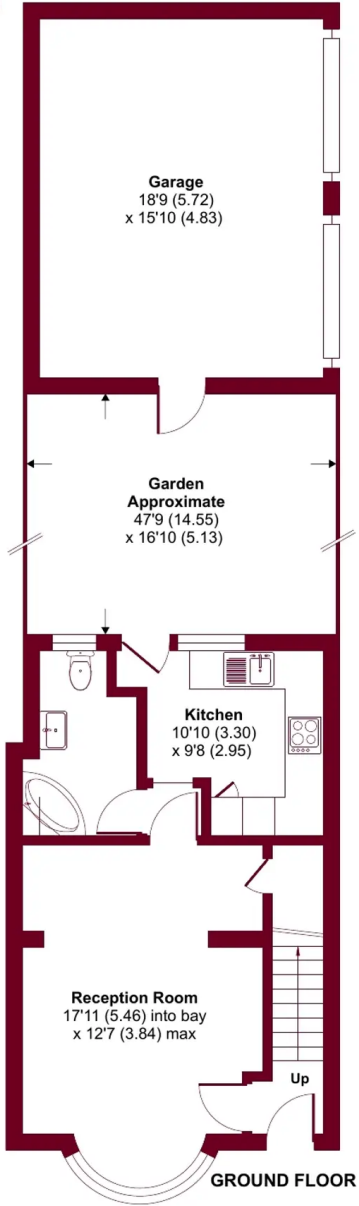

SECOND FLOOR

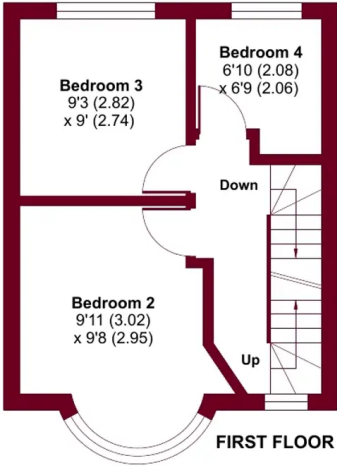

FIRST FLOOR





Lawrence Rand

Lawrence Rand, 106 Victoria Road - HA4 0AL

01895 632211

Info@lawrence-rand.co.uk

www.lawrence-rand.co.uk/



LAWRENCE RAND