

Handley Place

Handley Place, Locking, BS24 7LX



BLOCK 6



1 & 2 bedroom apartments



Floors 1, 2 and 3

Apartments 172 to 189

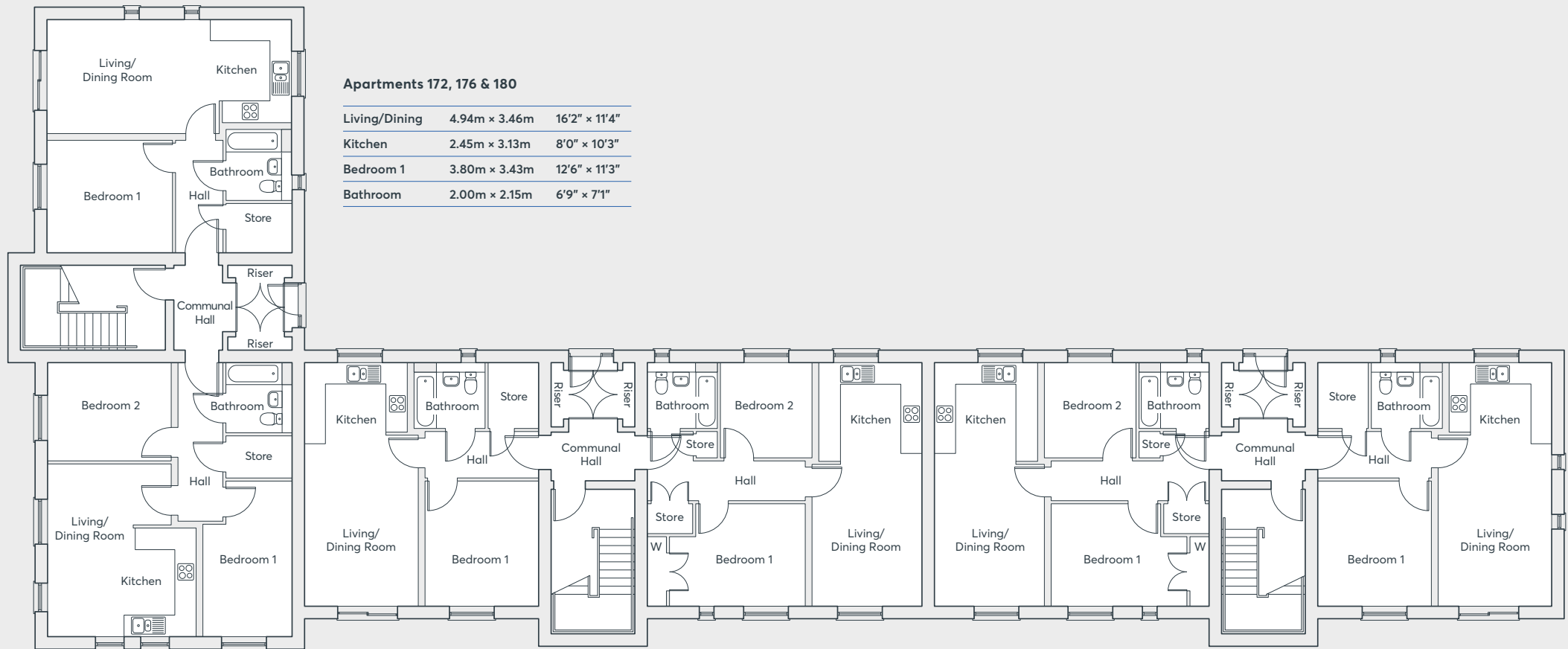

Apartments 172, 176 & 180

Living/Dining	4.94m x 3.46m	16'2" x 11'4"
Kitchen	2.45m x 3.13m	8'0" x 10'3"
Bedroom 1	3.80m x 3.43m	12'6" x 11'3"
Bathroom	2.00m x 2.15m	6'9" x 7'1"

Apartments 173, 177 & 181

Living/Dining/Kitchen	4.50m x 5.23m	14'9" x 17'2"
Bedroom 1	2.70m x 4.70m	8'10" x 15'6"
Bedroom 2	3.78m x 3.00m	12'4" x 9'10"
Bathroom	2.00m x 2.15m	6'7" x 7'1"

Apartments 174, 178, 182

Living/Dining	3.46m x 4.94m	11'4" x 16'2"
Kitchen	3.17m x 2.45m	10'3" x 8'0"
Bedroom 1	3.45m x 3.80m	11'4" x 12'7"
Bathroom	2.15m x 2.00m	7'1" x 6'7"

Apartments 175, 179, 183

Living/Dining	3.35m x 4.64m	11'0" x 15'2"
Kitchen	3.13m x 2.99m	10'3" x 9'10"
Bedroom 1	4.09m x 3.12m	13'5" x 10'3"
Bedroom 2	2.76m x 2.89m	9'0" x 9'6"
Bathroom	2.15m x 2.00m	7'1" x 6'7"

Apartments 184, 186, 188

Living/Dining	3.35m x 4.64m	11'0" x 15'2"
Kitchen	3.13m x 2.99m	10'3" x 9'10"
Bedroom 1	4.09m x 3.12m	13'5" x 10'3"
Bedroom 2	2.76m x 2.89m	9'0" x 9'6"
Bathroom	2.15m x 2.00m	7'1" x 6'7"

Apartments 185, 187, 189

Living/Dining	3.46m x 4.94m	11'4" x 16'2"
Kitchen	3.13m x 2.45m	10'3" x 8'0"
Bedroom 1	3.45m x 3.80m	11'4" x 12'6"
Bathroom	2.15m x 2.00m	7'1" x 6'7"



**CONSUMER
CODE FOR
HOME BUILDERS**
www.consumercode.co.uk



St. Modwen Homes, Two Devon Way, Longbridge, Birmingham, B31 2TS
T: 0121 647 1000 E: sales@stmodwenhomes.co.uk

stmodwenhomes.co.uk