



Kingsbridge Road | Southall | UB2 5RT

£540,000

Hiltons Estates is proud to bring to the market this Spacious 3 bedroom property located in the sought-after Norwood Green, Southall. The ground floor consists of an entrance hallway, 2 reception rooms and kitchen leading to a rear garden. The 70ft rear garden further benefits from side access and large brick garage. The first floor has 2 spacious double bedrooms, a box room and family bathroom. There is off street parking to the front of the property. This home is located within an desired area providing great schools, local amenities, local shops, brilliant transport links, easy access to motorways and Central London. This is an ideal opportunity for families, Investors and Developers

- Semi-Detached 3 Bedroom Property with Scope To Extend (STTP)
- Located Within a Sought After Area of Norwood Green
- Off Street Parking and Large Rear Garden
- Local, Shops, Brilliant Schools, Amenities and Transport Links all Nearby



GROUND FLOOR

1ST FLOOR

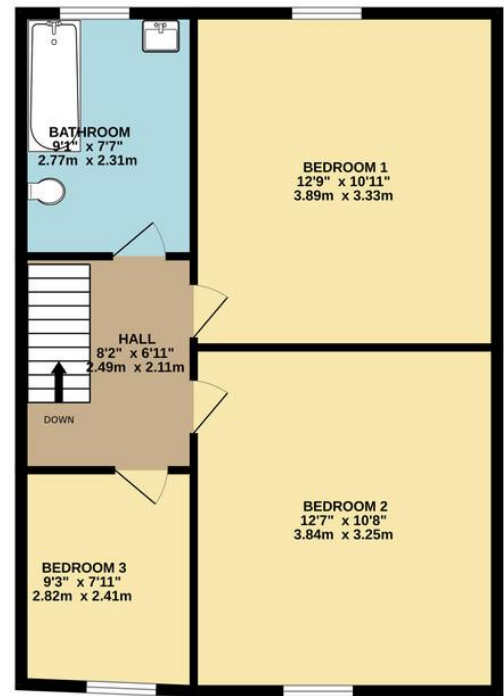
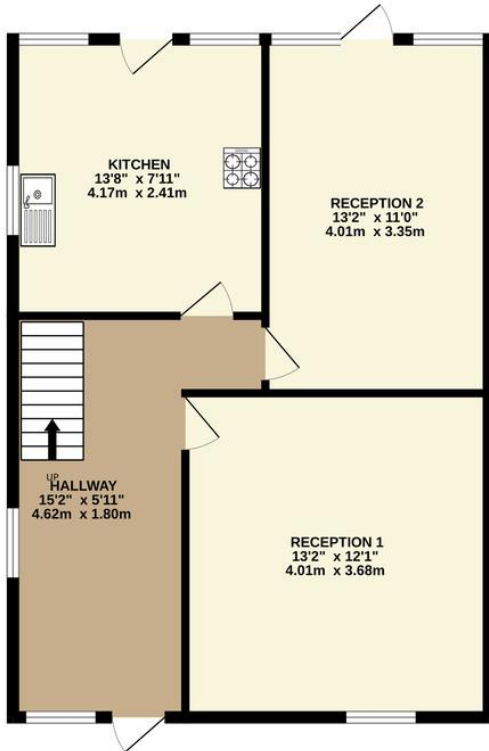

Whilst every attempt has been made to ensure the accuracy of the floorplan contained here, measurements of doors, windows, rooms and any other items are approximate and no responsibility is taken for any error, omission or mis-statement. This plan is for illustrative purposes only and should be used as such by any prospective purchaser. The services, systems and appliances shown have not been tested and no guarantee is given for their availability or performance. See with M...

Contact Details

137 Western Road

Southall

Middlesex

UB2 5HN

www.hiltons-estates.com

Harvin@hiltons-estates.com

02088679555

Energy Efficiency Rating

Score	Energy rating	Current	Potential
92+	A		
81-91	B		88 B
69-80	C		
55-68	D	68 D	
39-54	E		
21-38	F		
1-20	G		

Agents Note: Whilst every care has been taken to prepare these sales particulars, they are for guidance purposes only. All measurements are approximate are for general guidance purposes only and whilst every care has been taken to ensure their accuracy, they should not be relied upon and potential buyers are advised to recheck the measurements