



**LAWRENCE RAND**

Patching Way, Hayes

£465,000





## Patching Way

Hayes, Hayes

A lovely two bedroom, two bathroom semi-detached home, tucked away in a quiet position within this popular modern development. The property has a modern kitchen, good size garden, parking and a garage.

Council Tax band: D

Tenure: Freehold

- Semi-Detached House
- Two Bedrooms
- Master Bedroom En-suite
- Family Bathroom
- Conservatory
- Guest WC
- Good size garden
- Garage









# Patching Way, UB4

Approximate Area = 832 sq ft / 77.3 sq m

Garage = 153 sq ft / 14.2 sq m

Total = 985 sq ft / 91.5 sq m

For identification only - Not to scale

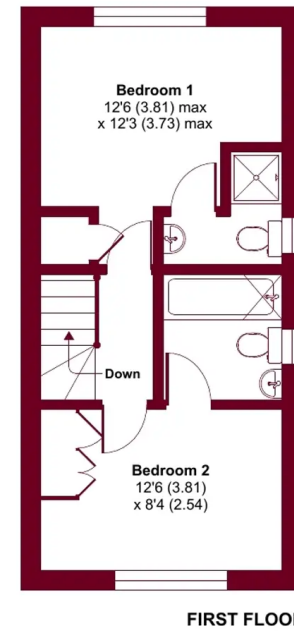
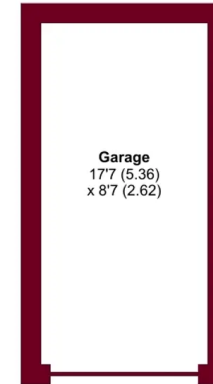
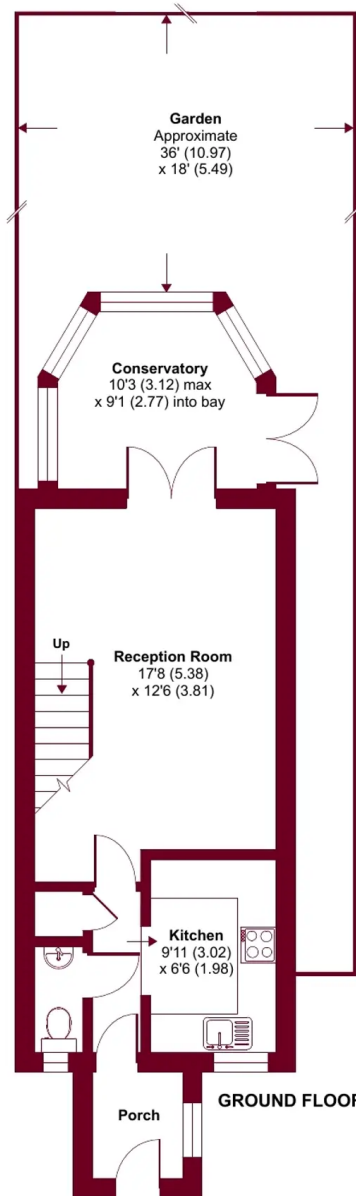





## Lawrence Rand

Lawrence Rand, 106 Victoria Road - HA4 0AL

01895 632211

Info@lawrence-rand.co.uk

[www.lawrence-rand.co.uk](http://www.lawrence-rand.co.uk)



**LAWRENCE RAND**