



17 Gorse Close, Copthorne

In Excess of £400,000

INSPIRE



17 Gorse Close

Copthorne, Crawley

Presenting a chain-free, three-bedroom end-of-terrace home in the charming village of Copthorne. Situated in a quiet cul-de-sac, this well-designed property offers a light-filled entrance porch, spacious living room, and an open-plan kitchen/dining area. With two double bedrooms, a good-sized single bedroom, and rear garden with gated access and garage, this home provides ample space for comfortable family living. Located within walking distance of schools, amenities, and public transport links, this property offers both convenience within a peaceful village setting. Council Tax band: E

Tenure: Freehold

- Property boasts an end-of-terrace position!
- Two good-sized double bedrooms & a well-sized single bedroom!
- Open-Plan Kitchen/Dining area!
- Side gated access to a maintained rear garden, featuring a combination of patio and lawn area!
- Added convenience of an en-bloc garage, secure parking, accessible from the rear garden!
- Close proximity to local schools and amenities, and the overall desirability of a Village setting!
- Quiet Cul-de-Sac location!
- Potential for expansion! (SUBJECT TO PLANNING PERMISSION)





Porch

Hallway

Living Room

23' 4" x 10' 1" (7.10m x 3.07m)

Kitchen / Dining Room

8' 7" x 17' 8" (2.62m x 5.38m)

Kitchen

16' 1" x 7' 5" (4.90m x 2.25m)

Landing

Bedroom 1

13' 0" x 10' 4" (3.97m x 3.14m)

Bedroom 2

10' 2" x 11' 11" (3.09m x 3.62m)

Bedroom 3

8' 8" x 7' 9" (2.63m x 2.36m)

Bathroom



REAR GARDEN

FRONT GARDEN

ON ROAD

1 Parking Space

Unallocated Bay parking and on-road parking!



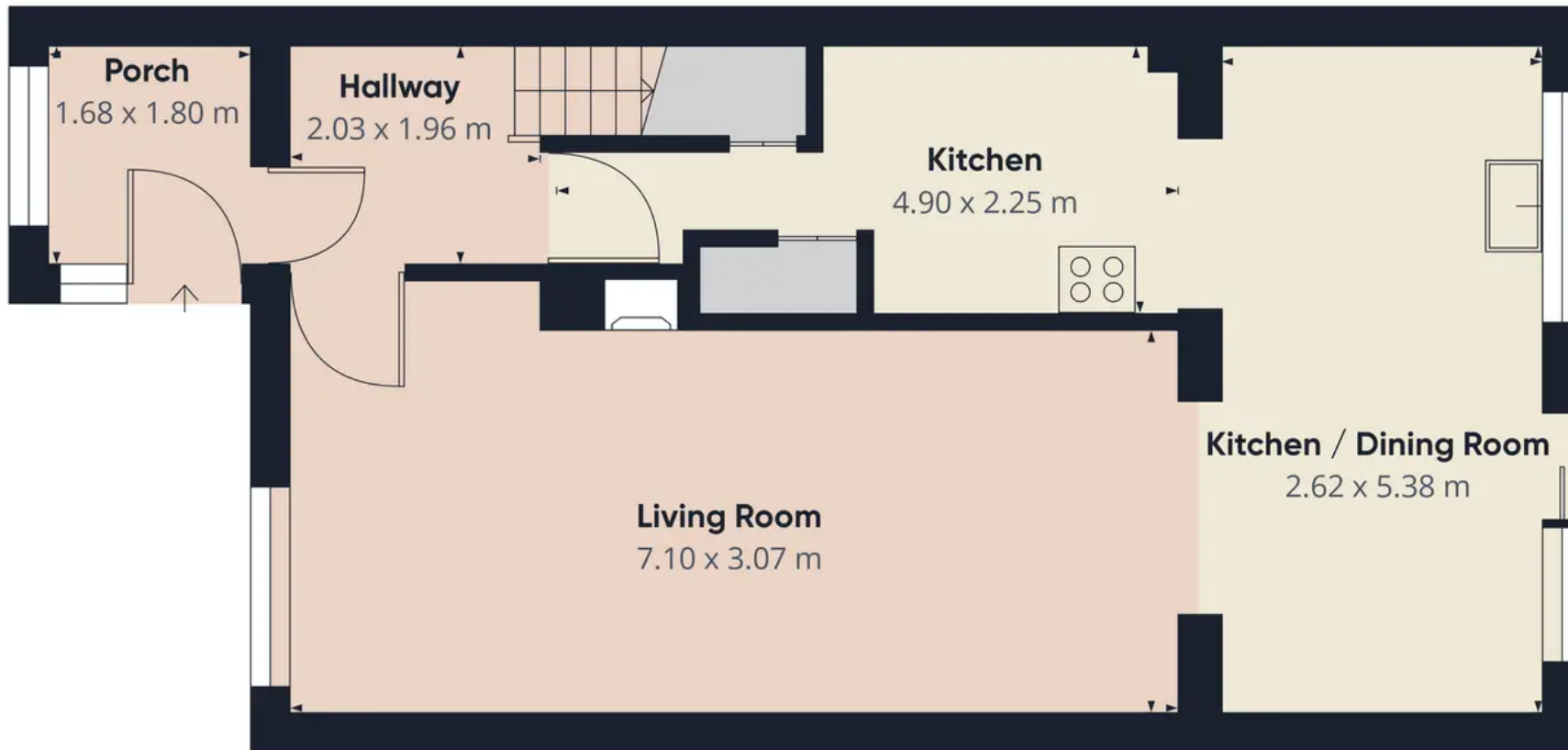

Approximate total area⁽¹⁾
55.85 m²

(1) Excluding balconies and terraces

While every attempt has been made to ensure accuracy, all measurements are approximate, not to scale. This floor plan is for illustrative purposes only.

GIRAFFE360

Floor 0



Inspire

13 Tilgate Parade, Crawley - RH10 5EQ

01293 582335

info@inspirestates.co.uk

<http://www.inspirestates.co.uk>

