



Knighton Heath Road, Bournemouth, Dorset

Knighton Heath Road, Bournemouth, Dorset

Asking Price: £395,000 (Offers In Region Of)

Corbin & Co are delighted to offer for sale this three-bedroom detached bungalow on Kighton Heath Road, BH11 presents an excellent opportunity for those seeking a comfortable and spacious home. With its desirable features including a driveway, over sized garage, secluded rear garden, and the added convenience of no forward chain, this property is sure to attract those looking for a peaceful and convenient living environment. As you approach the property, you are greeted by the ample driveway, providing convenient off-street parking for multiple vehicles. The driveway leads to an impressive over sized garage, offering abundant space for parking, storage, or potential conversion into a workshop or hobby space. Upon entering the bungalow, you are welcomed into a warm and inviting living space. The accommodation comprises three well-proportioned bedrooms, providing ample room for a growing family or the flexibility to convert one into a home office or study. The bedrooms are thoughtfully designed to maximize natural light, creating a pleasant and airy atmosphere. The bungalow boasts a spacious and comfortable living room, perfect for relaxation or entertaining guests. Large windows allow for plenty of natural light to filter through, while providing lovely views of the surrounding neighborhood. Adjacent to the living room, you will find a formal dining room perfect for family meal times or formal dinner parties, this then leads through to a well-appointed kitchen, featuring ample storage space, and a convenient layout for culinary endeavors. One of the standout features of this property is the secluded rear garden. Surrounded by mature trees and hedges, this tranquil space offers privacy and serenity. It presents an ideal setting for outdoor activities, alfresco dining, or simply unwinding amidst nature. Situated in the sought-after location of Kighton Heath Road, BH11, this bungalow benefits from close proximity to local amenities, schools, and transport links. It offers easy access to nearby parks, shops, and leisure facilities, ensuring a convenient and enjoyable lifestyle for residents. To organise your viewing, please call us on 01202 519761.

## VIEWING ARRANGEMENTS

By Appointment With: Corbin & Co  
Tel: 01202 519761

## OPENING HOURS:

Mon - Thur 9- 6 Friday 9 - 5 Sat 9 - 4

## THINKING OF SELLING?

If you are thinking of selling your home or just curious to discover the value of your property, We would be pleased to provide free, no obligation sales and marketing advice. Even if your home is outside the area covered by our local offices we can arrange a Market Appraisal through our national network of estate agents.

## DISCLAIMER

These particulars are intended to give a fair and reliable description of the property but no responsibility for any inaccuracy or error can be accepted and do not constitute an offer or contract. We have not tested any services or appliances (including central heating if fitted) referred to in these particulars and the purchasers are advised to satisfy themselves as to the working order and condition. If a property is unoccupied at any time there may be reconnection charges for any switched off/disconnected or drained services or appliances - All measurements are approximate.

## GROUND FLOOR 899 sq.ft. (83.6 sq.m.) approx.

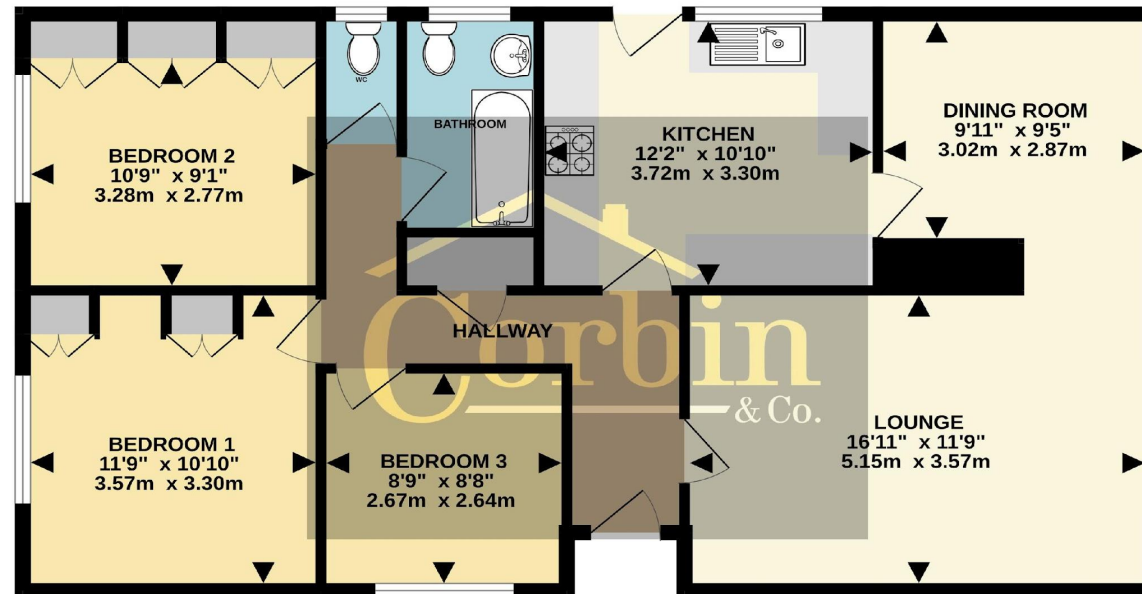

TOTAL FLOOR AREA : 899 sq.ft. (83.6 sq.m.) approx.

Whilst every attempt has been made to ensure the accuracy of the floorplan contained here, measurements of doors, windows, rooms and any other items are approximate and no responsibility is taken for any error, omission or mis-statement. This plan is for illustrative purposes only and should be used as such by any prospective purchaser. The services, systems and appliances shown have not been tested and no guarantee as to their operability or efficiency can be given.  
Made with Metropix ©2023



