

£1,200 pcm

School Lane, Manea, Cambs PE15 0JN



To arrange a viewing call us now on 01354 694900

Deposit £1,384

Available for immediate occupation, this well proportioned three bedroom detached bungalow has been beautifully refurbished throughout, and has the benefit of a double garage plus ample off road parking. The accommodation comprises living room with feature fireplace, kitchen/breakfast room, dining room, three double bedrooms with one having an en-suite plus there is the family bathroom. There is also a good size garden with enough space for both relaxation and play.

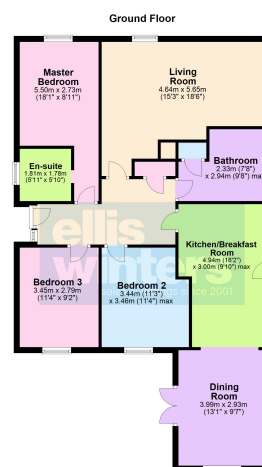

£1,200 pcm

School Lane, Manea, Cambs PE15 0JN



LIVING ROOM
5.65m (18'6") x 4.64m (15'3")
Window to front, feature fireplace.

KITCHEN/BREAKFAST ROOM
4.94m (16'2") x 3.00m (9'10") max.
Fitted with a matching range of wall and base units complete with freestanding cooker, plumbing for washing machine and dishwasher, space for fridge/freezer, window to side and door out to side, open plan to dining room.



DINING ROOM
3.99m (13'1") x 2.93m (9'7")
Window to rear, double doors leading out to rear garden.

MASTER BEDROOM
5.50m (18'1") x 2.73m (8'11")
Window to front.



EN-SUITE
1.81m (5'11") x 1.78m (5'10")
Fitted with a corner shower cubicle, low level WC and hand wash basin set within vanity unit. Window to side.

BEDROOM 2
3.46m (11'4") max. x 3.44m (11'3")
Window to rear.

BEDROOM 3
3.45m (11'4") x 2.79m (9'2")
Window to rear.



BATHROOM
2.94m (9'8") max. x 2.33m (7'8")
Fitted with a 'p' shaped bath with mains shower over, low level WC and hand wash basin. Boiler cupboard and window to side.

OUTSIDE
The front of the property has a large area of hardstanding for off road parking which also leads to the double garage which has standard up and over door, power and light. There is also an area of lawn.



To the rear the established and mature garden is laid mainly to lawn with a variety of trees, raised beds and patio area.

Ellis Winters & Co 20 Market Hill, Chatteris, Cambridgeshire, PE16 6BA
Tel: 01354 694900 Email: info@elliswinters.co.uk www.elliswinters.co.uk