



Flat 28, Cornerstone House, 120 London Road
Portsmouth

Offers in Region of £175,000

 chinneckshaw



Flat 28

Cornerstone House, Portsmouth

What a great investment or first time purchase! We are delighted to offer this modern one bedroom house located in the heart of Portsmouth. New to the market, it can be found close to local shops and facilities but yet also has easy access to both the M275 and M27.

From the front door you'll find a welcoming open plan design which incorporates the Lounge, Dining Area and Kitchen. This is a good size space and gives you lots of furniture design options to make it your own! At the far end of this space you'll find stairs to the first floor with a cloakroom just off that.

Upstairs you'll see a long landing area with two double bedrooms, both having neutral decor so we think are ready to move straight into. Next comes the bathroom. A modern fitted suite which has been well executed to give it that contemporary feel.

All in all we think this is a lovely house in an excellent location and the perfect starter home to suit a FTB or an investor wanting a ready to rent home.

Council Tax Band A

Tenure: Freehold





Ground Floor

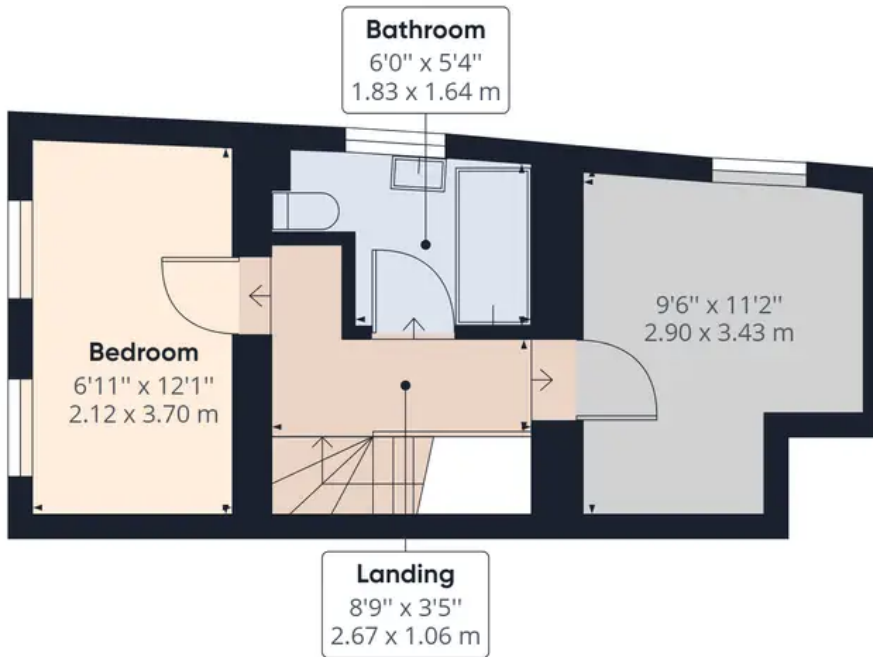

Floor 1

Approximate total area⁽¹⁾

563.24 ft²

52.33 m²

(1) Excluding balconies and terraces

While every attempt has been made to ensure accuracy, all measurements are approximate, not to scale. This floor plan is for illustrative purposes only.

GIRAFFE 360

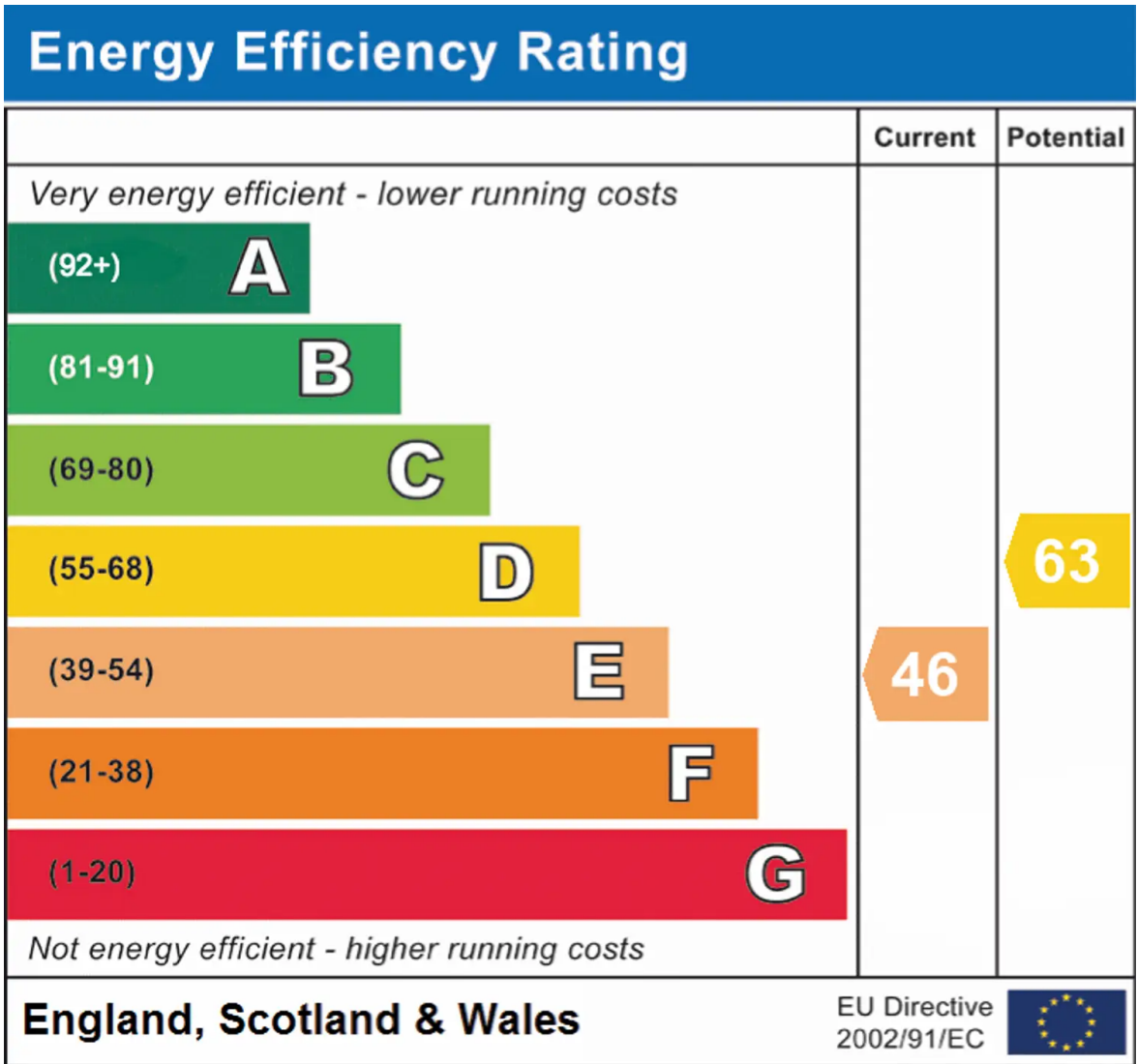

Chinneck Shaw

Bridge House, Milton Road, Portsmouth – PO3 6AN

023 9282 6731

hello@chinneckshaw.co.uk

www.chinneckshaw.co.uk/

Chinneck Shaw, Bridge House, Milton Road, PO3 6AN Consumer Protection from Unfair Trading Regulations 2008: These details are for guidance only and complete accuracy cannot be guaranteed. If there is any point which is of particular importance, verification should be obtained. The do not constitute a contract or part of a contract. All measurements are approximate. No guarantee can be given with regard to planning permissions or fitness for purpose. No apparatus, equipment, fixture or fitting has been tested. Items shown in the photographs are NOT necessarily included. Interested Parties are advised to check availability and make an appointment to view before travelling to see a property.