 3

Bedrooms

 1

Bathroom



We are pleased to present to the market this 3-bedroom detached house, located just off the high street in Harrow Wealdstone. There is great potential to extend/develop this property both to the rear and into the loft, subject to the usual planning permissions. The current layout consists of a lounge and kitchen on the ground floor, the first floor houses all 3 bedrooms along with a bathroom. The property is to be sold with NO CHAIN! Other benefits include a 100ft rear garden, off street parking and a garage. Shop, transport links, parks, schools are all conveniently located. Call to arrange your viewing!

GROUND FLOOR
495 sq.ft. (45.9 sq.m.) approx.

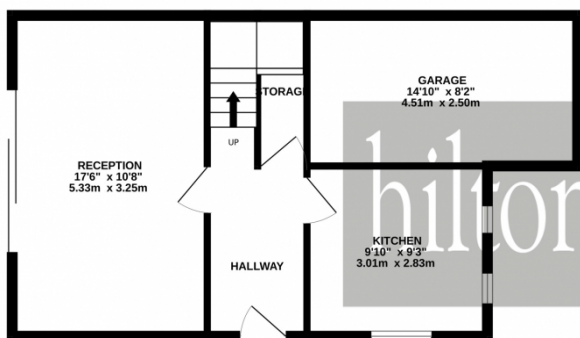

1ST FLOOR
454 sq.ft. (42.2 sq.m.) approx.

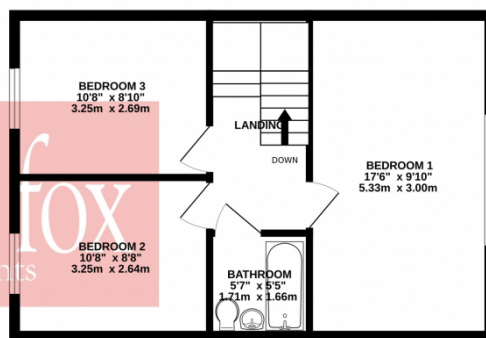

TOTAL FLOOR AREA : 949 sq.ft. (88.1 sq.m.) approx.

Whilst every attempt has been made to ensure the accuracy of the floorplan contained here, measurements of doors, windows, rooms and any other items are approximate and no responsibility is taken for any error, omission or mis-statement. This plan is for illustrative purposes only and should be used as such by any prospective purchaser. The services, systems and appliances shown have not been tested and no guarantee as to their operability or efficiency can be given.
Made with Metropix ©2023

Energy Efficiency Rating

	Current	Potential
Very energy efficient - lower running costs		
(92+) A		
(81-91) B		88
(69-80) C		
(55-68) D		
(39-54) E		
(21-38) F	29	
(1-20) G		
Not energy efficient - higher running costs		
England, Scotland & Wales		EU Directive 2002/91/EC 

Address: Spencer Road, Harrow, Middlesex HA3





Restaurant Miorița

Esso

Diyar's Barbers Shop (Homegrown)

Growing Stars Nursery

Bhagwan Mahavir Digamber Jain Temple

St Josephs Catholic Primary School

Whitefriars School

Sri Lankan Muslim Cultural Centre...

Halfords Autocentre Harrow

Asda Wealdstone Supermarket

London Supplements

Heriots Patisserie

Wealdstone Cemetery

Byron Park

Harrow Leisure Centre

Harrow School