



Briarwood Road, Epsom

Epsom

In Excess of £750,000

# Briarwood Road

## Epsom

- Four/Five bedrooms
- Extended
- Semi-detached
- Downstairs shower room and with W.C
- Modern Kitchen
- Off-street parking for up to 4 cars
- Conservatory
- South-westerly facing garden
- Modern bathroom with separate shower
- Garage

Kaybridge Residential are proud to present to the market this rarely available, beautifully presented four/five bedroom, extended semi-detached family home, ideally located for good schools, amenities and mainline station.

Upon entering you are greeted with a welcoming hallway which leads to the bright and spacious bay-fronted living room with feature fireplace, good size dining room with views of the south-westerly facing landscaped garden, study/bedroom, shower room with W.C and conservatory.

To the first floor there are four double bedrooms and a modern family bathroom with separate shower.

Further benefits include ample off-street parking, a garage and potential to extend (STPP).

To fully appreciate this superb home, a viewing is highly recommended.





## Briarwood Road

Epsom

Kaybridge Residential are proud to present to the market this rarely available, beautifully presented four/five bedroom, extended semi-detached family home, ideally located for good schools, amenities and mainline station.

Council Tax band: F

Tenure: Freehold





# Briarwood Road, Epsom, KT17

Approximate Area = 1658 sq ft / 154 sq m

Garage = 194 sq ft / 18 sq m

Total = 1852 sq ft / 172 sq m

For identification only - Not to scale

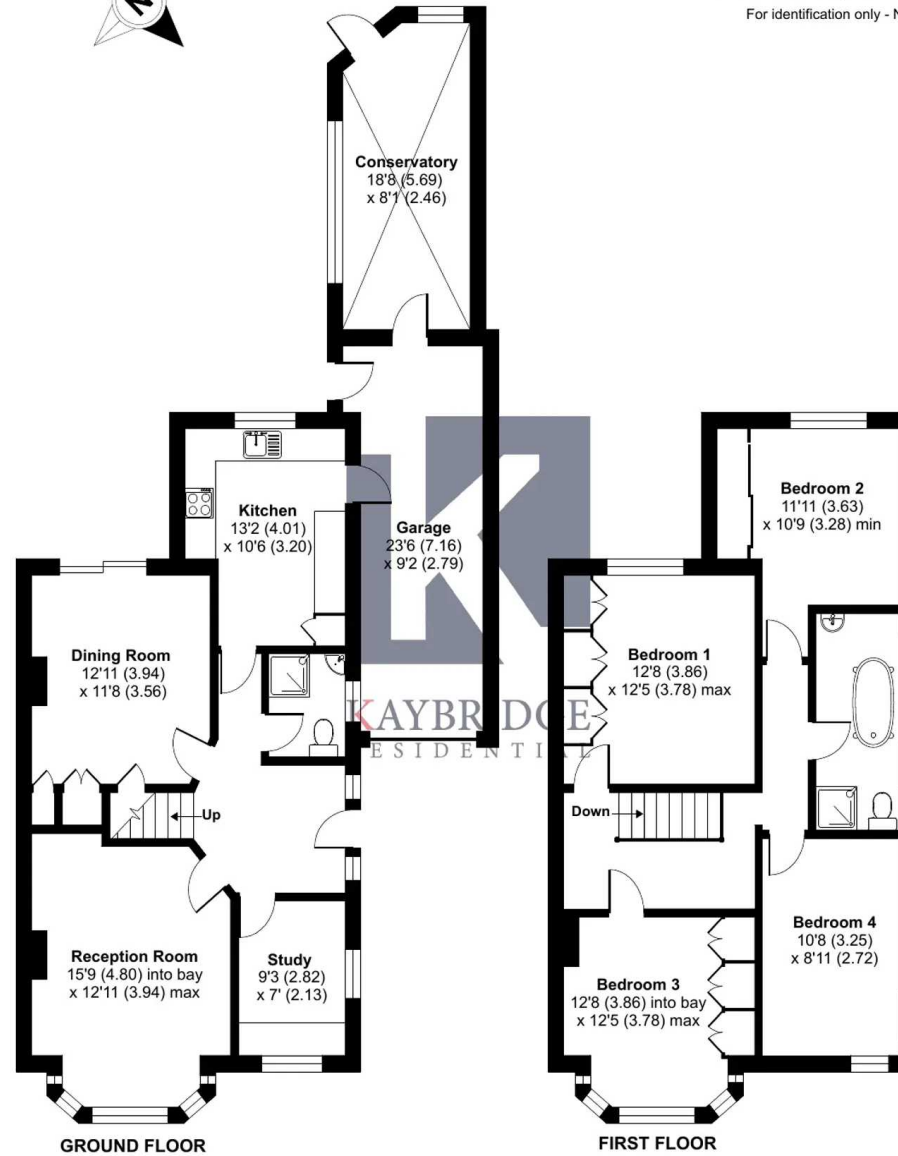



## Kaybridge Residential Epsom

Kaybridge Residential Estate Agents, 23 Stoneleigh Broadway - KT17 2JE

02080040474 • [info@kbridge.co.uk](mailto:info@kbridge.co.uk) • [www.kaybridgeresidential.co.uk/](http://www.kaybridgeresidential.co.uk/)