

# HARDWICK PLACE

BUCKINGHAM ROAD, HARDWICK, HP22 4EF

Guide Price: £2,500,000



Nestled in the picturesque countryside of Buckinghamshire, Hardwick Place stands proudly as a remarkable Grade II listed house, steeped in history and dating back to the 16th century.

FINE & COUNTRY

This splendid eight bedroom home offers an enchanting glimpse into the grandeur of English country living.

FINE & COUNTRY



Upon entering this magnificent residence, you will be greeted by an air of elegance and timeless charm. The interior boasts a generous layout, providing an abundance of living space. The drawing room is majestic with ornate features and ideal for entertaining. The dining room beckons guests to savour culinary delights while relishing in the historic ambiance. An inviting garden room bathed in natural light offers a tranquil retreat to unwind and immerse oneself in the beauty of the surrounding landscape. Completing the ensemble is a sophisticated study, perfect for contemplation or as a private library. Beyond the threshold, the allure of the estate extends outdoors with approximately 3.5 acres of enchanting grounds and manicured lawns.

In addition to the main residence, there is a separate two-bedroom cottage ideal for accommodating guests or staff and outbuildings include three workshops, two sheds and a double garage.

Hardwick Place presents an opportunity to acquire a residence of significant historical importance and architectural beauty.

## AT A GLANCE

Eight Bedrooms  
Five Reception Rooms  
3.5 Acres

## ACCOMMODATION

Drawing Room  
Dining Room  
Study  
Playroom  
Garden Room  
Kitchen Breakfast Room  
Utility Room  
Principle Bedroom  
Dressing Room  
Shower WC  
Bedroom 2  
En suite Bathroom WC  
Bedroom 3  
Bedroom 4  
Bedroom 5  
Bedroom 6  
Bedroom 7  
Bedroom 8  
Family Bathroom WC  
Two Further WC's  
Double Garage  
Cellar  
Three Workshops  
Two Sheds  
Greenhouse  
Two Bedroom Cottage

GUIDE PRICE

£2,500,000











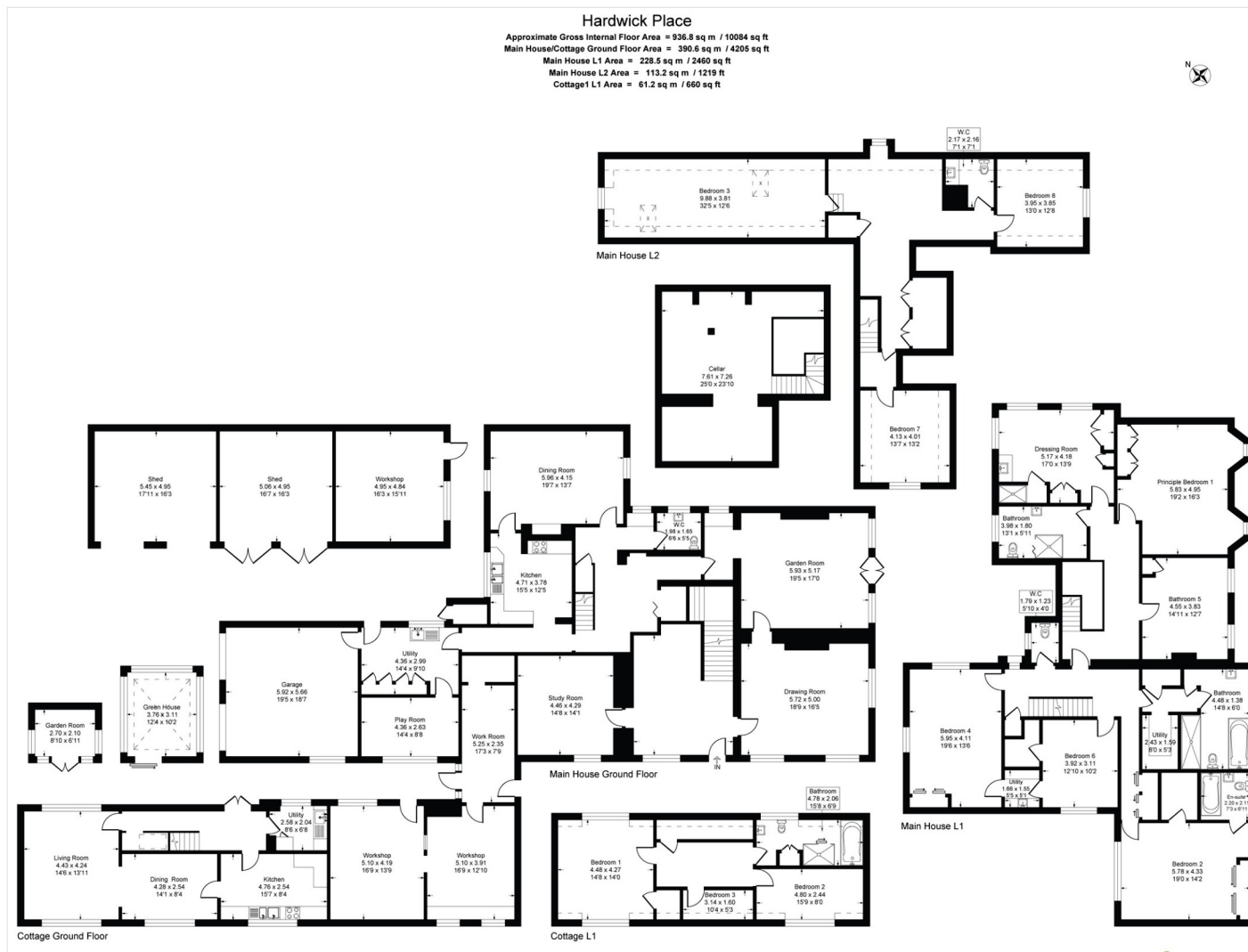

## ADDITIONAL INFORMATION

Mains water, electricity and sewage

Heating: Oil fired central heating to radiators

Postcode: HP22 4EF

Council Tax Band: G

Local Authority: Buckinghamshire Council

Energy rating: Exempt

## LOCATION

Hardwick.

A small village built on a low hill in the Vale of Aylesbury, set just off the A413 with the county town just three miles to the south and Whitchurch just one mile to the north which has a primary school. Hardwick has its own pre school and there is a church of Anglo Saxon origin and the remains of Cavaliers and Roundheads who fought in the battle of Aylesbury in 1642 are buried in the graveyard. The village has some 16th and 17th Century thatched cottages together with a fine timber framed Manor Farm House and some modern homes. This popular hamlet is ideally sited for quick access to Aylesbury with its mainline station and shopping facilities and Winslow with its East West railway line which is approximately ten minutes drive. There is also easy access to Leighton Buzzard & Milton Keynes. There are a number of footpaths and bridleways across the open and undulating surrounding countryside.

**FINE & COUNTRY**

Fine & Country • Vale and Chilterns  
 14 High Street • Wendover  
 Buckinghamshire • HP22 6EA

01296 625919

wendover@fineandcountry.com