



MILE



Nightingale Road, London NW10

£1,675 pcm

Mile are pleased to bring to market this one bedroom garden apartment to let on this residential road in NW10. Offered in good condition, the property comprises of bedroom with bay windows, a great size open plan reception room leading to the bright fully fitted kitchen. There is access from the kitchen onto a superb low maintenance private garden. This lovely home benefits from wood flooring and double glazed windows throughout, high ceilings and an abundance of natural light and storage space. Offered on a unfurnished basis, the property is available immediately. Nightingale Road is ideally positioned close to all the local amenities of Harlesden and Willesden Junction and less than 15 minutes walk from the future Old Oak Common HS2 / Crossrail interchange. Maple Walk and Leopold schools with Roundwood Park open space are only a short distance away from the property. The nearest stations is Willesden Junction (Bakerloo line / Overground - zone 2).

- Ground floor apartment
- Private Garden
- One bedroom
- Unfurnished
- Available now
- Close to transport links
- Coffee shops in close proximity
- Great location
- Good condition
- Close to amenities

Nightingale Road, NW10 4RG

Approx. Gross Internal Area = 40.6 sq m / 437 sq ft

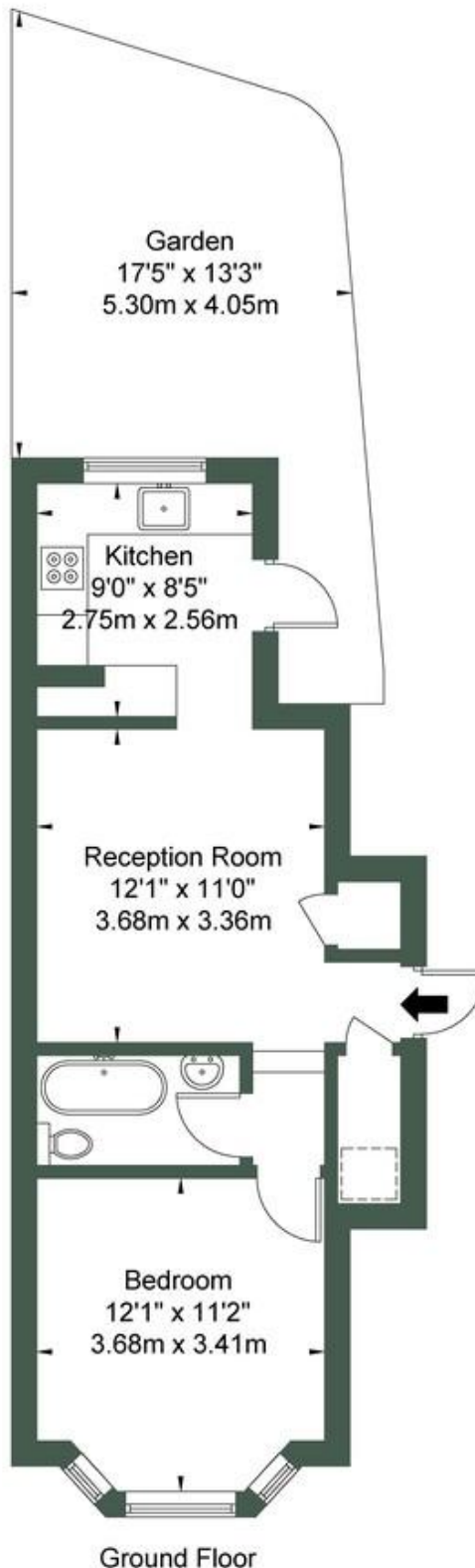

Ref

Copyright

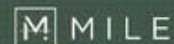

The Floor plan is not to scale and measurements and areas shown are approximate and therefore should be used for illustrative purposes only. The plan has been prepared in accordance with the RICS code of Measuring Practice and whilst we have confidence in the information produced it must not be relied on. If there is any aspect of particular importance, you should

MONEY LAUNDERING REGULATIONS 2003: Intending purchasers will be asked to produce identification documentation at a later stage and we would ask for your co-operation in order that there will be no delay in agreeing the sale.

General: While we endeavour to make our sales particulars fair, accurate and reliable, they are only a general guide to the property and, accordingly, if there is any point which is of particular importance to you, please contact the office and we will be pleased to check the position for you, especially if you are contemplating travelling some distance to view the property.

Measurements: These approximate room sizes are only intended as general guidance. You must verify the dimensions carefully before ordering carpets or any built-in furniture.

Services: Please note we have not tested the services or any of the equipment or appliances in this property, accordingly we strongly advise prospective buyers to commission their own survey or service reports before finalising their offer to purchase.