



Property Summary

Phillips George are delighted to offer for sale this four bedroom three storey mid town house situated in the popular borders of Spinney Hill and Highfields. The accommodation comprises entrance to dining room, lounge, extended kitchen, ground floor wet room, landing to two bedrooms and bathroom, further landing located off bedroom two leads to bedroom three & four, landscaped rear yard. Internal inspection comes recommended.



GROUND FLOOR
429 sq.ft. (39.4 sq.m.) approx.

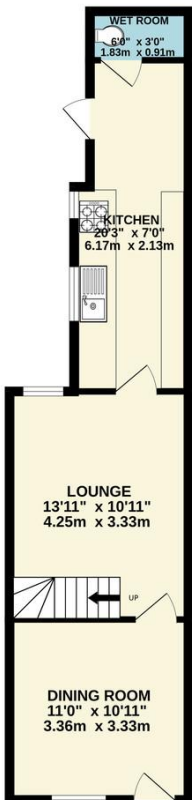

1ST FLOOR
339 sq.ft. (31.5 sq.m.) approx.

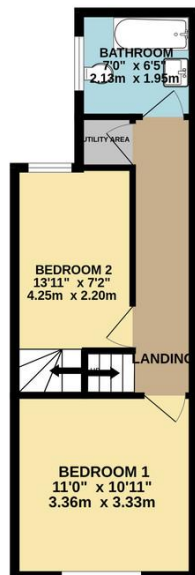

2ND FLOOR
229 sq.ft. (21.3 sq.m.) approx.

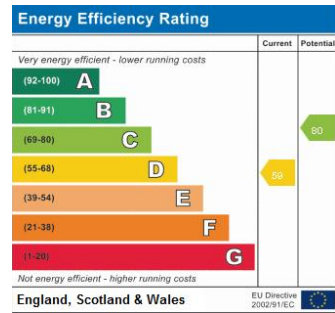
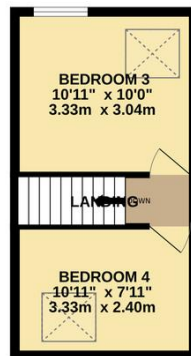

- Mid Town House
- Four Bedrooms
- Three Storey
- Highfields / Spinney Hill
- Ground Floor Wet Room
- Dorma Conversion
- Rear Yard
- Extended Property

phillips george | sales & lettings

Agents Note: Whilst every care has been taken to prepare these sales particulars, they are for guidance purposes only. All measurements are approximate and for general guidance purposes only and whilst every care has been taken to ensure their accuracy, they should not be relied upon and potential buyers are advised to recheck the measurements

46 Long Street, Wigston, Leicestershire, LE18 2AH

info@phillipsgeorge.co.uk
0116 216 8178

