



Thorndon Gardens, Epsom

Epsom

£825,000

# Thorndon Gardens

## Epsom

- Detached family home
- Five/Six bedrooms
- Off-street parking
- Garage
- Flexible accommodation
- Through-lounge
- Close to mainline station and schools

Situated in a highly sought after road in Stoneleigh, within easy walking distance of shops, local schools and Auriol Park is this stunning, five/six bedroom detached home with huge potential STPP. Offering a spacious and bright extended kitchen/living/dining room, two bathrooms, study/guest accommodation and a South Easterly facing garden, this property must be seen to be fully appreciated. The property comprises an entrance porch with doors to the entrance hall with access to understairs storage, front aspect study/guest room with downstairs WC. Front aspect living room with bay window, feature fireplace with double doors opens to kitchen/dining/living space, which benefits from sliding door onto the garden. The kitchen comprises a range of modern eye and base level units, with access to the utility room. On the first floor there are five bedrooms, four doubles with built-in storage and a single, all served by the two modern family bathroom with both bath and separate shower cubicle. Outside to the rear there is a driveway with off street parking with access to a rear garden and double garage, The property has a plenty of potential STPP to create a Annex with a direct access from drive way at the rear.





## Thorndon Gardens

Epsom

Situated in a highly sought after road in Stoneleigh, within easy walking distance of shops, local schools and Auriol Park is this stunning, five/six bedroom detached home with huge potential STPP.

Council Tax band: F





# Thorndon Gardens, Epsom, KT19

Approximate Area = 1952 sq ft / 181.3 sq m

Garage = 446 sq ft / 41.4 sq m

Total = 2398 sq ft / 222.7 sq m

For identification only - Not to scale

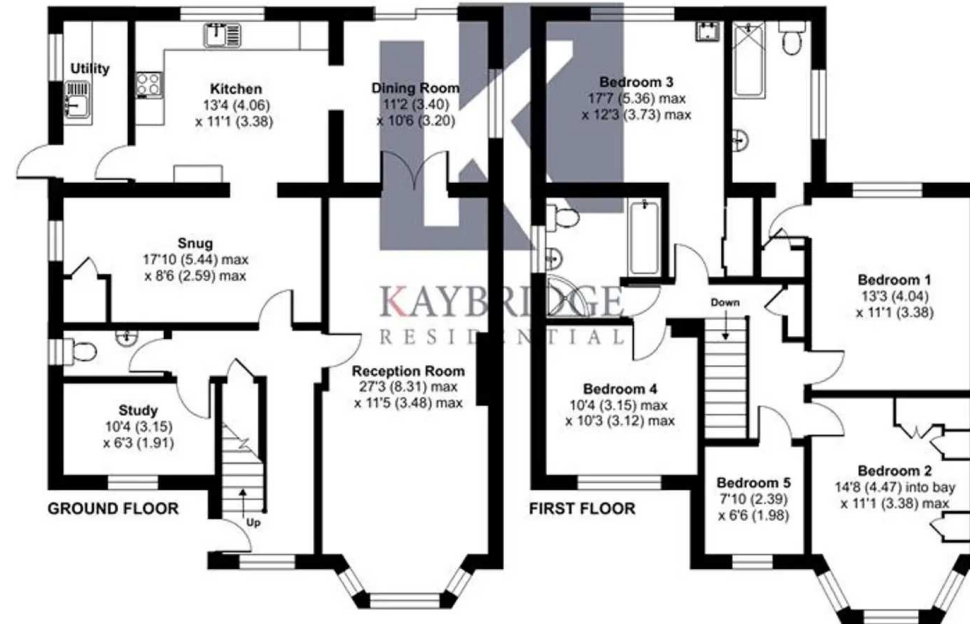
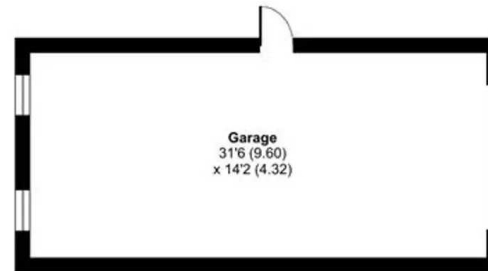



## Kaybridge Residential Epsom

Kaybridge Residential Estate Agents, 23 Stoneleigh Broadway - KT17 2JE

02080040474 • [info@kbridge.co.uk](mailto:info@kbridge.co.uk) • [www.kaybridgeresidential.co.uk/](http://www.kaybridgeresidential.co.uk/)