



2 The Cross Keys, Church Street, Pateley Bridge, HG3 5LB

£215,000

2 The Cross Keys, Church Street, Pateley Bridge, HG3 5LB

A charming stone-built four-storey terraced house in a mews-style setting in the heart of this picturesque town, being close to the High Street with its excellent range of shopping facilities and within easy reach of all other amenities.

Pateley Bridge is surrounded by glorious Nidderdale countryside and is within reasonable travelling distance of the surrounding major towns and cities, with the spa town of Harrogate being approximately 12 miles away.





Sure to appeal to a range of buyers including professional couples, first-time buyers, the buy-to let-market or as a holiday cottage. An early internal viewing is strongly recommended to appreciate this property.

This superb home offers versatile and characterful accommodation arranged over four levels and, in brief, comprises -

GROUND FLOOR
ENTRANCE HALL

BREAKFAST KITCHEN

With fitted units. Bay window to the front.

LOWER GROUND FLOOR
STUDY / 2ND RECEPTION ROOM

With exposed beams.

FIRST FLOOR
SITTING ROOM

Bay window.

BATHROOM

Three-piece suite.

SECOND FLOOR

Two bedrooms with aspects to the front.

OUTSIDE

Small sitting area.

Tenure - Freehold

Council Tax Band - C



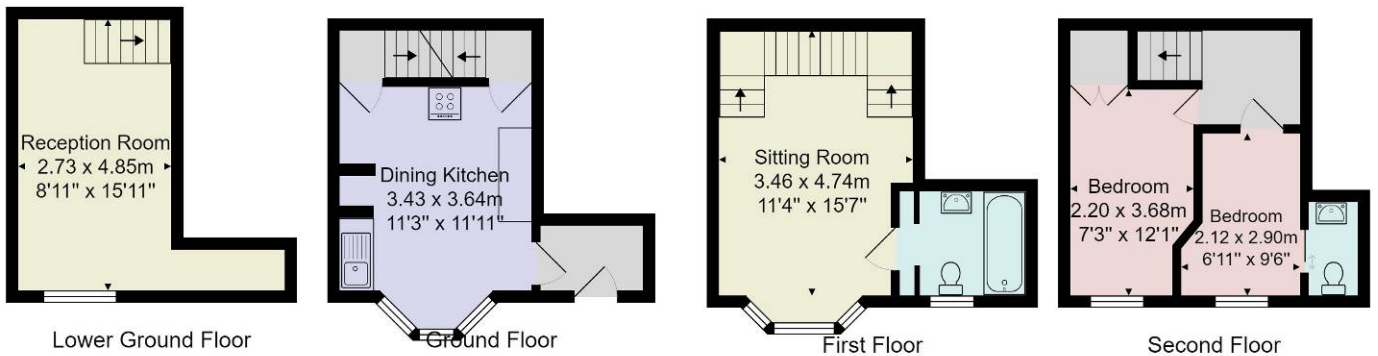

Total Area: 75.9 m² ... 817 ft²

All measurements are approximate and for display purposes only.
 No liability is accepted by either the agency or Box Property Solutions Ltd as to the exact measurements of the rooms.
 Box Property Solutions Ltd retains the copyright on this plan and allows agents to use it with agreed permission.

Verity Frearson

26 Albert Street, Harrogate,
 North Yorkshire, HG1 1JT

For all enquiries contact us on:

01423 562531

sales@verityfrearson.co.uk

