



MILE



## Chamberlayne Road, London £2,700 pcm

Mile are delighted to offer this beautiful, newly renovated two bedroom apartment with a stunning roof terrace in the heart of Kensal Rise!

This newly renovated stunning apartment benefits from two double bedrooms, a lovely open plan kitchen living area and offers almost 800 sq ft of living space!

If this wasn't enough, there is a gorgeous roof terrace which is ideal for entertaining guests and an abundance of natural light throughout the property, viewing is recommended and potential suitors will not be disappointed!

- Roof Terrace
- Ideal Location
- Two double bedrooms
- Bright and airy
- Abundance of Natural Light
- Close to shops and local amenities
- Great transport links
- Newly Renovated
- Stunning apartment
- Open Plan Kitchen Living

# Chamberlayne Road NW10 3ND

Approx Gross Internal Area = 72.4 sq m / 779 sq ft

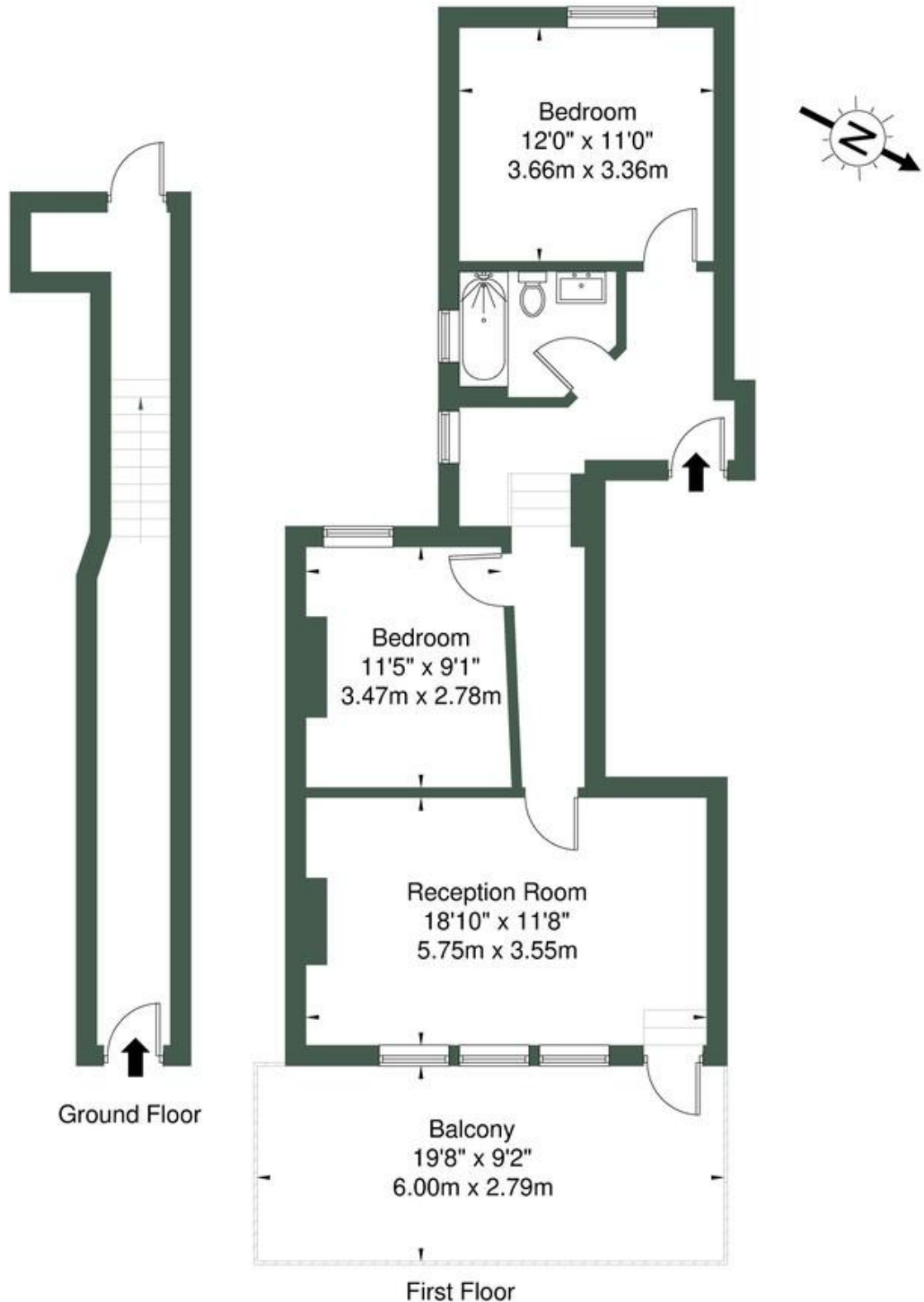

Ref

Copyright



The Floor plan is not to scale and measurements and areas shown are approximate and therefore should be used for illustrative purposes only. The plan has been prepared in accordance with the RICS code of Measuring Practice and whilst we have confidence in the information produced it must not be relied on. If there is any aspect of particular importance, you should

**MONEY LAUNDERING REGULATIONS 2003:** Intending purchasers will be asked to produce identification documentation at a later stage and we would ask for your co-operation in order that there will be no delay in agreeing the sale.

**General:** While we endeavour to make our sales particulars fair, accurate and reliable, they are only a general guide to the property and, accordingly, if there is any point which is of particular importance to you, please contact the office and we will be pleased to check the position for you, especially if you are contemplating travelling some distance to view the property.

**Measurements:** These approximate room sizes are only intended as general guidance. You must verify the dimensions carefully before ordering carpets or any built-in furniture.

**Services:** Please note we have not tested the services or any of the equipment or appliances in this property, accordingly we strongly advise prospective buyers to commission their own survey or service reports before finalising their offer to purchase.