

1  
Bedroom



1  
Bathroom



Within a short walk of Perivale Station and offering fantastic views from a balcony is this One Double Bedroom top floor Flat. The property is offered with no further chain and in good condition throughout and consists of a large double bedroom, family kitchen, family bathroom and a large lounge/diner. Externally you will find the property is ideally placed giving you easy access to local shops and transport links. Call now to book your viewing.

THIRD FLOOR  
454 sq.ft. (42.2 sq.m.) approx.

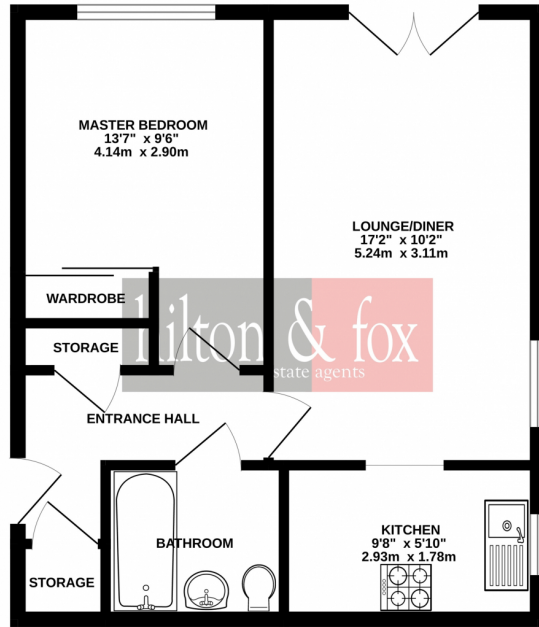

TOTAL FLOOR AREA: 454 sq.ft. (42.2 sq.m.) approx.

Whilst every attempt has been made to ensure the accuracy of the floorplan contained here, measurements of doors, windows, rooms and any other items are approximate and no responsibility is taken for any error, omission or mis-statement. This plan is for illustrative purposes only and should be used as such by any prospective purchaser. The services, systems and appliances shown have not been tested and no guarantee as to their operability or efficiency can be given.  
Made with Metropix 0022

Energy Efficiency Rating		
	Current	Potential
Very energy efficient - lower running costs		
(92+) <b>A</b>		
(81-91) <b>B</b>		
(69-80) <b>C</b>	<b>77</b>	<b>77</b>
(55-68) <b>D</b>		
(39-54) <b>E</b>		
(21-38) <b>F</b>		
(1-20) <b>G</b>		
Not energy efficient - higher running costs		
<b>England, Scotland &amp; Wales</b>		EU Directive 2002/91/EC 

Address: Periwood Crescent, Perivale, Middlesex UB6





Perivale Brewery

BMB Plumbing & Heating Services

Horsenden

Green Park Way

Royal Mail - Greenford Mail Centre

Mieszko Polski Supermarket

Segro Park, Perivale

Metropolitan Police Perivale Car Pound

Perivale Wood

Kluseczka

Selborne Primary School

Deluxe

LloydsDirect

Perivale

Lamar Cafe & Lounge

Ramzi Autos

Door To Door Pizza

Horsenden Ln

Jubilee Rd

Bilton Rd

Empire Rd

Lynmouth Rd

Jordan Rd

Fraser Rd

Tavistock Ave

Woodhouse Ave

Tees Ave

Thames Ave

Medway Dr

Hodder Dr

Barmouth Ave

Colwyn Ave