



2 Bedroom Apartment **£185,000**
7 , The Gallery, Leicester Street, Swindon, SN1 2LR

mcfarlane
property.com

2 Bedroom Apartment Swindon Town Centre

- No Chain
 - Two Double Bedrooms
 - En suite
-

****NO CHAIN**** An ideal First Time Buyer/Investment purchase. This first floor TWO DOUBLE bedroom apartment is immaculate throughout and has a light and airy feel with the bonus of a BALCONY via full height sliding doors from the lounge area. The apartment benefits from open plan living with a modern kitchen offering lots of cupboard space plus integrated fridge/freezer, washing machine and dishwasher. The spacious master bedroom benefits from an EN SUITE and there is a modern bathroom with full bath and shower over. Externally there is a communal well tended garden and SECURE ALLOCATED PARKING. Within easy walking distance of the train station, you can be in London in 50 mins, bus station and the restaurant/cinema complex at Regent Circus.

Lease Information

Remaining Lease - 982 yrs
Management Fee - £2,000p.a.
Ground Rent - £100p.a.





Ground Floor

Approx. 62.5 sq. metres (673.0 sq. feet)

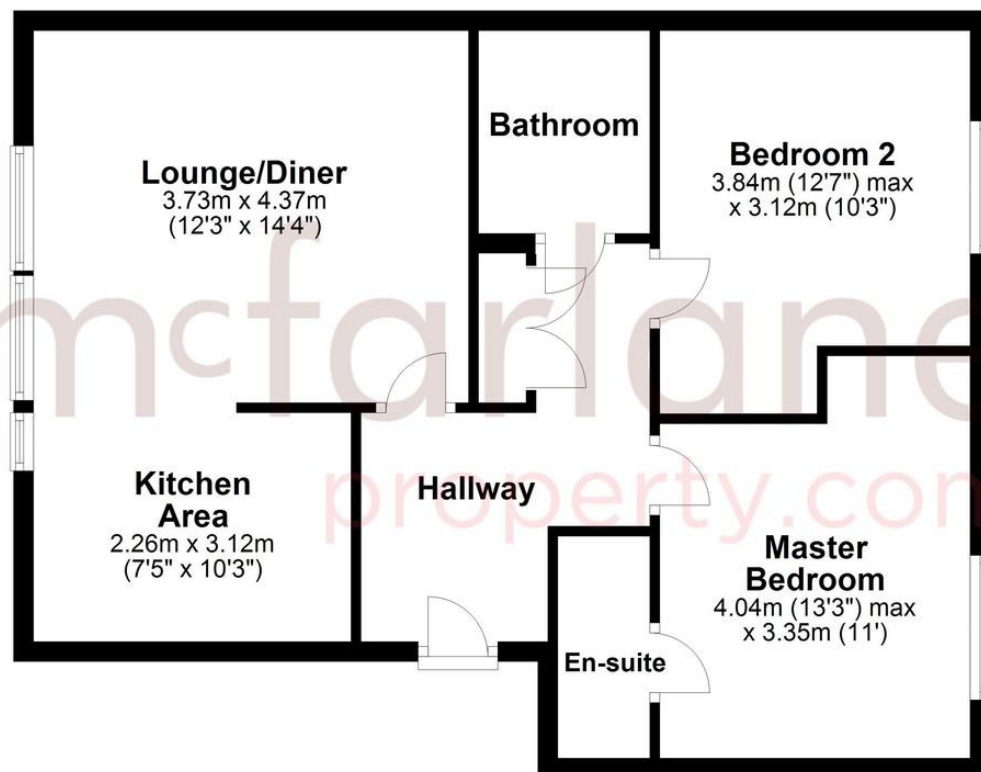

Total area: approx. 62.5 sq. metres (673.0 sq. feet)

We 
where you
LIVE

Our team are friendly, experienced and are all local. They know it better than they do their own living rooms and can help you find what you're looking for because **we love where we live.**

We would be delighted to show you around this property.

**Because every home
needs a personal touch.**

**If you would like to view this
property then please get in touch.**

📞 01793 296880

✉ oldtown@mcfarlaneproperty.com

mcfarlaneproperty.com

mcfarlane
property.com

Cricklade.

102 High Street
Cricklade SN6 6AA

📞 01793 751044

Marlborough.

106 High Street
Marlborough SN8 1LT

📞 01672 514380

Old Town.

28-30 Wood Street
Swindon SN1 4AB

📞 01793 296880

Swindon.

The Village Centre,
Redhouse SN25 2FW

📞 01793 296600

Agents Note: Whilst every care has been taken to prepare these sales particulars, they are for guidance purposes only. All measurements are approximate are for general guidance purposes only and whilst every care has been taken to ensure their accuracy, they should not be relied upon and potential buyers are advised to recheck the measurements