



2 Bedrooms Mid Terraced House £220,000

8 Cheney Manor Road, Swindon, SN2 2NS

mcfarlane  
property.com

2 Bedrooms Mid Terraced House  
Swindon,

- 
- TWO DOUBLE BEDROOMS
  - 24FT LOUNGE
  - FITTED KITCHEN
  - EXTENDED
- 
- GARAGE AND PARKING
- 

\*\*\*\*COMING SOON\*\*\*\*



Coming soon is this extended terrace house with 24ft sitting room, fitted kitchen, two double bedrooms and upstairs bathroom together with garage and parking.



We   
where you  
**LIVE**

**Ground Floor**  
Approx. 47.3 sq. metres (509.1 sq. feet)

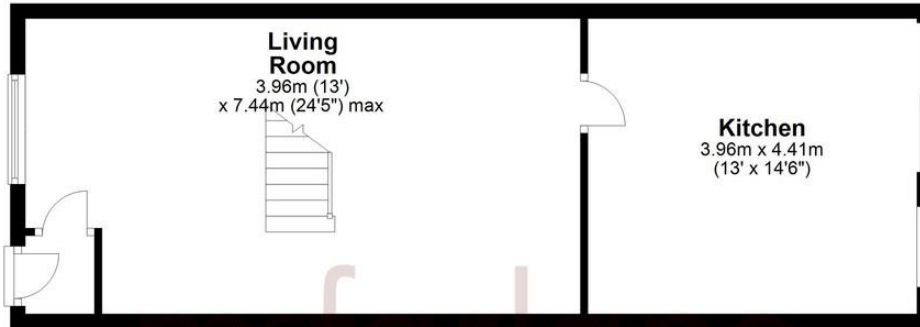

**First Floor**  
Approx. 29.2 sq. metres (314.0 sq. feet)

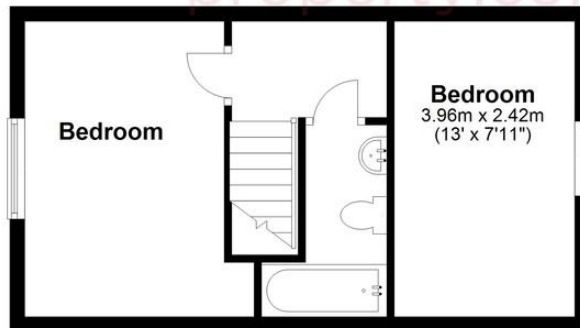

Total area: approx. 76.5 sq. metres (823.1 sq. feet)

Our team are friendly, experienced and are all local. They know it better than they do their own living rooms and can help you find what you're looking for because **we love where we live.**

We would be delighted to show you around this property.

**Because every home  
needs a personal touch.**

**If you would like to view this  
property then please get in touch.**

 01793 296880

 [oldtown@mcfarlaneproperty.com](mailto:oldtown@mcfarlaneproperty.com)

[mcfarlaneproperty.com](http://mcfarlaneproperty.com)

**mcfarlane**  
property.com

**Cricklade.**  
102 High Street  
Cricklade SN6 6AA  
 01793 751044

**Marlborough.**  
106 High Street  
Marlborough SN8 1LT  
 01672 514380

**Old Town.**  
28-30 Wood Street  
Swindon SN1 4AB  
 01793 296880

**Swindon.**  
The Village Centre,  
Redhouse SN25 2FW  
 01793 296600

Agents Note: Whilst every care has been taken to prepare these sales particulars, they are for guidance purposes only. All measurements are approximate and are for general guidance purposes only and whilst every care has been taken to ensure their accuracy, they should not be relied upon and potential buyers are advised to recheck the measurements