



2 Bedroom Bungalow £250,000

48 Derwent Drive, Swindon, SN2 7NJ

**mcfarlane**  
property.com



## 2 Bedroom Bungalow Swindon East

- BUNGALOW
- SEMI-DETACHED
- TWO DOUBLE BEDROOMS

McFarlane Sales & Lettings are pleased to offer to market, with no onward chain, this spacious semi-detached bungalow in the sought after area of Stratton. Located within walking distance of local shops, schools and other amenities, this property briefly comprises of entrance hall, modern fitted kitchen, spacious living room, two double bedrooms and a modern family bathroom. Further benefits include gas central heating, double glazed windows, gardens to the front and rear of the property and a garage with off road parking.



### Property description







## Ground Floor

Approx. 55.5 sq. metres (597.1 sq. feet)

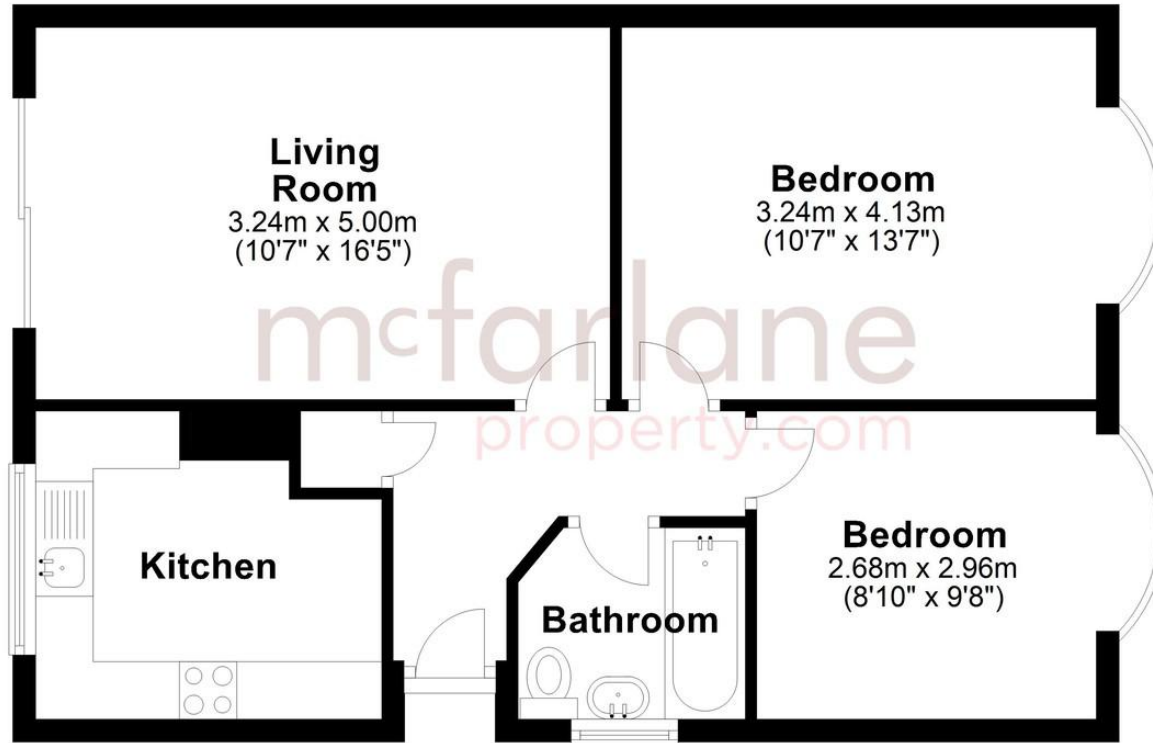

Total area: approx. 55.5 sq. metres (597.1 sq. feet)

We   
where you  
**LIVE**

Our team are friendly, experienced and are all local. They know it better than they do their own living rooms and can help you find what you're looking for because **we love where we live.**

We would be delighted to show you around this property.

**Because every home  
needs a personal touch.**

**If you would like to view this  
property then please get in touch.**

📞 01793 296880

✉ [oldtown@mcfarlaneproperty.com](mailto:oldtown@mcfarlaneproperty.com)

[mcfarlaneproperty.com](http://mcfarlaneproperty.com)

**mcfarlane**  
property.com

### **Cricklade.**

102 High Street  
Cricklade SN6 6AA

📞 01793 751044

### **Marlborough.**

106 High Street  
Marlborough SN8 1LT

📞 01672 514380

### **Old Town.**

28-30 Wood Street  
Swindon SN1 4AB

📞 01793 296880

### **Swindon.**

The Village Centre,  
Redhouse SN25 2FW

📞 01793 296600

Agents Note: Whilst every care has been taken to prepare these sales particulars, they are for guidance purposes only. All measurements are approximate and are for general guidance purposes only and whilst every care has been taken to ensure their accuracy, they should not be relied upon and potential buyers are advised to recheck the measurements