

**For Rent**



## People Make Places



**Berwick Street, Soho W1**

1 bedrooms | 398 sq ft

£595 pw





This one bedroom modern apartment, located on the second floor, offers an open plan kitchen reception room, a comfortable double bedroom and a modern bathroom with shower. There is air conditioning throughout. Offers a fantastic central London location with excellent transport links across the city.

#### What you need to know

- One bedroom
- One bathroom
- Open plan kitchen reception room
- Modern appliances
- Wood floors throughout
- Unfurnished
- Available early May
- Fantastic Soho location
- Close to Tottenham Court Road Station
- Professionally managed





### Overview

The apartment is surrounded by a variety of restaurants, shops, parks and outstanding places of interest. The West End, with its theatres, cinemas and buzzing nightlife is just at your doorstep.

The apartment has double glazed windows and air conditioning.

Available early May on an unfurnished basis. The landlord offers (subject to contract) 1-2 year contracts with either a 6 or 12 month break clause, as negotiated.



# People Make Places

London is collection of inspiring urban villages and one of the most exciting places in the world to live, work & play.

We work with both property owners and their occupiers, sharing the story of these vibrant neighbourhoods, conveying the unique soul & energy to future custodians, the people who'll keep them buzzing.

And unlike many real estate businesses we're not just about buildings, because streets & buildings don't make a neighbourhood.

We're about building relationships, because **people make places**.

MISINTERPRITATION ACT (COPYRIGHT) DISCLAIMER: Tavistock Bow Ltd for themselves and for the vendor(s) of this property whose agents they are, given notice that: 1. These particulars do not constitute, not constitute any part of, an offer or contract. 2. None of the statements contained in these particulars as to the property are to be relied on as statements or representations of fact. 3. Any intending purchaser or lessee must satisfy themselves by inspection or otherwise as to the correctness of each of the statements contained in these particulars. 4. The vendor(s) or lessor(s) do not make or give and neither Tavistock Bow Ltd nor any person in their employment has any authority to make or give any representation or warranty whatever in relation to this property. Finance Act 1989, Unless otherwise stated all prices and rents are quote exclusive of VAT. Property Misrepresentation Act 1991; These details are believed to be correct at the time of compilation but may be subject to subsequent amendment.

Follow us:     @tavistockbow

Score	Energy rating	Current	Potential
92+	A		
81-91	B	83 B	83 B
69-80	C		
55-68	D		
39-54	E		
21-38	F		
1-20	G		

Berwick Street, W1F

Approximate Gross Internal Area 37 sq m / 398 sq ft

Second Floor

1 Living / 2 Bedroom  
 Kitchen / 3.29 x 4.51M  
 Dining 10'7" x 14'6"  
 4.50 x 4.34M  
 14'7" x 14'2"

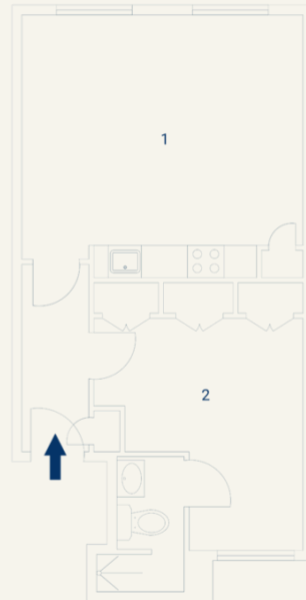

Floorplan produced for Tavistock Bow, illustration for identification purposes only and not to scale. All measurements are approximate and not to be relied upon.

**tavistockbow**

21 New Row, Covent Garden,  
 London, WC2N 4LE

t: 020 7477 2177  
 e: hello@tavistockbow.com  
 w: tavistockbow.com



**Berwick Street, Soho W1**