



18 Butterbur Way, HARROGATE

Guide Price **£230,000**



MYRINGS
Harrogate's Family Estate Agent



18 Butterbur Way

HARROGATE, Harrogate

This well-presented semi-detached property with large rear garden, parking for two vehicles and two double bedrooms is located in a popular residential area on the outskirts of Harrogate's town centre.

Council Tax band: B

Tenure: Freehold

- POPULAR RESIDENTIAL AREA
- PARKING FOR 2 VEHICLES
- LARGE GARDEN
- 2 DOUBLE BEDROOMS
- WELL PRESENTED THROUGHOUT



MYRINGS



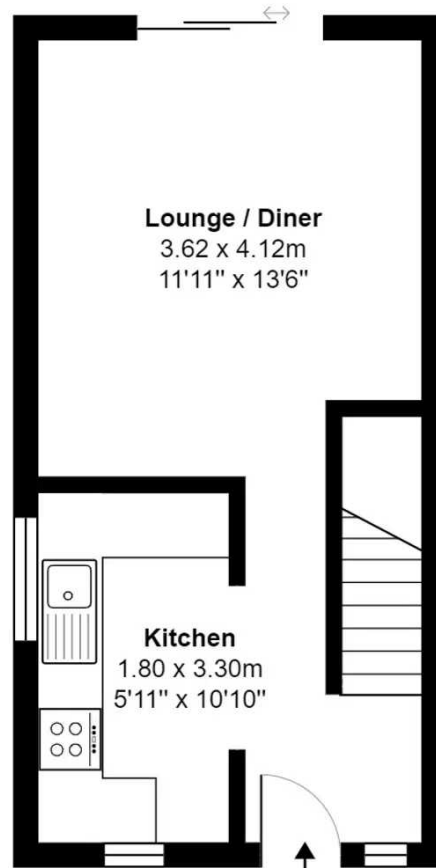

Ground Floor
 Area: 27.4 m² ... 295 ft²

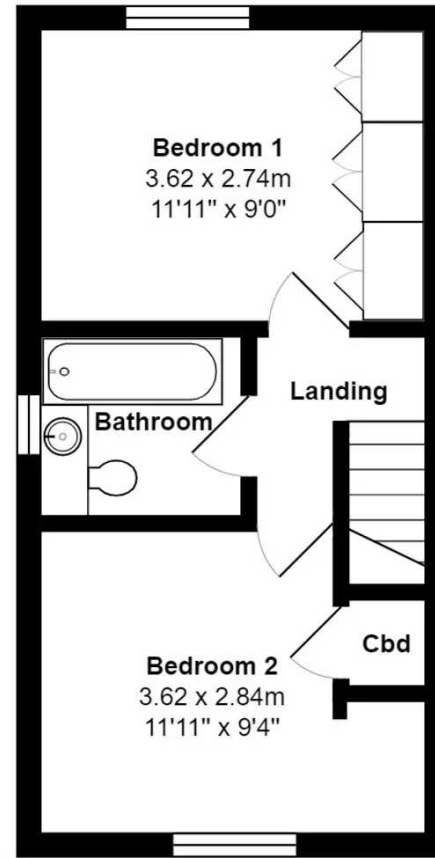

First Floor
 Area: 27.4 m² ... 295 ft²



Total Area: 54.9 m² ... 591 ft²

All measurements are approximate and for display purposes only.





Myrings Estate Agents

Myrings Estate Agents Ltd, 10 Princes Square - HG1 1LX

01423
566400

• enquiries@myringsestateagents.com • <http://myringsestateagents.com/>

WE'VE WON!

Double GOLD Winners
Placed in the top 2% of Estate Agents in the country by The Best Estate Agency Guide
Awarded for marketing, customer service & results