



Period Cottage with Rural Aspect

Station Cottages, Shrivenham, Wiltshire, SN6 8JN

Asking Price Of £325,000

**mcfarlane**  
property.com

## 3 Bedrooms Mid Terraced Swindon, Shrivenham

- ATTRACTIVE REFURBISHED COTTAGE
- BEAUTIFULLY PRESENTED
- IMPROVED TO A HIGH STANDARD

- ATTRACTIVE COTTAGE OVERLOOKING OPEN FIELDS - BEAUTIFULLY PRESENTED - REFURBISHED THROUGHOUT - LOVELY CHARM & CHARACTER - AMPLE PARKING - NO ONWARD CHAIN -

A superb opportunity to acquire a beautiful cottage which dates to 1840 and oozes charm and character throughout. The property has been renovated to a high standard and includes a 15ft lounge with feature fireplace (with log burner), 15ft refitted kitchen/dining room, three bedrooms and a refitted shower room. Outside there is a beautiful garden which overlooks open fields and parking for two/three cars. No Onward Chain.





**mcfarlane**  
property.com



We   
where you  
**LIVE**

### Ground Floor

Approx. 36.1 sq. metres (388.0 sq. feet)

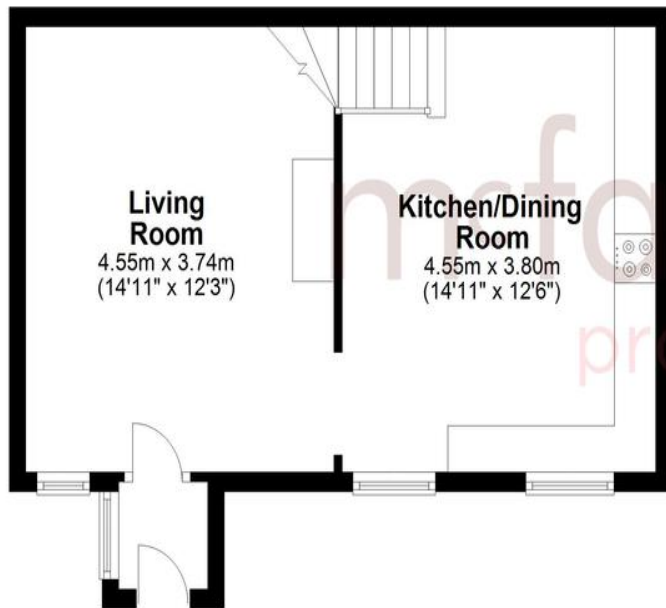

### First Floor

Approx. 34.8 sq. metres (374.1 sq. feet)



Our team are friendly, experienced and are all local. They know it better than they do their own living rooms and can help you find what you're looking for because **we love where we live.**

We would be delighted to show you around this property.

**Because every home needs a personal touch.**

**If you would like to view this property then please get in touch.**

📞 01793 751044

✉ cricklade@mcfarlaneproperty.com

[mcfarlaneproperty.com](http://mcfarlaneproperty.com)

**mcfarlane**  
property.com

Total area: approx. 70.8 sq. metres (762.2 sq. feet)

#### **Cricklade.**

102 High Street  
Cricklade SN6 6AA

📞 01793 751044

#### **Marlborough.**

106 High Street  
Marlborough SN8 1LT

📞 01672 514380

#### **Old Town.**

28-30 Wood Street  
Swindon SN1 4AB

📞 01793 296880

#### **Swindon.**

The Village Centre,  
Redhouse SN25 2FW

📞 01793 296600

Agents Note: Whilst every care has been taken to prepare these sales particulars, they are for guidance purposes only. All measurements are approximate and are for general guidance purposes only and whilst every care has been taken to ensure their accuracy, they should not be relied upon and potential buyers are advised to recheck the measurements