



Preston House, Bow, Crediton

Offers Over £300,000

HELMORES
SINCE 1699

Preston House, Bow

Crediton

- Investment Opportunity for Cash Buyers!
- 3 x two bedroom flats in one building
- 999 year lease with share of freehold
- Being sold with no onward chain
- Awaiting sign-off from building control
- Move quickly to buy at this price level

These three freshly renovated flats in Bow which was formerly the village shop with living accommodation above & behind, with views to fields beyond the communal garden and within walking distance of the bus stop, primary school, modern doctors surgery & village hall, with the Co-Op store and Bow Garden centre & café situated on the edge of the village.

Internally everything was new in 2020-2021, with each of the three flats having two double bedrooms, a new bathroom with a Mira shower & screen over the bath, a new kitchen which includes a 4 ring electric hob, oven and hood over, plus a dishwasher. There are digital electric radiators & a heated towel rail in the bathrooms too.



HELMORES
SINCE 1699



There is also a communal garden for the 4 flats here (one of which has already been sold).

The lease is 999 years from 2021, once the building is sold each unit will have a share of the freehold, so the buyer of this will take over $\frac{3}{4}$ of the freehold upon/after completion.

Please see the floorplan for room sizes.

Current Council Tax: All three flats are in 'Band A'

Utilities: Mains electric, water, telephone & broadband

Broadband within this postcode: Superfast Enabled

Drainage: Mains drainage

Heating: Digital electric radiators

Listed: No

Tenure: Leasehold with $\frac{3}{4}$ share of freehold



HELMORES
SINCE 1699

BOW is a hilltop village on the River Yeo. It sits at the edge of an expansive, wild piece of country, bordered by wind-swept fields of wheat, shadowed by Dartmoor in the distance. It shares a church and common history with the nearby hamlet of Nymet Tracey. 'Nymet' means *Sacred Grove* in Celtic and to the west of Bow is a 3rd millennium BC woodhenge, once a place of spiritual significance for Pagan worshippers in the area. Modern Bow is a peaceful, family-friendly village with a rustic country pub, a popular primary school and a Cooperative mini supermarket – an idyllic country escape.

DIRECTIONS: Preston House is situated in the centre of the village and is marked by a Helmores Board.



Ground Floor

Approx. 50.3 sq. metres (541.8 sq. feet)

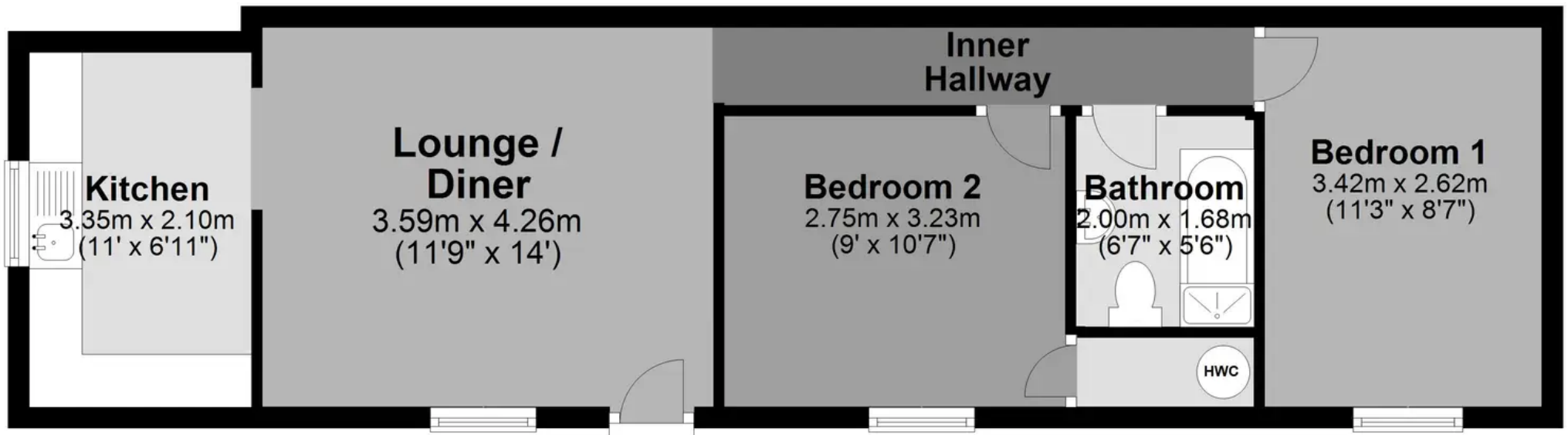

Total area: approx. 50.3 sq. metres (541.8 sq. feet)



Helmores

Helmores, 111-112 High Street - EX17 3LF

01363 777 999

property@helmores.com

helmores.com/

HELMORES
SINCE 1699

These particulars are intended to give a fair and reliable description of the property but no responsibility for any inaccuracy or error can be accepted and do not constitute an offer or contract. We have not tested any services or appliances (including central heating if fitted) referred to in these particulars and the purchasers are advised to satisfy themselves as to the working order and condition. If a property is unoccupied at any time there may be reconnection charges for any switched off/disconnected or drained services or appliances - All measurements are approximate.