

8 Cwrt Edward, Barry
£199,950



8 Cwrt Edward

Barry, Barry

NO CHAIN - WATERFRONT LOCATION - This ideal starter home is located within walking distance to the rail station, beaches, shops and leisure facilities...

Council Tax band: D

Tenure: Freehold

EPC Energy Efficiency Rating: D

EPC Environmental Impact Rating: D

- BATHROOM WITH SHOWER
- LOUNGE WITH DOORS TO GARDEN
- TWO BEDROOMS
- KITCHEN WITH OVEN/HOB
- NO CHAIN; PARKING
- WATERFRONT LOCATION
- EPC D68





Entrance Hall

Carpeted with radiator and arch to kitchen. Door to lounge.

Kitchen

With a range of eye level and base units and complementing worksurfaces with inset sink unit. Wall mounted boiler. Front aspect window. Inset gas hob, oven under and cooker hood over. Space and plumbing for appliances.

Lounge

Carpeted lounge with stairs to first floor. Two radiators. Doors to rear garden.

Landing

Carpeted. Loft hatch. Doors to storage cupboard, two bedrooms and bathroom.

Bedroom One

Carpeted double bedroom with front aspect window. Radiator. Fitted wardrobes.

Bedroom Two

Carpeted with front aspect window. Radiator. Fitted wardrobe.



Bathroom

Panelled bath with thermostatic shower over, close coupled WC and wash hand basin. Opaque window to rear. Radiator. Extractor. Laminate floor.



REAR GARDEN

With an initial decked area and established shrubs. A Southerly position.

ALLOCATED PARKING

2 Parking Spaces



8 Cwrt Edward

Approximate Gross Internal Area

608 sq ft - 56 sq m

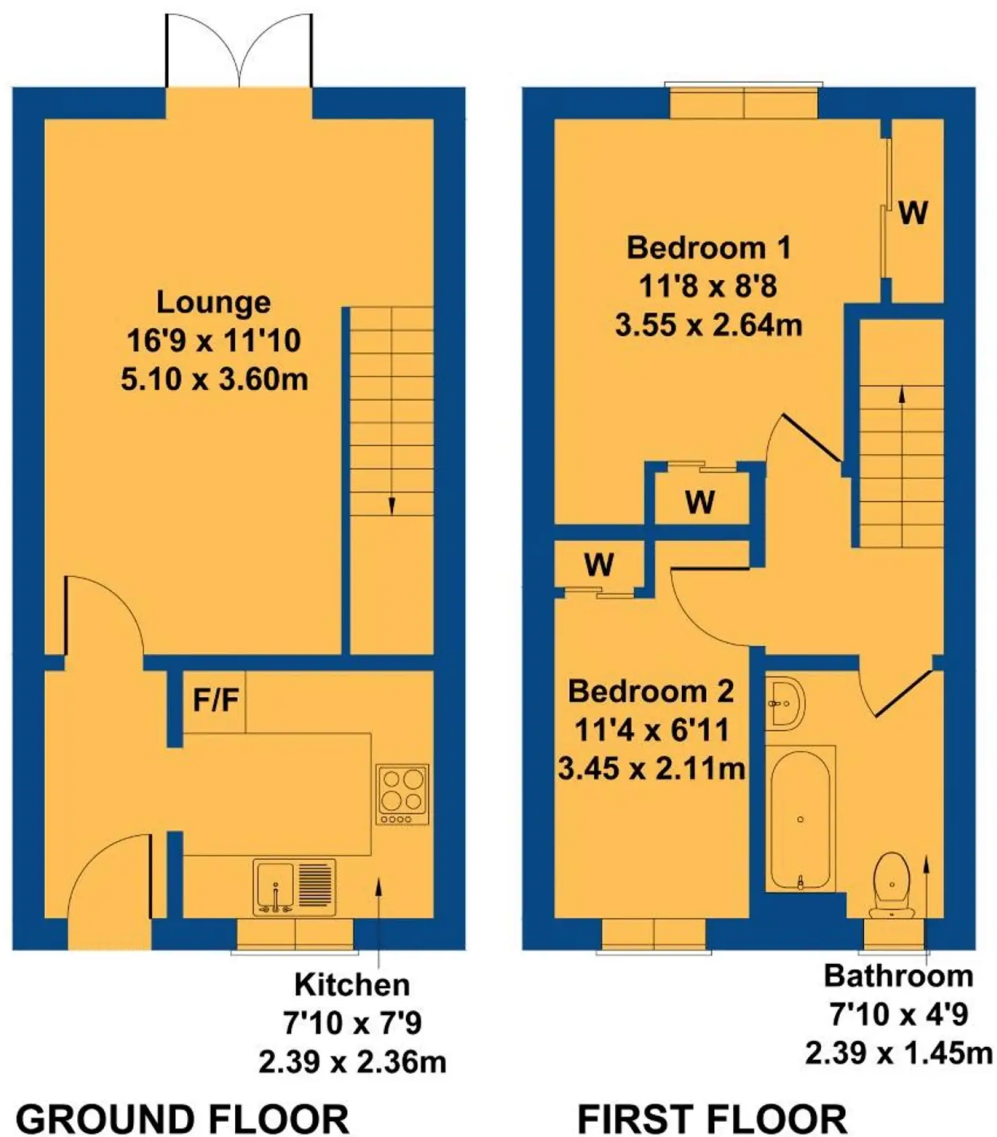

Not to Scale. Produced by The Plan Portal 2022
For Illustrative Purposes Only.



Chris Davies Estate Agents

Chris Davies Estate Agents, 24 High Street - CF62 7EA

01446 700007 • barry@chris-davies.co.uk • www.chris-davies.co.uk/

HELPFUL INFORMATION - whilst we try to ensure our sales particulars are complete, accurate and reliable, if there is any point which is particularly important, please ask and we will be happy to check it, including specific information in respect of commuting links, surroundings, noise, views, or condition. For security purposes, applicants who wish to view will need to provide their name, address and telephone number. All measurements are approximate.