





7 Courtenay Road

Barry, Barry

LARGE PROPERTY IDEAL FOR GROWING FAMILY;
FOUR DOUBLE BEDROOMS OVER THREE FLOORS -
This period family home is situated within easy
access to rail stati...

Council Tax band: C

Tenure: Freehold

EPC Energy Efficiency Rating: D

EPC Environmental Impact Rating: E

- LARGE PERIOD TERRACE
- LOUNGE/DINING ROOM
- GCH AND DOUBLE GLAZING
- ELEVATED TIERED GARDEN
- FOUR DOUBLE BEDROOMS; THREE FLOORS
- KITCHEN;GF WC/SHOWER ROOM
- EPC D57





Entrance Porch

Composite front door leading to tiled porch area with tiled flooring, a further door leading to hallway.

Entrance Hallway

Continuation of tiled flooring from porch. Carpeted stairs leading to the first floor. Door leading to lounge/dining room. Radiator.

Lounge/Diner

Dimensions: 22' 4" x 128' 0" (6.80m x 38.98m). Bay window to front aspect. Feature fire place with surround. Archway leading to dining area. Radiator. Laminated flooring. Window to rear aspect. Door leading into kitchen.

Kitchen

Dimensions: 14' 6" x 6' 10" (4.42m x 2.08m). A galley style kitchen with a modern range of high gloss eye and base level units in grey with complementing work surfaces over, one and a half bowl sink unit. Gas hob with electric oven and built in microwave. Walls and floors tiled. Window to side aspect. Ladder style grey radiator. Plumbing for appliances, and space for large american fridge/freezer. Door leading to WC and shower room.



GF WC and Shower room

Dimensions: 6' 7" x 3' 6" (2.01m x 1.07m). Window to back aspect. Built in shower with mains shower over, low level WC and wash hand basin in a vanity unit in white. Modern towel radiator. Walls and floor tiled.

Landing

Carpeted and laminated, split level landing with further stairs to second floor and internal doors leading to two bedrooms and family bathroom.

Family Bathroom

Dimensions: 7' 1" x 8' 11" (2.16m x 2.72m). Window to side aspect. White low level WC, wash hand basin, bath. Built in cupboard housing combination boiler (replaced Dec 2022) Walls partially tiled and other areas painted. Vinyl flooring.



FRONT GARDEN

Small forecourt with a gate and grey slate and a path leading to front door.

REAR GARDEN

Two levels, grass area, steps leading to decking area and further steps leading to patio area with room for storage. Gate leading to lane.



7 Courtenay Road

Approximate Gross Internal Area
1130 sq ft - 105 sq m

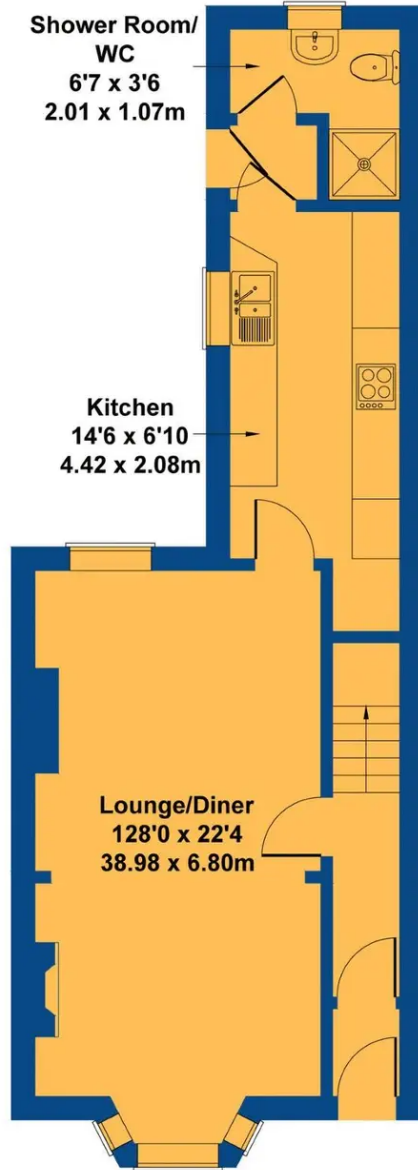

GROUND FLOOR



FIRST FLOOR

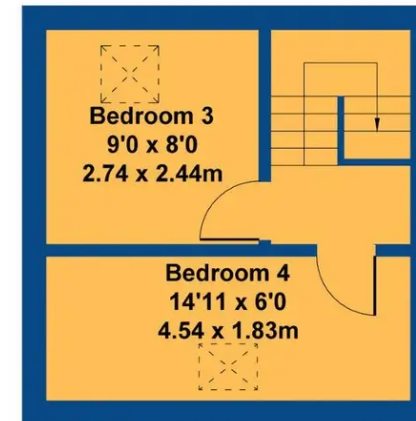

SECOND FLOOR

Not to Scale. Produced by The Plan Portal 2023
For Illustrative Purposes Only.



Chris Davies Estate Agents

Chris Davies Estate Agents, 24 High Street - CF62 7EA

01446 700007 • barry@chris-davies.co.uk • www.chris-davies.co.uk/

HELPFUL INFORMATION - whilst we try to ensure our sales particulars are complete, accurate and reliable, if there is any point which is particularly important, please ask and we will be happy to check it, including specific information in respect of commuting links, surroundings, noise, views, or condition. For security purposes, applicants who wish to view will need to provide their name, address and telephone number. All measurements are approximate.