





3 Chestnut Avenue

St. Athan, Barry

Fronting onto open green space, this well presented mid terraced traditional home lies in a popular location of St Athan, Vale of Glamorgan, within ea...

Council Tax band: B

EPC Energy Efficiency Rating: C

EPC Environmental Impact Rating: C

- FRONTING ONTO GREEN.
- DISTANT COUNTRYSIDE VIEWS.
- MID TERRACED HOME.
- IDEAL FIRST TIME BUY.
- GCH. KITCHEN/DINER.
- 2 BEDS. NO CHAIN. EPC C70.





GROUND FLOOR

Entrance Hallway

Radiator. Stairs to first floor. Door to sitting room. UPVC opaque glazed front entrance door with tiled canopy.

Sitting Room

Dimensions: 11' 8" x 13' 3" (3.55m x 4.04m). UPVC window to front. Radiator. Door to kitchen.

Kitchen/Diner

Dimensions: 16' 0" x 9' 0" (4.87m x 2.74m). Radiator. Wood effect flooring. UPVC opaque glazed door to rear. Wall mounted gas boiler providing the central heating. UPVC window to rear. Fully fitted kitchen comprising eye level units base units with drawers and work surfaces over. Inset stainless steel sink. Inset electric hob and oven. Space for white goods. Partially tiled walls.

FIRST FLOOR

Landing

Doors to bedrooms and bathroom. Loft access.

Bedroom 1

Dimensions: 11' 11" x 13' 9" (3.63m x 4.19m). UPVC window to front. Radiator. Walk in wardrobe (with UPVC window to front).

Bedroom 2

Dimensions: 10' 9" x 9' 2" (3.27m x 2.79m). UPVC window to rear. Radiator. Airing cupboard. Distant countryside views.

Bathroom

Dimensions: 6' 1" x 6' 0" (1.85m x 1.83m). UPVC opaque window to rear. Low level WC. Panelled bath with electric mixer shower over. Radiator. Pedestal wash hand basin. Partially tiled walls. Vinyl floor covering.

OUTSIDE

Front

Open plan garden laid to lawn fronting on to open





3 Chestnut Avenue

Approximate Gross Internal Area
678 sq ft - 63 sq m

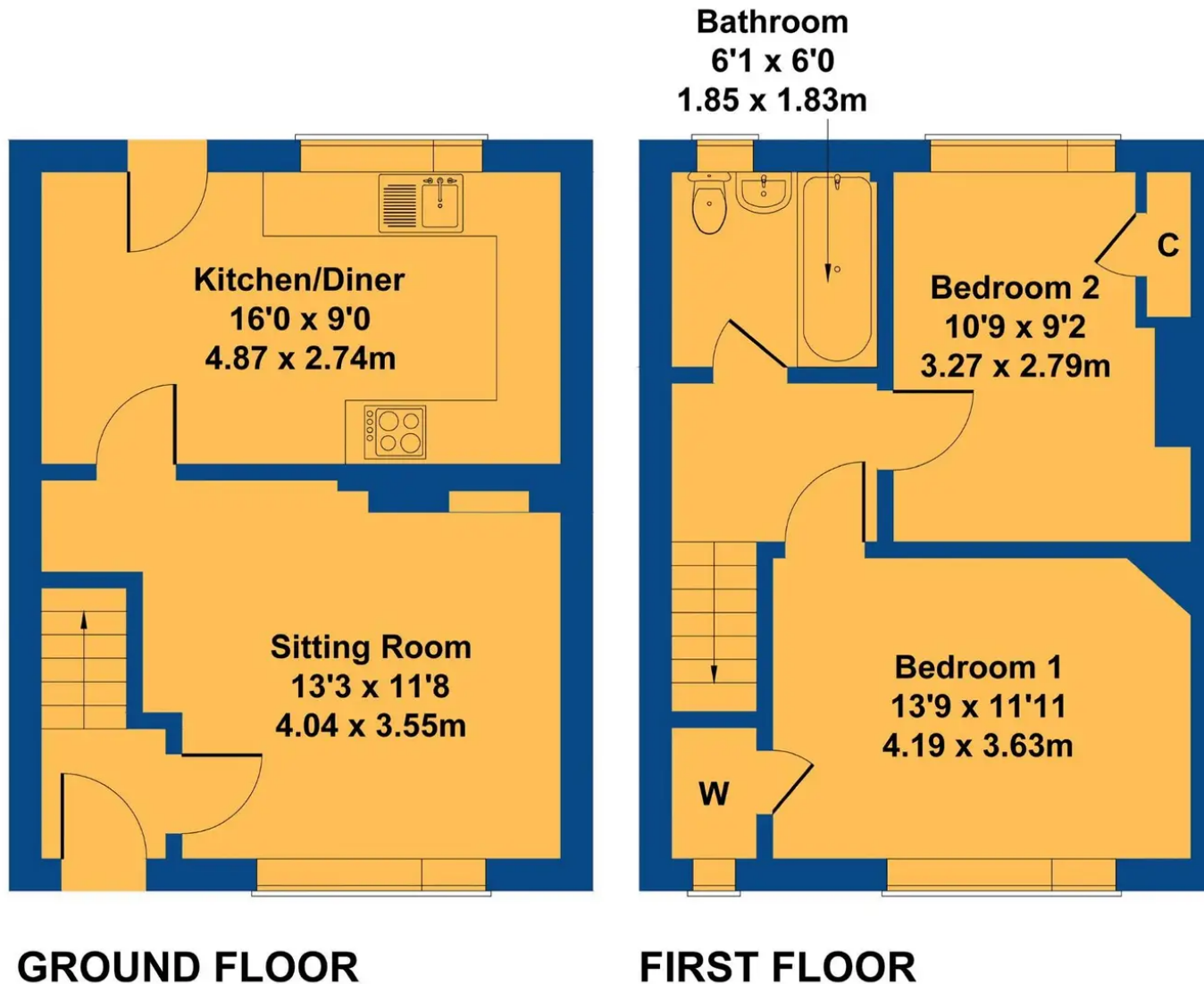

Not to Scale. Produced by The Plan Portal 2023
For Illustrative Purposes Only.



Chris Davies Estate Agents

Chris Davies Estate Agent, Heritage House East Street - CF61 1XY

01446 792020 • llantwitmajor@chris-davies.co.uk • www.chris-davies.co.uk/

HELPFUL INFORMATION whilst we try to ensure our sales particulars are complete, accurate and reliable, if there is any point which is particularly important, please ask and we will be happy to check it, including specific information in respect of commuting links, surroundings, noise, views, or condition. For security purposes, applicants who wish to view will need to provide their name, address and telephone number. All measurements are approximate to the widest and