

5 Trevelyan Court, Llantwit Major
£189,950



5 Trevelyan Court

Llantwit Major, Llantwit Major

An ideal first time buy with with this traditional FOUR BEDROOM end of link home, located in a popular and mature location of Llantwit Major, within...

- IDEAL FIRST TIME BUY.
- NO FORWARD CHAIN.
- UTILITY. GARDENS.
- 4 BEDROOMS.
- UPVC. GCH COMBI.
- END LINK HOME.





GROUND FLOOR

Entrance hallway

UPVC opaque glazed front entrance door with tiled canopy. Radiator. Stairs to first floor. Glazed door to sitting room.

Kitchen

Dimensions: 14' 3" x 11' 5" (4.34m x 3.48m). UPVC window to rear. Partially tiled walls. Radiator. Fully fitted kitchen comprising eye level units, base units with work surfaces over. In set one and a half bowl stainless steel sink with mixer tap. Space for gas cooker. Space for white goods. Opening to larder. Glazed door to utility room. Vinyl floor covering.

Sitting room

Dimensions: 14' 8" x 14' 4" (4.47m x 4.37m). UPVC windows to front. Radiator. Gas fire. Opening to kitchen.

Utility room

Dimensions: 6' 3" x 5' 9" (1.90m x 1.75m). UPVC opaque window to rear. Space for white goods. Work surface. Eye level cupboards. Vinyl floor covering. UPVC opaque glazed door to rear.



FIRST FLOOR

Landing

Doors to bedrooms and shower room. Loft access. Airing cupboard containing wall mounted Worcester combination boiler providing the central heating and hot water.

Bedroom 1

Dimensions: 12' 2" x 10' 7" (3.71m x 3.22m). UPVC window to front. Radiator.

Bedroom 2

Dimensions: 14' 2" x 11' 3" (4.31m x 3.43m). UPVC window to rear. Built in wardrobe.

Bedroom 3

Dimensions: 11' 3" x 7' 2" (3.43m x 2.18m). UPVC window



GROUND FLOOR

Entrance hallway

UPVC opaque glazed front entrance door with tiled canopy. Radiator. Stairs to first floor. Glazed door to sitting room.

Kitchen

Dimensions: 14' 3" x 11' 5" (4.34m x 3.48m). UPVC window to rear. Partially tiled walls. Radiator. Fully fitted kitchen comprising eye level units, base units with work surfaces over. In set one and a half bowl stainless steel sink with mixer tap. Space for gas cooker. Space for white goods. Opening to larder. Glazed door to utility room. Vinyl floor covering.

Sitting room

Dimensions: 14' 8" x 14' 4" (4.47m x 4.37m). UPVC windows to front. Radiator. Gas fire. Opening to kitchen.

Utility room

Dimensions: 6' 3" x 5' 9" (1.90m x 1.75m). UPVC opaque window to rear. Space for white goods. Work surface. Eye level cupboards. Vinyl floor covering. UPVC opaque glazed door to rear.



FIRST FLOOR

Landing

Doors to bedrooms and shower room. Loft access. Airing cupboard containing wall mounted Worcester combination boiler providing the central heating and hot water.

Bedroom 1

Dimensions: 12' 2" x 10' 7" (3.71m x 3.22m). UPVC window to front. Radiator.

Bedroom 2

Dimensions: 14' 2" x 11' 3" (4.31m x 3.43m). UPVC window to rear. Built in wardrobe.

Bedroom 3

Dimensions: 11' 3" x 7' 2" (3.43m x 2.18m). UPVC window





5 Trevelyan Court

Approximate Gross Internal Area
969 sq ft - 90 sq m

Utility Room
6'3 x 5'9
1.90 x 1.75m



GROUND FLOOR

Shower Room
7'1 x 5'1
2.16 x 1.55m

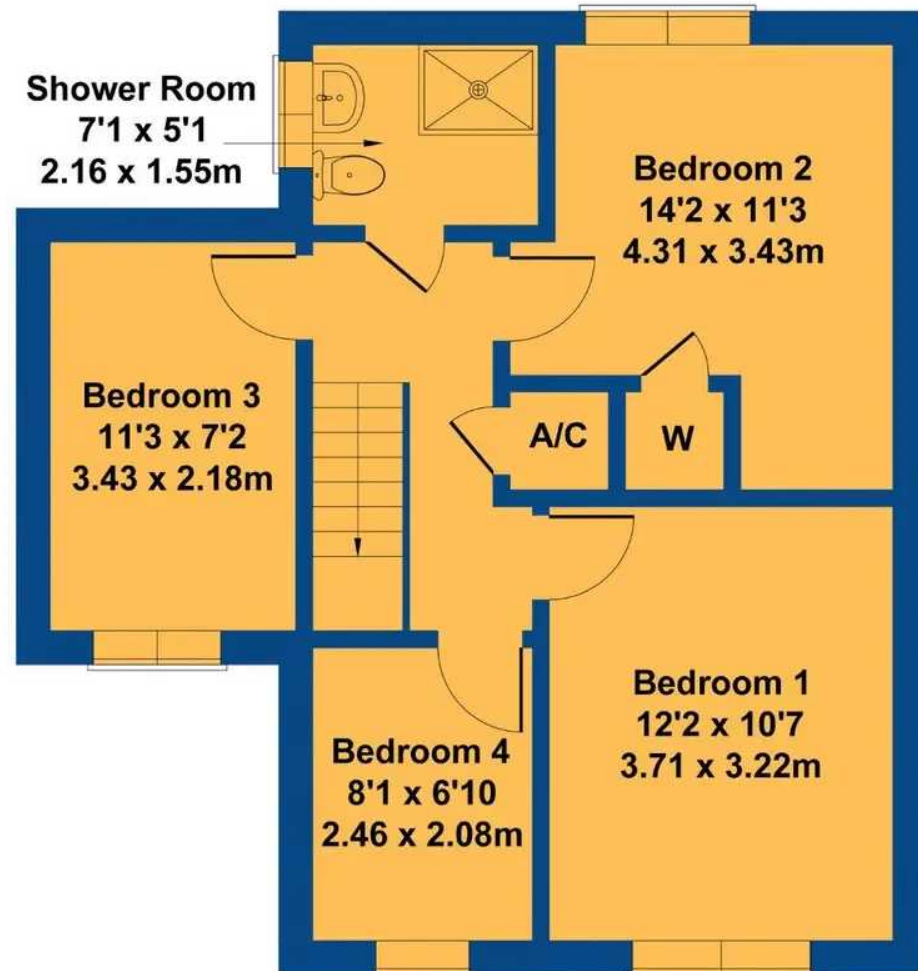

FIRST FLOOR

Not to Scale. Produced by The Plan Portal 2023
For Illustrative Purposes Only.



Chris Davies Estate Agents

Chris Davies Estate Agent, Heritage House East Street - CF61 1XY

01446 792020 • llantwitmajor@chris-davies.co.uk • www.chris-davies.co.uk/

HELPFUL INFORMATION whilst we try to ensure our sales particulars are complete, accurate and reliable, if there is any point which is particularly important, please ask and we will be happy to check it, including specific information in respect of commuting links, surroundings, noise, views, or condition. For security purposes, applicants who wish to view will need to provide their name, address and telephone number. All measurements are approximate to the widest and

You can include any text here. The text can be modified upon generating your brochure.

You can include any text here. The text can be modified upon generating your brochure.