

Chestnut Villa Colhugh Street, Llantwit Major
£369,950



Chestnut Villa Colhugh Street

Llantwit Major, Llantwit Major

Council Tax band: E

Tenure: Freehold

EPC Energy Efficiency Rating: E

EPC Environmental Impact Rating: E

- SEMI DETACHED PERIOD HOME.
- 3 BEDROOMS. 2 RECEPTIONS.
- GCH COMBI. SASH WINDOWS.
- PRIVATE GARDEN. NO CHAIN.
- LOG BURNER. CLOAKS/WC.
- SOUGHT AFTER LOCATION.





Entrance Hallway

Front entrance door. Velux. Ceramic floor tiles. Vertical radiator. Down lighting. Door to dining room. Opening to kitchen.

Kitchen

12' 6" x 8' 4" (3.81m x 2.54m)

Window to rear. Glazed door to rear porch. Fully fitted kitchen comprising eye level units, base units with drawers and work surfaces over. Radiator. Gas hob with oven and grill. Partly tiled walls. Velux's. Inset one and a half bowl stainless steel sink with mixer tap. Vinyl floor covering. Space for fridge/freezer. Down lighting. Integrated dish washer.

Rear Porch

Windows and door to rear. Quarry tiles. Cupboard containing space for tumble dryer and washing machine. Door to cloakroom/WC.

Cloakroom

Low level WC. Opaque window to rear.

Dining Room

9' 5" x 9' 1" (2.87m x 2.77m)

Window to side. Radiator. Oak flooring. Under stairs cupboard. Door to sitting room.

Sitting Room

14' 11" x 16' 11" (4.55m x 5.16m)

Sash windows to front and side. Fireplace with cast iron log burner. Continuity of oak flooring from dining room. Radiator. Door to staircase leading to the first floor.

Landing

Doors to bedrooms and family bathroom.

Bedroom 1

15' 1" x 9' 10" (4.60m x 3.00m)

Sash window to front. Window to side. Radiator.

Bedroom 2

9' 6" x 8' 7" (2.90m x 2.62m)

Window to rear. Radiator. Built in wardrobe.





Entrance Hallway

Front entrance door. Velux. Ceramic floor tiles. Vertical radiator. Down lighting. Door to dining room. Opening to kitchen.

Kitchen

12' 6" x 8' 4" (3.81m x 2.54m)

Window to rear. Glazed door to rear porch. Fully fitted kitchen comprising eye level units, base units with drawers and work surfaces over. Radiator. Gas hob with oven and grill. Partly tiled walls. Velux's. Inset one and a half bowl stainless steel sink with mixer tap. Vinyl floor covering. Space for fridge/freezer. Down lighting. Integrated dish washer.

Rear Porch

Windows and door to rear. Quarry tiles. Cupboard containing space for tumble dryer and washing machine. Door to cloakroom/WC.

Cloakroom

Low level WC. Opaque window to rear.

Dining Room

9' 5" x 9' 1" (2.87m x 2.77m)

Window to side. Radiator. Oak flooring. Under stairs cupboard. Door to sitting room.

Sitting Room

14' 11" x 16' 11" (4.55m x 5.16m)

Sash windows to front and side. Fireplace with cast iron log burner. Continuity of oak flooring from dining room. Radiator. Door to staircase leading to the first floor.

Landing

Doors to bedrooms and family bathroom.

Bedroom 1

15' 1" x 9' 10" (4.60m x 3.00m)

Sash window to front. Window to side. Radiator.

Bedroom 2

9' 6" x 8' 7" (2.90m x 2.62m)

Window to rear. Radiator. Built in wardrobe.



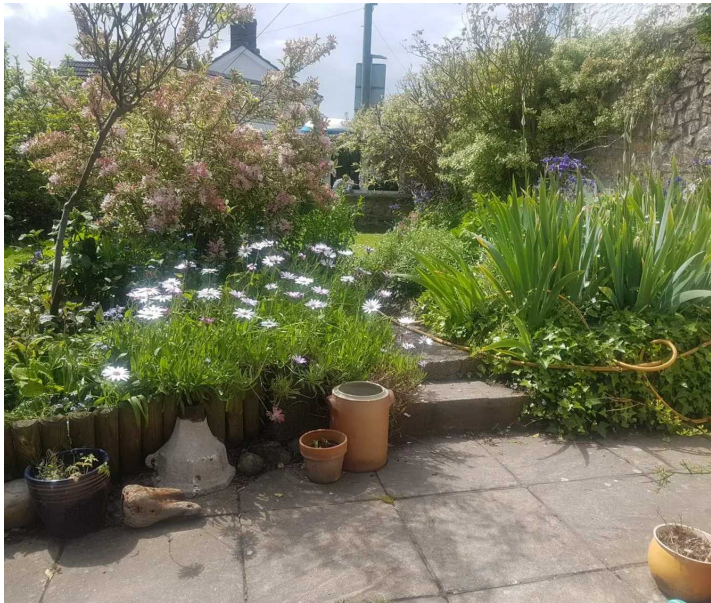



Chestnut Villa

Approximate Gross Internal Area
1324 sq ft - 123 sq m

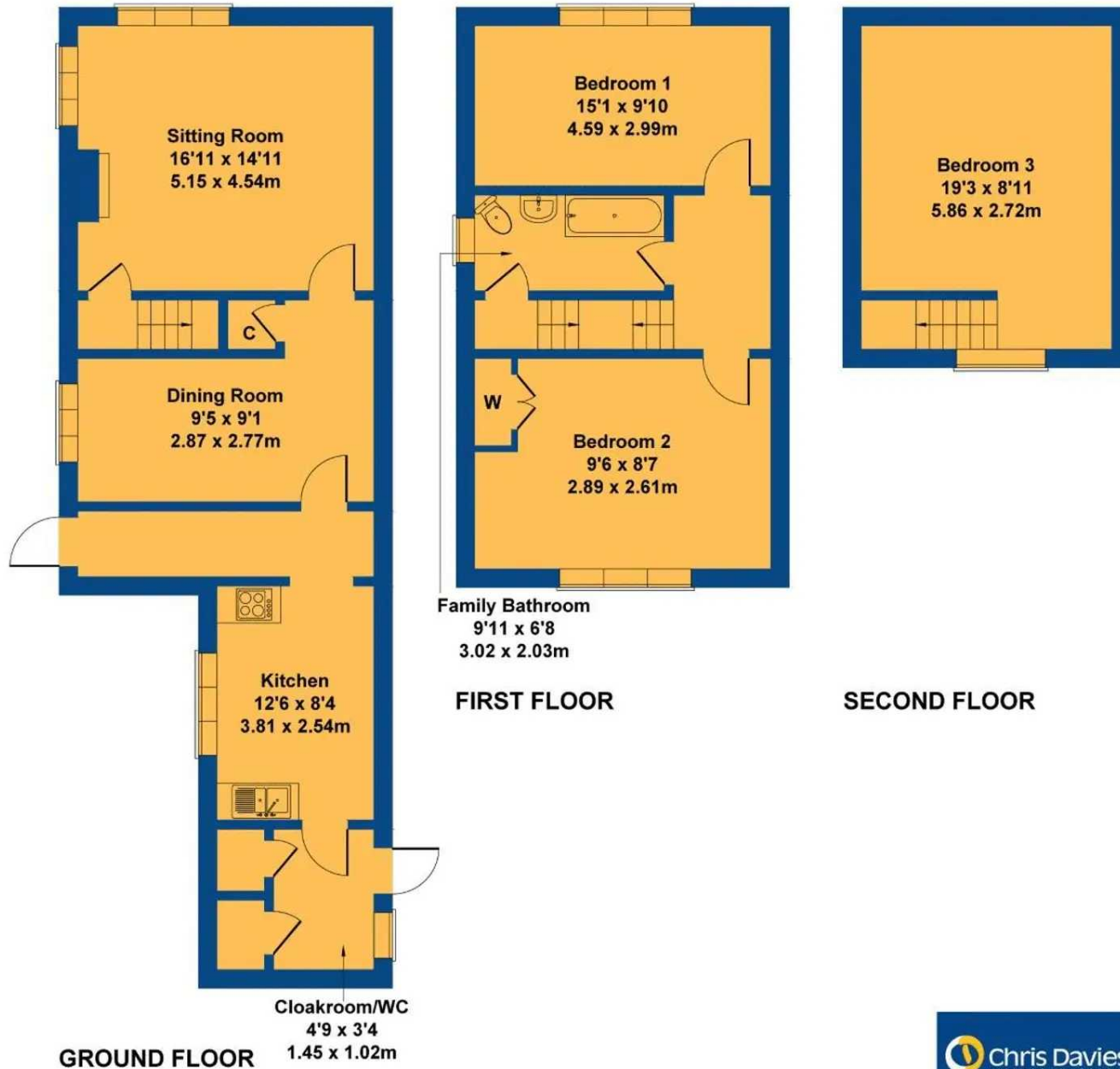

Not to Scale. Produced by The Plan Portal 2023
For Illustrative Purposes Only.



Chris Davies Estate Agents

Chris Davies Estate Agent, Heritage House East Street - CF61 1XY

01446 792020 • llantwitmajor@chris-davies.co.uk • www.chris-davies.co.uk/

HELPFUL INFORMATION whilst we try to ensure our sales particulars are complete, accurate and reliable, if there is any point which is particularly important, please ask and we will be happy to check it, including specific information in respect of commuting links, surroundings, noise, views, or condition. For security purposes, applicants who wish to view will need to provide their name, address and telephone number. All measurements are approximate to the widest and

You can include any text here. The text can be modified upon generating your brochure.

You can include any text here. The text can be modified upon generating your brochure.