



 **3**
Bedrooms

 **1**
Bathroom

7 Glenmore Parade, Ealing Road, Wembley, Middlesex, HA0 4PJ |
wembley@hiltonandfox.com

02089029662



Offered for sale with no upper chain, this is 3 bedroom semi detached house located close to South Kenton Station and Preston Road Station. The property further comprises 2 reception rooms, fitted kitchen, family bathroom off landing with separate WC, rear garden in excess of 75ft. off Road parking and garage via own drive. Keys held at office for immediate viewings.

Offered for sale with no upper chain, this is 3 bedroom semi detached house located close to South Kenton Station and Preston Road Station. The property further comprises 2 reception rooms, fitted kitchen, family bathroom off landing with separate WC, rear garden in excess of 75ft. off Road parking and garage via own drive. Keys held at office for immediate viewings.

GROUND FLOOR
705 sq.ft. (65.5 sq.m.) approx.

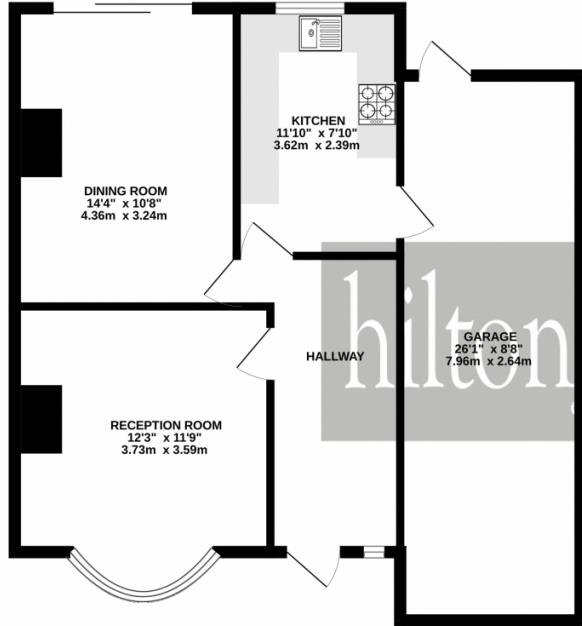

1ST FLOOR
492 sq.ft. (45.7 sq.m.) approx.

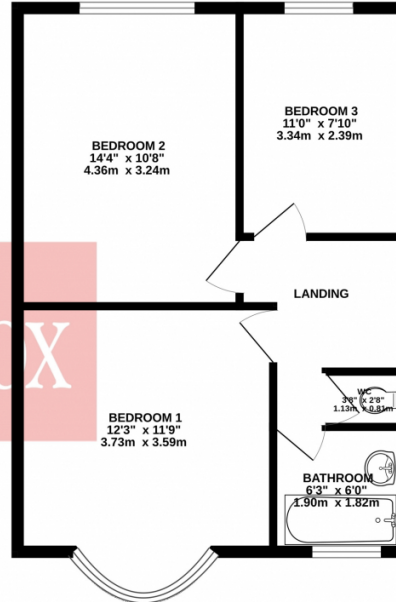

TOTAL FLOOR AREA : 1196 sq.ft. (111.1 sq.m.) approx.

Whilst every attempt has been made to ensure the accuracy of the floorplan contained here, measurements of doors, windows, rooms and any other items are approximate and no responsibility is taken for any error, omission or mis-statement. This plan is for illustrative purposes only and should be used as such by any prospective purchaser. The services, systems and appliances shown have not been tested and no guarantee as to their operability or efficiency can be given.
Made with Metropix ©2023

Energy Efficiency Rating

	Current	Potential
Very energy efficient - lower running costs		
(92+) A		
(81-91) B		84
(69-80) C		
(55-68) D	59	
(39-54) E		
(21-38) F		
(1-20) G		
Not energy efficient - higher running costs		
England, Scotland & Wales	EU Directive 2002/91/EC	

Address: Windermere Avenue, Wembley, Middlesex HA9





Northwick Park

Northwick Park Community Garden

Northwick Park Hospital

Hodgson Court

Playgolf London

Parish Church of Saint Cuthbert

Rupal Tailoring

South Kenton

The Windermere

Northwick Park

Mount Stewart Junior School

Mount Stewart Infant School

John Billam Sports Ground

Kenton hall play area

Kenton Hall

Preston Park Primary School

Preston Park

Carlton Ave E

Logan Rd

Northwick Ave

Draycott Ave

Woodhill Cres

Lulworth Ave

Grasmere Ave

Windermere Ave

Norval Rd

The Fairway

Nathans Rd

Montpelier Rise

First A