



10 Hereford Road, Harrogate

Harrogate

Guide Price **£1,350,000**



MYRINGS

Harrogate's Family Estate Agent



10 Hereford Road

Harrogate, Harrogate

Combe Dingle is a splendid 7 bedroom double fronted Victorian residence of some size retaining pretty much all of it's original charm and character standing in wonderful mature grounds with two separate garage blocks with potential situated on the leafy highly sought after Duchy Estate within a short stroll of the Valley Gardens and town centre.

Council Tax band: F

Tenure: Freehold

- ELEGANT RESIDENCE
- IMPOSING ROOMS
- LARGE MATURE GROUNDS
- CLOSE TO VALLEY GARDENS & TOWN CENTRE
- NO CHAIN
- DETACHED GARAGES



MYRINGS



Hereford Road, Harrogate, HG1

Approximate Area = 3384 sq ft / 314.3 sq m

Garage = 484 sq ft / 45 sq m

Store = 63 sq ft / 5.8 sq m

Total = 3931 sq ft / 365.1 sq m

For identification only - Not to scale

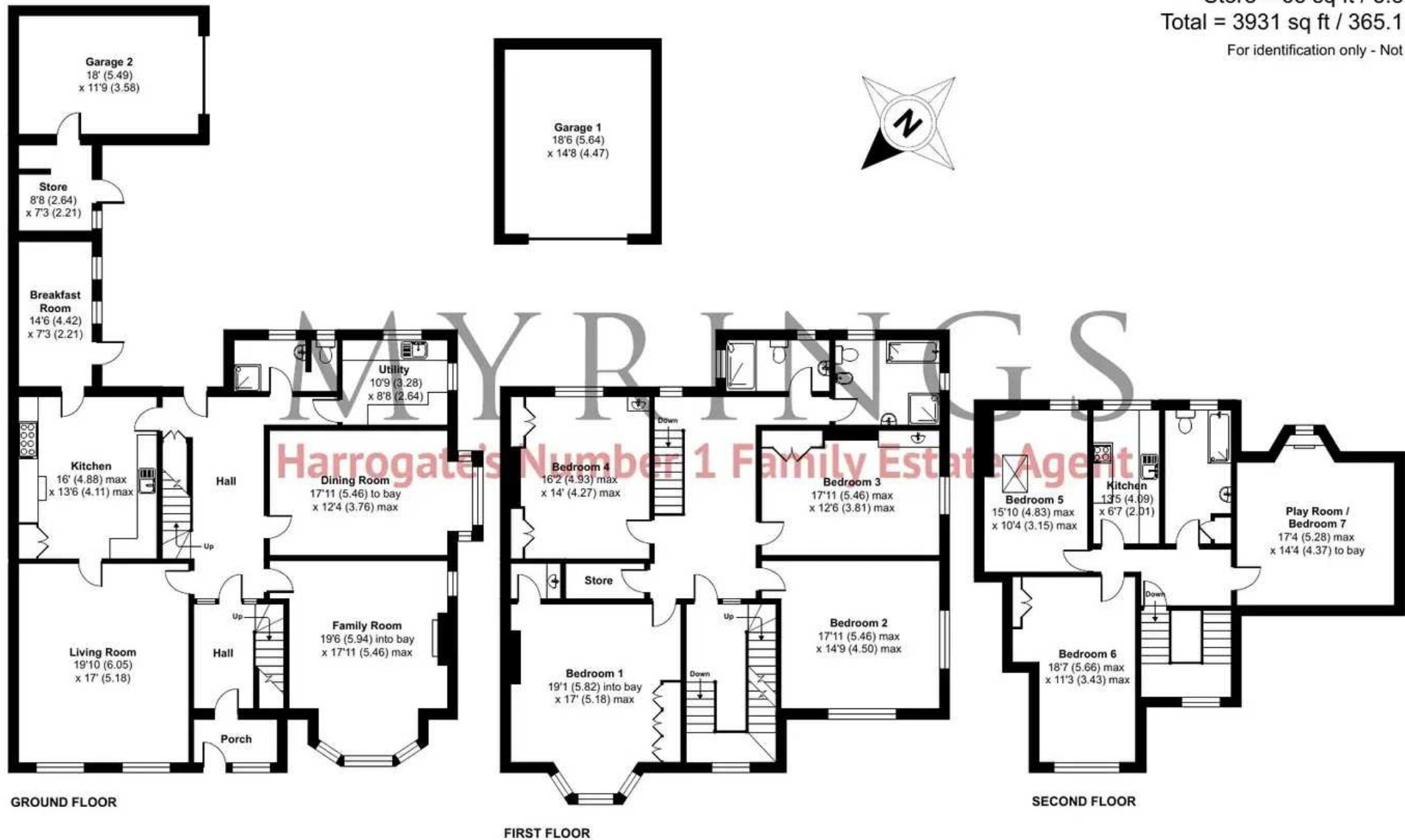

Floor plan produced in accordance with RICS Property Measurement Standards incorporating International Property Measurement Standards (IPMS2 Residential). © nichecom 2023. Produced for Myrings. REF: 1023885





Myrings Estate Agents

Myrings Estate Agents Ltd, 10 Princes Square - HG1 1LX

01423
566400

• enquiries@myringsestateagents.com • <http://myringsestateagents.com/>

