



6 Hawk Drive , Doncaster , DN7 4FF
£220,000 Freehold

MARTIN&CO

Hawk Drive , Doncaster

3 Bedrooms, 2 Bathroom

£220,000

- Three Bedrooms.
- End-Terraced.
- Allocated Parking for Two Cars.
- New Build Estate.
- Quiet Cul-De-Sac Location.
- Close to Local Amenities.
- Close to excellent commuter links

A fantastic opportunity to purchase this stunning three bedroom end terraced property in Hatfield. Briefly comprising a living room, modern kitchen / diner and WC on the ground floor. There is a master bedroom with ensuite, second double bedroom, single bedroom and family bathroom located on the first floor. The property also benefits from off road parking for two cars at the side of the property and an enclosed rear garden. Situated in a new

%epcGraph_c_1_363%



build estate close to local amenities and good transport links. Call now to arrange a viewing.

KITCHEN 10' 8" x 15' 2" (3.25m x 4.62m) With a range of light grey shaker style wall and base units, complimented with grey worktops. Also benefits from a Gas Oven, Hob and Extractor Fan. There is also plumbing for a Washing Machine and plenty of space for a generous family dining table.

LIVING ROOM A spacious Living Room with patio doors leading to the Rear Garden.

WC 2' 11" x 5' 6" (0.89m x 1.68m) Useful WC situated on the located on the Ground Floor.

BEDROOM 10' 8" x 8' 3" (3.25m x 2.51m) A good sized double bedroom with plenty of space for a range wardrobes.

BEDROOM 10' 7" x 6' 7" (3.23m x 2.01m) A generous single bedroom situated on the first floor, currently

being used as a home office.

BEDROOM 10' 5" x 9' 4" (3.18m x 2.84m) Master bedroom with ensuite shower room.

ENSUITE 7' 10" x 5' 7" (2.39m x 1.7m) Leading from the Master Bedroom, a modern fitted en-suite with WC hand basin and walk-in-shower.

BATHROOM 6' 11" x 5' 7" (2.11m x 1.7m) A modern family bathroom fitted with white three piece suite.







GROUND FLOOR
404 sq.ft. (37.6 sq.m.) approx.

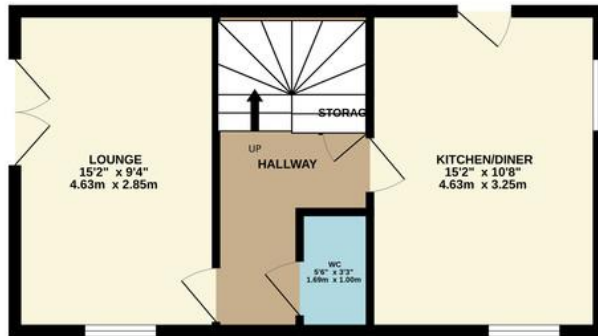

1ST FLOOR
402 sq.ft. (37.4 sq.m.) approx.

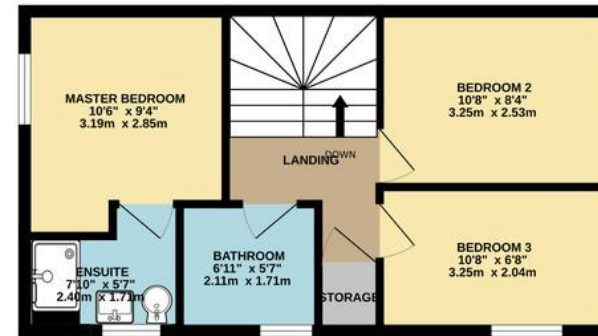

TOTAL FLOOR AREA : 807 sq.ft. (74.9 sq.m.) approx.

Whilst every attempt has been made to ensure the accuracy of the floorplan contained here, measurements of doors, windows, rooms and any other items are approximate and no responsibility is taken for any error, omission or mis-statement. This plan is for illustrative purposes only and should be used as such by any prospective purchaser. The services, systems and appliances shown have not been tested and no guarantee as to their operability or efficiency can be given.
Made with Metropix ©2023

Martin & Co Doncaster

38 Hall Gate • Doncaster • DN1 3NR
T: 01302 343 494 • E: doncaster@martinco.com

01302 343 494

<http://www.martinco.com>



Accuracy: References to the Tenure of a Property are based on information supplied by the Seller. The Agent has not had sight of the title documents. A Buyer is advised to obtain verification from their Solicitor. Items shown in photographs including but not limited to carpets, fixtures and fittings are not included unless specifically mentioned within the sales particulars. They may however be available by separate negotiation. Buyers must check the availability of any property and make an appointment to view before embarking on any journey to see a property. No person in the employment of the agent has any authority to make any representation about the property, and accordingly any information given is entirely without responsibility on the part of the agents, sellers(s) or lessors(s). Any property particulars are not an offer or contract, nor form part of one. **Sonic / Laser Tape:** Measurements taken using a sonic / laser tape measure may be subject to a small margin of error. **All Measurements:** All Measurements are Approximate. **Services Not tested:** The Agent has not tested any apparatus, equipment, fixtures and fittings or services and so cannot verify that they are in working order or fit for the purpose. A Buyer is advised to obtain verification from their Solicitor or Surveyor.

