

Shared Ownership
£116,000

Plot 32, 8 Rays Close, Bury, Ramsey, Huntingdon PE26 2LE



To arrange a viewing call us now on 01354 694900

40% SHARED OWNERSHIP

A brand new three bedroom semi-detached family home being offered for sale on a shared ownership scheme.

The price indicated is to purchase 40% of the value of £290,000. The rent will be £311.32 pcm plus a service charge payment of £38.69.

The accommodation comprises open plan kitchen/dining/lounge, cloakroom, three bedrooms and family bathroom.

There will also be parking.

Ground Floor

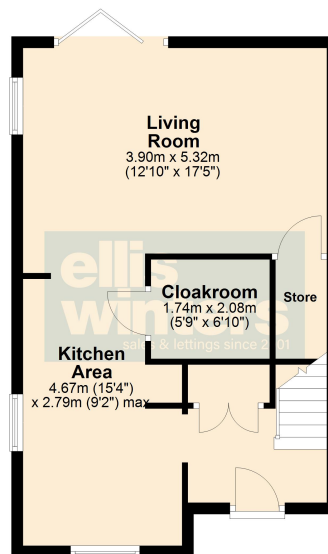

First Floor

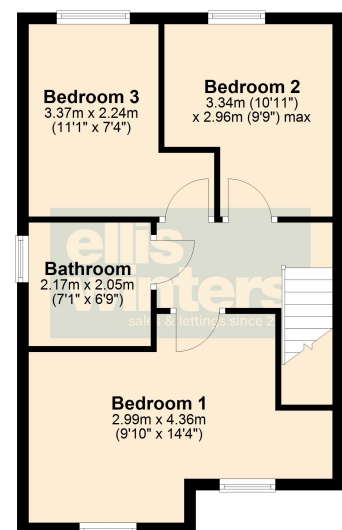

Shared Ownership
£116,000

Plot 32, 8 Rays Close, Bury, Ramsey, Huntingdon PE26 2LE



40% SHARED OWNERSHIP

A brand new three bedroom semi-detached family home being offered for sale on a shared ownership scheme.

The price indicated is to purchase 40% of the value of £290,000. The rent will be £311.32 pcm plus a service charge payment of £38.69.



The accommodation comprises open plan kitchen/dining/lounge, cloakroom, three bedrooms and family bathroom. There will also be parking.

Energy rating - B
Huntingdonshire District Council Tax Band - TBC



Ellis Winters has not tested any apparatus, equipment fitting or services and so cannot verify that they are in working order. The buyer is advised to obtain verification from their solicitor or surveyor. Floor plans are for representational purposes only and are not to scale.



Ellis Winters & Co 20 Market Hill, Chatteris, Cambridgeshire, PE16 6BA
Tel: 01354 694900 Email: info@elliswinters.co.uk www.elliswinters.co.uk