



3 Bedroom Mid Terraced Asking Price Of £290,000

148 Eastbury Way, Redhouse , Swindon, Wiltshire , SN25 2FP

mcfarlane
property.com

3 Bedroom Mid Terraced Swindon, North Swindon

- Three Double Bedrooms
 - Garage
 - Master suite with dressing room and En-suite
 - Well presented throughout
-

This is a lovely THREE DOUBLE BEDROOM family home in the popular area of North Swindon. Internally this is a very well laid out and well-proportioned property laid out over 3 floors. The property is situated just a short walk from the local Orbital Shopping center with schools within walking distance and close to bus routes.





We 
where you
LIVE

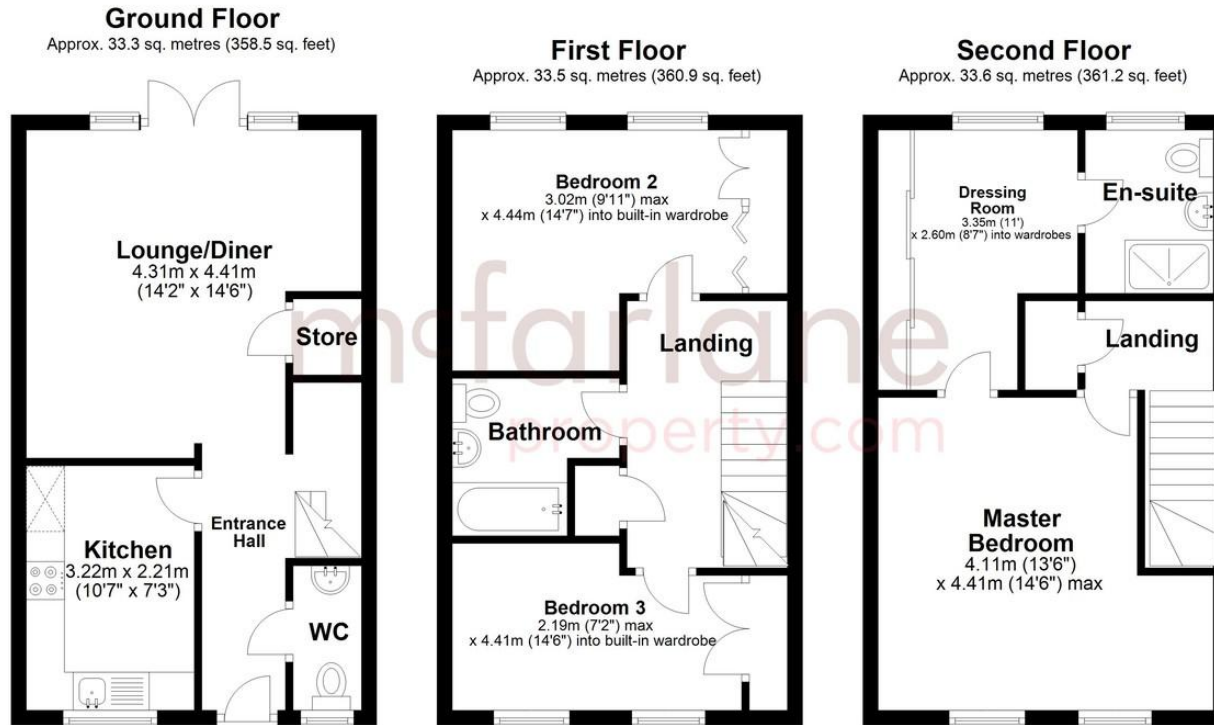

Total area: approx. 100.4 sq. metres (1080.6 sq. feet)

Our team are friendly, experienced and are all local. They know it better than they do their own living rooms and can help you find what you're looking for because **we love where we live.**

We would be delighted to show you around this property.

**Because every home
needs a personal touch.**

**If you would like to view this
property then please get in touch.**

📞 01793 296600

✉ swindon@mcfarlaneproperty.com

mcfarlaneproperty.com

mcfarlane
property.com

Cricklade.
102 High Street
Cricklade SN6 6AA
📞 01793 751044

Marlborough.
106 High Street
Marlborough SN8 1LT
📞 01672 514380

Old Town.
28-30 Wood Street
Swindon SN1 4AB
📞 01793 296880

Swindon.
The Village Centre,
Redhouse SN25 2FW
📞 01793 296600

Agents Note: Whilst every care has been taken to prepare these sales particulars, they are for guidance purposes only. All measurements are approximate are for general guidance purposes only and whilst every care has been taken to ensure their accuracy, they should not be relied upon and potential buyers are advised to recheck the measurements