

ALBERT COURT



KENSINGTON SW7





The wide natural light filled hallway opens to bedrooms on the right hand side, each with their own en-suite bath or shower room, along with an additional family bathroom and guest loo. Descending a short staircase at the end of the hallway leads to grand entertaining rooms, with enviable high ceilings in the dining room, sitting room and drawing room, along with a separate kitchen.

Albert Court sits next to the Royal Albert Hall with views towards Hyde Park from the western side of the building. Knightsbridge, South Kensington and Kensington High Street are all short walks away, with their world renowned shops, amenities and transport links.

FEATURES:

Three Ensuite Bedrooms | Family Bathroom
 Dining Room | Drawing Room | Sitting Room | Kitchen
 Guest WC | 24 Hour Portage | Lift

PRICE: £7,000,000

TENURE: SHARE OF FREEHOLD

SERVICE CHARGE: £25,000 PA

These details have been prepared for general guidance only and should not be relied upon by prospective purchaser/tenants who before proceeding must check and otherwise satisfy themselves as to the property and the nature, state and availability of any facility or service.

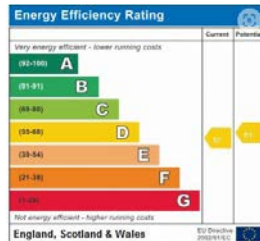

APPROXIMATE GROSS
 INTERNAL AREA
 267.83 SQ M / 2,883 SQ FT

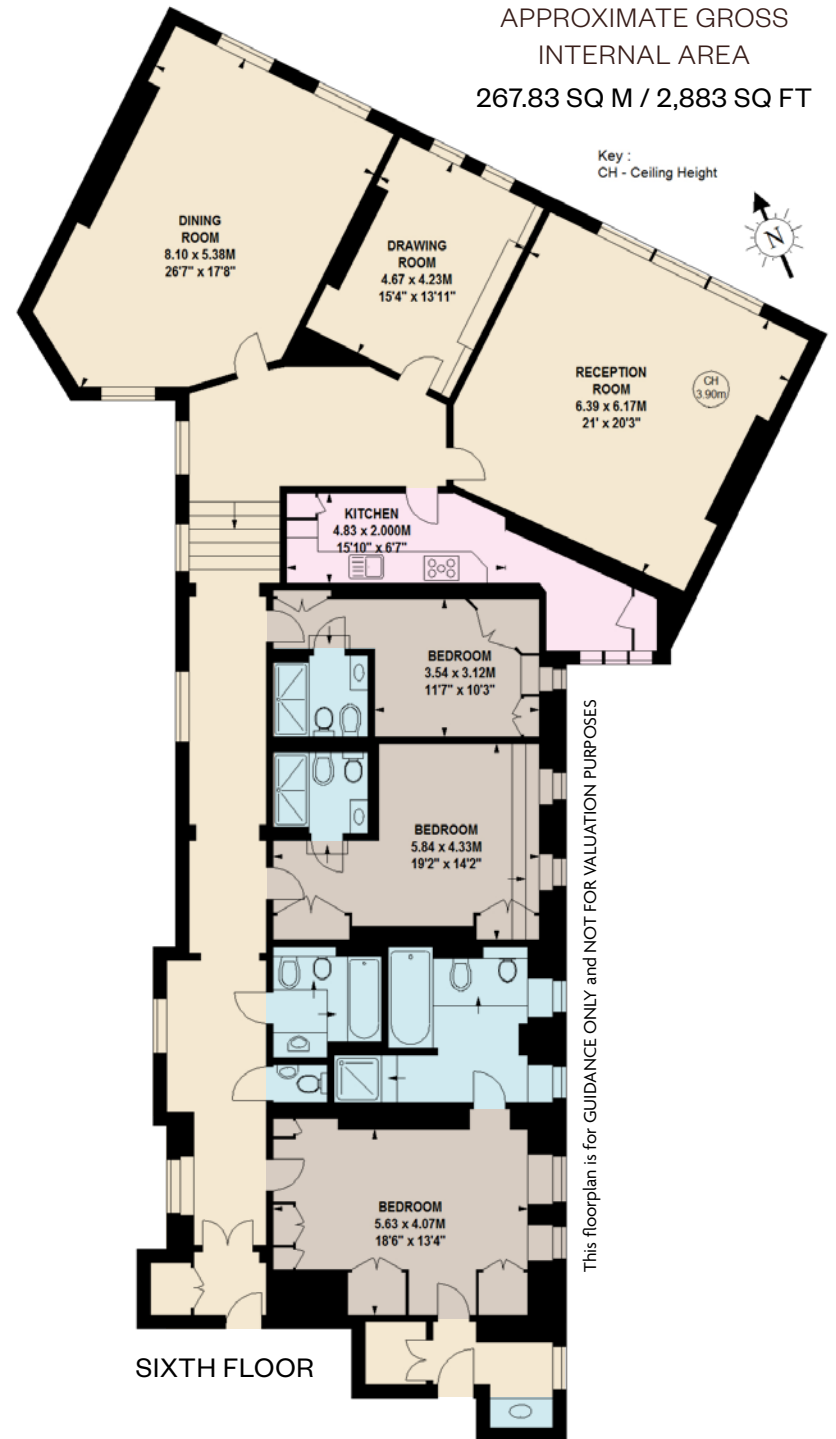

6-8 MONTPELIER STREET,
 LONDON SW7 1EZ
 SALES | +44 (0)20 7581 8277
 LETTINGS | +44 (0)20 7590 1200
 info@nicolasvanpatrick.com
 www.nicolasvanpatrick.com