

Park Road, Coppull

PR7 5AH



£185,000



Delightful three bedroom semi detached property in a quiet and sought after residential area close to schools, primary transport routes and village amenities. Available with no upward chain. To the front the gold coast gravelled driveway can accommodate up to three vehicles and leads to the garage and the main entrance. Step into the vestibule and from there to the entrance hallway and in to the spacious, bay fronted living room. To the rear the dining kitchen comprises a range of wall and base units with double electric oven and grill, five burner gas hob, refrigerator and freezer, dishwasher, washing machine and island. Bespoke bench seating makes excellent use of the space and is a first class dining area. Step outside, via the rear porch, into the south facing garden with lawn, gold coast gravel, mature planting and, being lovely and private, this is a great space in which to relax and entertain. The garage has power and light and offers plenty of additional storage. Back inside, stairs lead to the first floor landing with ladder access to the part boarded loft which has both light and power. Bedroom one benefits from a bay window and built in storage, bedroom two is a second double to the rear and bedroom three a comfortable single. The bathroom comprises L shaped bath with screen and rainfall shower over, tiled flooring and elevations, wc and wash hand basin. With over 1100 square feet of accommodation, CCTV and plenty to offer both inside and out, this is a lovely family home.



Delightful three bedroom semi detached property in a quiet and sought after residential area close to schools, primary transport routes and village amenities with over 1100 square feet of accommodation. Available with no upward chain. Council Tax band: C

Tenure: Freehold

- Spacious semi detached property
- Over 1100 square feet
- Lovely dining kitchen
- Plenty of parking
- Sought after location
- No upward chain



HOME TRUTHS
SALES AND LETTING AGENT

Eccleston Branch

265 The Green, Eccleston, PR7 5TF
01257 451673

Coppull Branch

244 Spendmore Lane, Coppull, PR7 5DE
01257 794588

www.hometruthslancs.co.uk
office@hometruthslancs.co.uk



Park Rd

Ground Floor
65.4 sq m (approx)
704 sq f (approx)

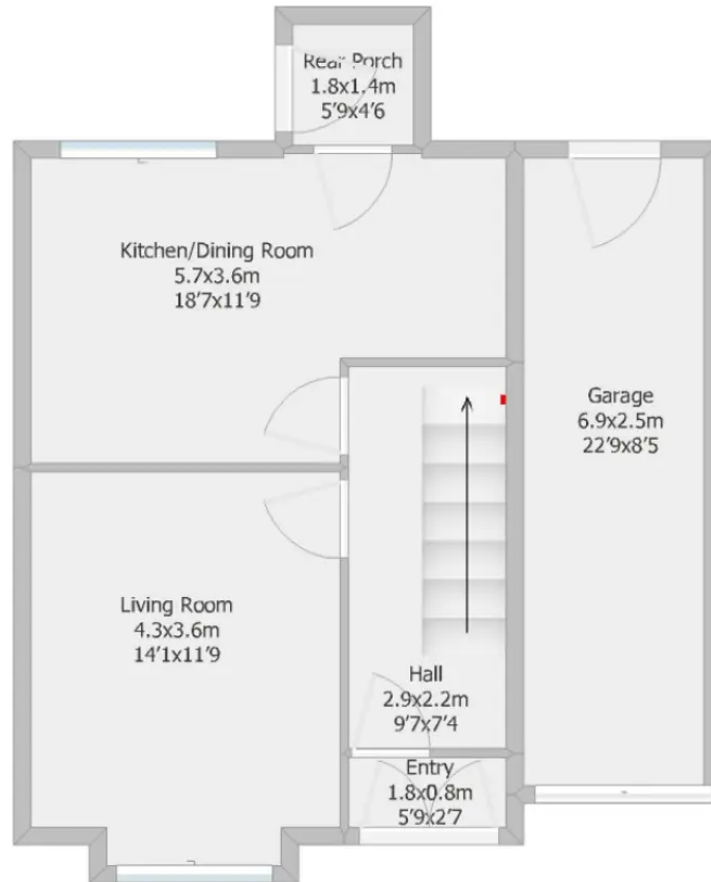

First Floor
42.8 sq m (approx)
460.7 sq f (approx)

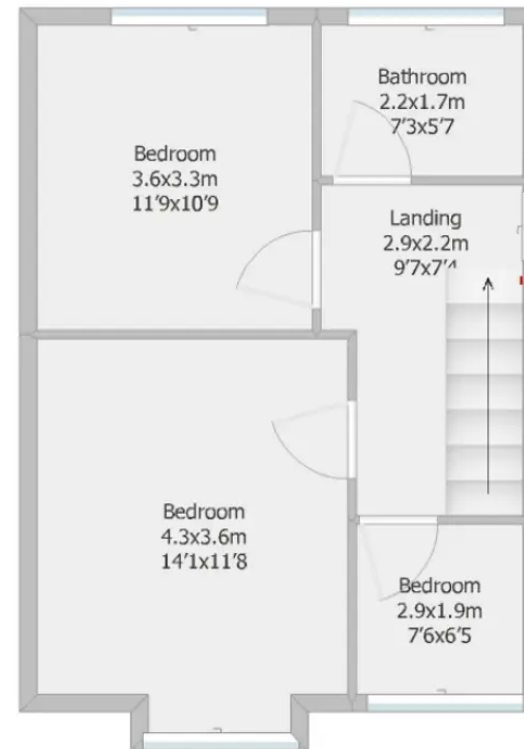

Floor plan not to scale and is for illustrative purposes only.
Plan produced with RoomSketch.