



These particulars are prepared diligently and all reasonable steps are taken to ensure their accuracy. Neither the company or a seller will however be under any liability to any purchaser or prospective purchaser in respect of them. The description, Dimensions and all other information is believed to be correct, but their accuracy is no way guaranteed. The services have not been tested.

**Any floor plans shown are for identification purposes only and are not to scale**

Directors: Paul Carruthers Stephen Luck

233a South Coast Road,  
Peacehaven. BN10 8LD  
Tel: **01273 585001**  
e:peacehaven@carruthersandluck.co.uk

7 Longridge Avenue, Saltdean. BN2 8LG  
Tel: 01273 303064  
e:saltdean@carruthersandluck.co.uk

Lettings department:  
233a South Coast Road, BN10 8LD  
e: lettings@carruthersandluck.co.uk  
Company registration no: 08884155

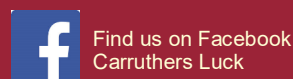

Find us on Facebook  
Carruthers Luck



Follow us on  
Instagram  
@carruthersandluck



# C&L

**carruthersandluck**  
salesandlettings

## 27 Abbey Close, Peacehaven, BN10 7SD

EPC : C

### £269,950



[www.carruthersandluck.co.uk](http://www.carruthersandluck.co.uk)

This well presented 2 bedroom house is situated in a popular close in Peacehaven, located close to local shop and bus services to Brighton City Centre and Newhaven Town Centre with its easy access to Newhaven Train Station and Newhaven Harbour.

The property comprises of a good size dual aspect lounge/dining room, kitchen, entrance porch with access to a large storage cupboards, two double bedrooms and a bathroom/wc which is fitted with a white suite.

Benefits include double glazing, gas central heating, garage, front and rear gardens.

**The accommodation with approximate room measurements comprises:**

**ENTRANCE PORCH 5'11" x 3'3" (1.80m x 1.00m)**

**STORAGE CUPBOARD 5'8" x 5'2" (1.72m x 1.57m)**

**DUAL ASPECT LOUNGE/DINING ROOM 21'7" max x 15'9" max (6.57m x 4.81m)**

**KITCHEN 8'6" x 7'10" (2.59m x 2.38m)**

**FIRST FLOOR LANDING**

**SOUTH FACING BEDROOM 1 12'2" x 9'5" (3.71m x 2.86m)**

**BEDROOM 2 11'11" x 8'6" (3.63m x 2.59m)**

**BATHROOM/WC 6'10" x 5'6" (2.08m x 1.67m)**

**OUTSIDE**

**FRONT GARDEN**

**GARAGE (in a block at rear) 16'2" max x 8' max (internal measurements ) (4.93m x 2.44m)**

**REAR GARDEN**

GROUND FLOOR  
36.6 sq.m. (394 sq.ft.) approx.

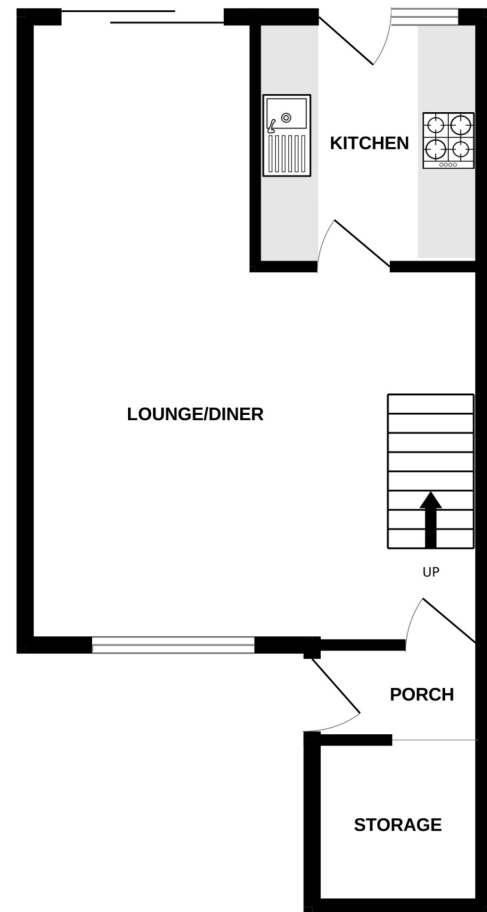

1ST FLOOR  
31.5 sq.m. (339 sq.ft.) approx.

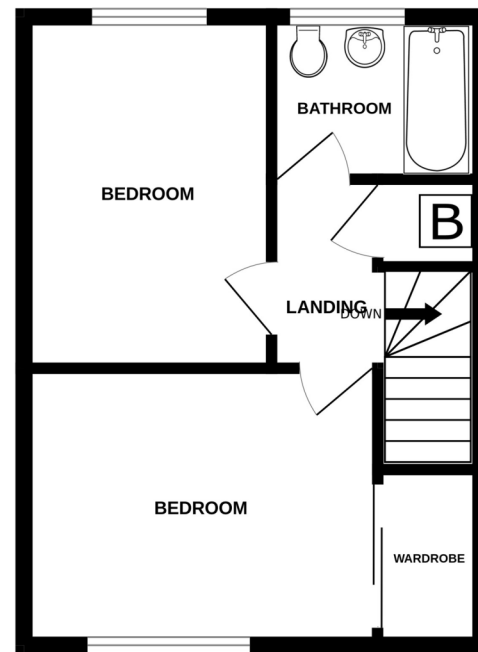

27 ABBEY CLOSE PEACEHAVEN

TOTAL FLOOR AREA: 68.1 sq.m. (733 sq.ft.) approx.

Whilst every attempt has been made to ensure the accuracy of the floorplan contained here, measurements of doors, windows, rooms and any other items are approximate and no responsibility is taken for any error, omission or mis-statement. This plan is for illustrative purposes only and should be used as such by any prospective purchaser. The services, systems and appliances shown have not been tested and no guarantee as to their operability or efficiency can be given.  
Made with Metropix ©2023