



MOCKFORD & HUNT

Caring about your move

£300,000

Grosvenor Road, Kennington, Ashford, Kent, TN24



Property Description

This cosy and inviting home has been lived in by the current owners since the 1980's. The property has seen many changes over the years going from a 3 bed home with a ground floor bathroom to a light and airy 2 bedroom property with a good size first floor bathroom. The property has also had a ground floor extension to the front and rear creating a lovely flow to the accommodation.

The property now has an entrance porch, lobby and a cosy multi fuel burner in the lounge that you are bound to enjoy during those winter months.

For anyone looking to work from home, the summer house with power and lighting could easily be a garden office as it has been used as in the past or even an occasional room to put up guests.

If having a good size garden is important to you, you will be in your element here. With a private secluded outlook and stunning well established borders and a good size lawn, this will be a real retreat to sit and relax on the decking or try your hand at growing your own veg on the established plot to the end of the garden. There is even a substantial workshop/ shed to the rear of the garden that could be a great hobby space.

There is off road parking to the front of the property for 2 cars.





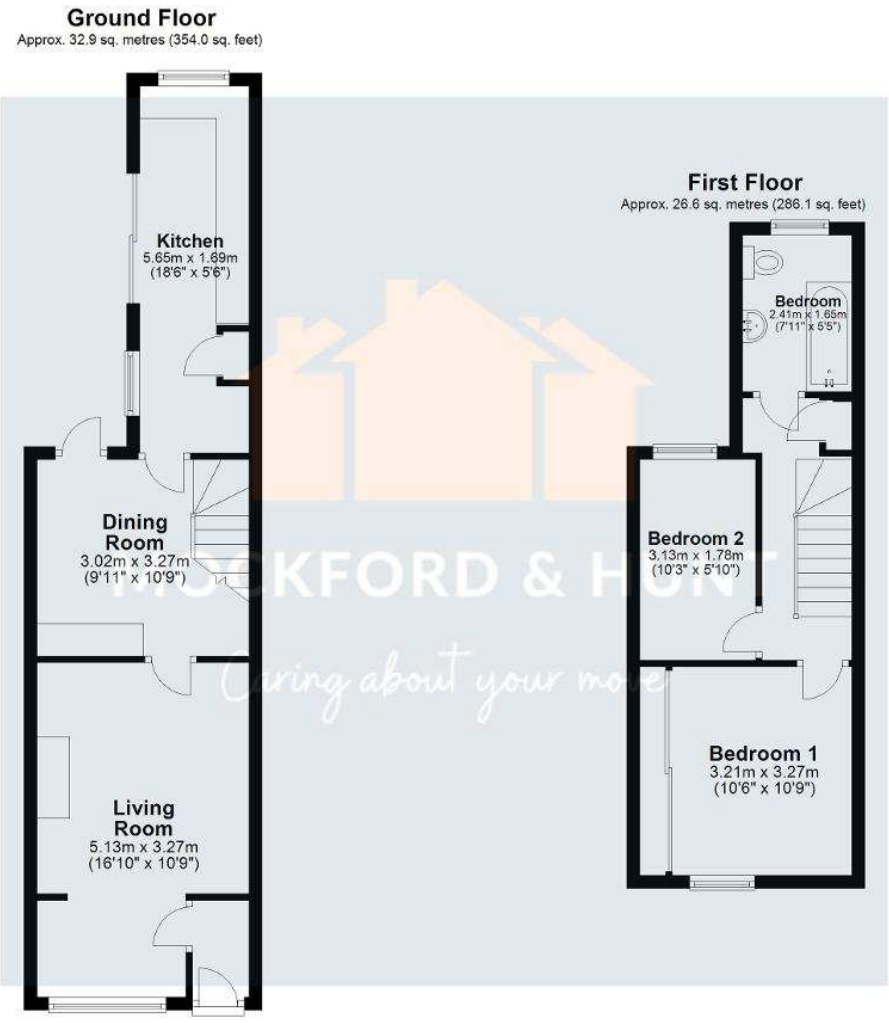

Total area: approx. 59.5 sq. metres (640.2 sq. feet)
 Floor Plan measurements are approximate and are for illustrative purposes only.
 Plan produced using PlanUp.

Energy Efficiency Rating

Score	Energy rating	Current	Potential
92+	A		
81-91	B		86 B
69-80	C		
55-68	D		
39-54	E	39 E	
21-38	F		
1-20	G		

