

EH

EXQUISITE  
HOME



## WIDE OPEN SPACES

Six miles southwest of Cambridge is the village of Newton. The old coaching road between London and Cambridge was once the lifeblood of this region and many communities along it owed their prosperity to the travellers who went between the two cities. Newton is mentioned in the Domesday Book and has an unusually large number of listed buildings for its size. The parish church is Grade II\* listed and dates back to the early thirteenth century. There is also a pub which has been running in the village since the early eighteenth century and has the distinction of appearing in every edition of the Good Beer Guide since its inception. On the outskirts of the village, which is roughly equidistant between the M11 and the A10, is this smart, elegant one-storey home built around seventy years ago and extended in the nineteen eighties and nineties. The present owners bought it in 2021 attracted by its quiet location, beautiful garden, plethora of wildlife and the quirky hatch/door between the children's bedrooms. Since moving in, they have installed a new kitchen, redecorated, replaced the windows, put in a utility room and a new bathroom and laid new flooring throughout.





The road running past the property is a quiet country lane and the house is approached via a large gravelled drive where there is plenty of room to park, making it the ideal hosting house. Painted in white with smart, on trend dark grey windows and doors, it is a striking property, immaculate within and without. The front door opens into the small, square entrance hall paved in slate and to the left is the light and airy kitchen/breakfast room. This lovely space is typical of the entire house, crisp and contemporary in design and uniting style and functionality. The kitchen cabinets are painted in striking matte navy blue, there is an exposed brick wall, solid wooden worktops, a dual fuel range cooker with gas hob, an island with on trend pendant lighting over it and a built-in speaker and exposed beams. The kitchen also benefits from an integrated dishwasher, fridge freezer and beer fridge. The owners love cooking and entertaining in their beautiful kitchen and it is ideal for any family configuration. Particularly for anyone with young children, this part of the house is perfect for cooking and serving family meals and children's parties.

The dining area is spacious and flooded with natural light from the large bay window. The layout lends itself extremely well to entertaining. Since moving in, the owners have hosted their work Christmas party and an annual Bonfire Night celebration with fireworks in the garden. There is more than enough room to accommodate guests very comfortably and the large garden is ideal for parties. Next door to the dining room is the useful utility room with a second sink and more cupboard space. A small lobby leads to the three piece shower room and study, ideal for those who have to work from home. This wing of the house is completed by a light-filled bedroom with a fitted cupboard.

The living room opens up from the right of the hallway, elegant, spacious and simply flooded with natural light pouring through the two pairs of sliding doors on to the garden. It is dominated by a beautiful fireplace crafted from a single piece of wood with a wooden mantelpiece and tiled hearth. The family love to gather around their open fire in the winter and enjoy its cool, spacious proportions in summer and it makes a delightful focal point in the room. The wall behind the fireplace is painted in on trend navy, there are shelves on one wall and tongue and groove panelling. This is a room with more than enough space for family time and entertaining. A small lobby opens off the living room from which radiate three bedrooms and the family bathroom. The largest of these has a pair of double doors opening on to the garden, delightful on sunny days, as well as a built in cupboard. There are two further dual aspect double bedrooms currently used by the younger members of the family who particularly love the secret hatch between the two bedrooms, and the smart, contemporary family bathroom has a bath with shower over and an oval countertop basin and plenty of storage.



*A Stunning Contemporary Space*



*“The property is crisp and contemporary in design and uniting style and functionality...”*



# LOCATION

The large garden is mainly laid to lawn with a paved area around the back and side of it, ideal for al fresco dining or enjoying a drink after work. There are lovely views of the open countryside all around and more than enough room for a vegetable garden and fruit cage if desired. There are a number of mature trees and an attractive open sided garden room. The owners have built a large patio, pergola and treehouse which is much enjoyed by younger visitors to the house. The garden has been used a great deal for leisure and entertaining. The owners have hosted many barbecues and al fresco dining events and the generous parking, quiet rural location and delightful layout makes it the perfect house for hosting any number of social occasions.

Whittlesford, just three miles away, has two pubs and a primary school as well as a village shop, ideal for stocking up on essentials. Harston is a ten minute drive away and also has a primary school as well as a doctor's surgery and pub. Cambridge itself is only six miles north of Newton and easily accessible for shops, schools and leisure. Transport links are excellent and this part of the county is extremely well connected. In a beautiful rural location surrounded by open countryside, with plenty of off street parking, a large and charming garden and a versatile interior, this lovely family home offers spacious, flexible multi-generational living space and endless potential.

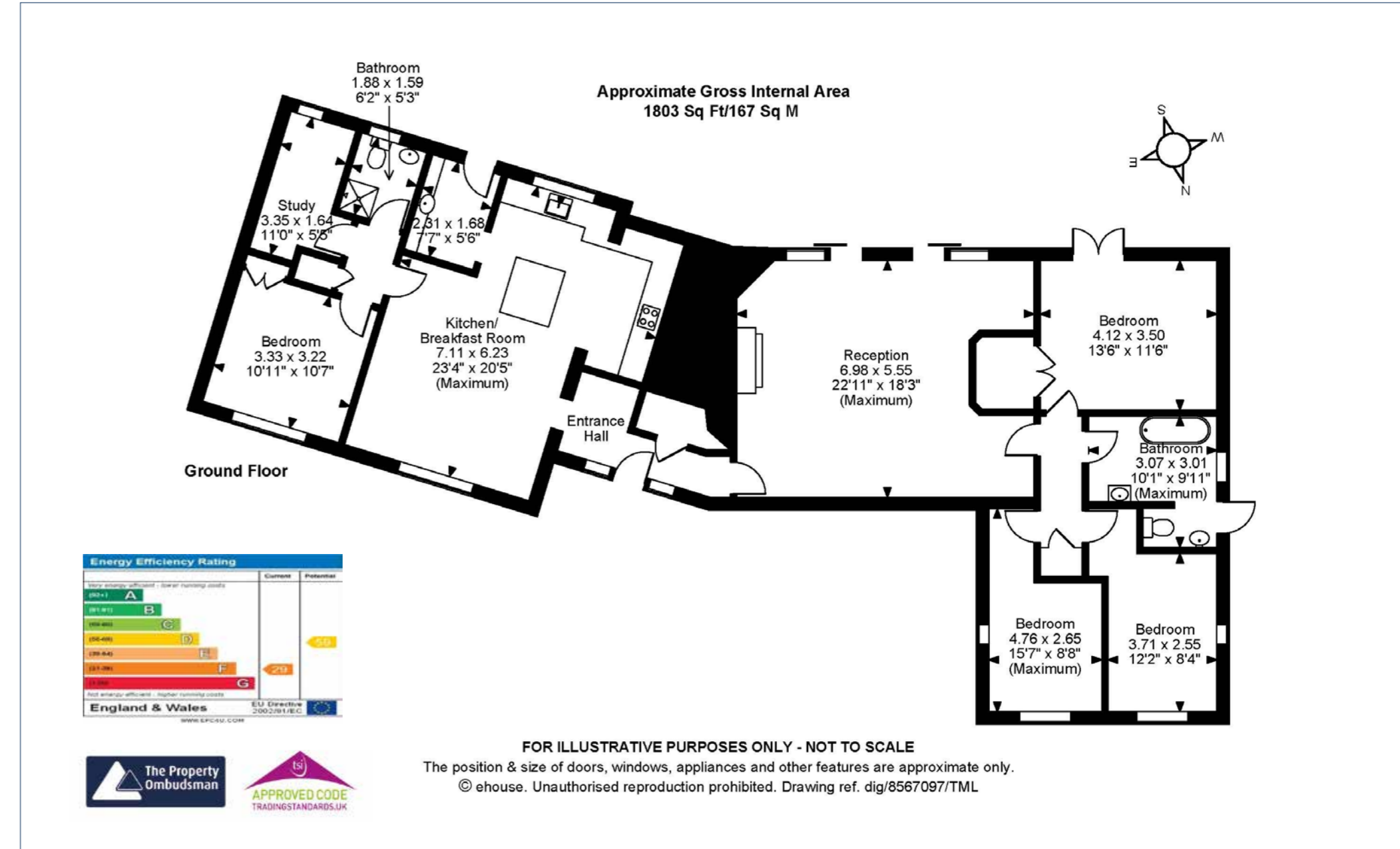

All measurements are approximate and quoted in imperial with metric equivalents and for general guidance only whilst every attempt has been made to ensure accuracy, they must not be relied on. The fixtures, fittings and appliances referred to have not been tested and therefore no guarantee can be given that they are in working order. Internal photographs are reproduced for general information and must not be inferred that any item shown is included with the property. These comments are the personal views of the current owner and are included as an insight into life at the property. They have not been independently verified and should not be relied on without verification and do not necessarily reflect the views of the agent. Registered in England and Wales, Company Reg No.10931078 Exquisite House, Alton Business Centre, Wherstead, Ipswich, Suffolk, United Kingdom, IP9 2AX.



Regional Office: Exquisite Home, Valley Lane, Wherstead, Ipswich, Suffolk, IP9 2AX  
T +44(0)3455 651681 E [enquiries@exquisitehome.co.uk](mailto:enquiries@exquisitehome.co.uk)

Exquisite Home, Sumpter House, 8 Station Road, Histon, Cambridge CB24 9LQ  
T +44(0)3455 651681 E [enquiries@exquisitehome.co.uk](mailto:enquiries@exquisitehome.co.uk)