



23 Hampton Road, Maidstone

Maidstone



Guide Price £350,000



23 Hampton Road

Maidstone, Maidstone

GUIDE PRICE £350,000 - £375,000 | Three Bedrooms | Open-Plan | Garage | South East Facing Garden | Immaculately Presented | Outside Log Cabin | Excellent Schools | Great Transport Links | Off-Street Resident Parking Bays | Sought-After Location
Council Tax band: D

Tenure: Freehold

EPC Energy Efficiency Rating: C

EPC Environmental Impact Rating: C

- GUIDE PRICE £350,000 - £375,000
- Three Bedrooms
- Open-Plan
- Garage
- South East Facing Garden
- Immaculately Presented
- Excellent Schools
- Great Transport Links
- Off-Street Resident Parking Bays
- Sought-After Location

GROUND FLOOR
397 sq.ft. (36.9 sq.m.) approx.

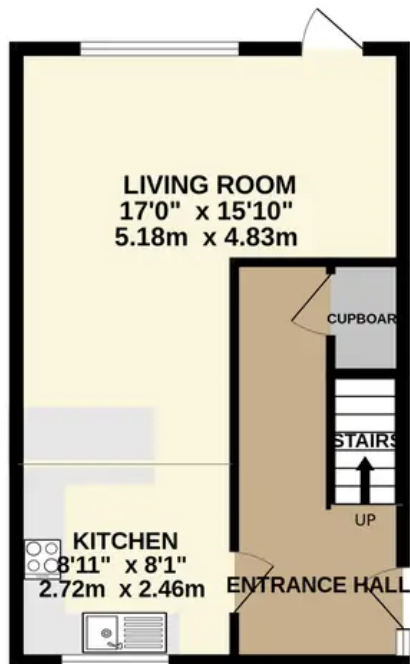

1ST FLOOR
397 sq.ft. (36.9 sq.m.) approx.

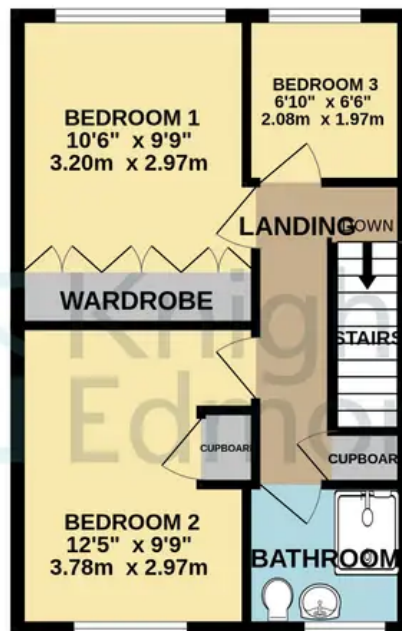

OUTBUILDINGS
0 sq.ft. (0.0 sq.m.) approx.

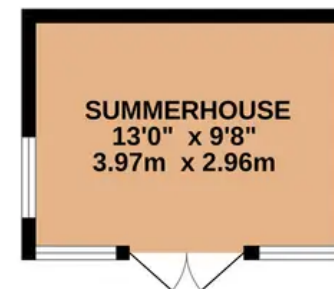
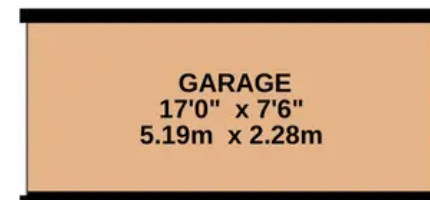

TOTAL FLOOR AREA: 794sq.ft. (73.8 sq.m.) approx.

Whilst every attempt has been made to ensure the accuracy of the floorplan contained here, measurements of doors, windows, rooms and any other items are approximate and no responsibility is taken for any error, omission or mis-statement. This plan is for illustrative purposes only and should be used as such by any prospective purchaser. The services, systems and appliances shown have not been tested and no guarantee as to their operability or efficiency can be given.

Made with Metropix ©2023





Keel
University

Making moving simple