



9 Longparish Close, Maidstone
£250,000

Knig
Edmond



9 Longparish Close

Maidstone, Maidstone

Chain Free | Two Double Bedrooms | Spacious Living Area | Popular Location | Wet Room | Garden
Tenure: Freehold

EPC Energy Efficiency Rating: E

EPC Environmental Impact Rating: E

- Chain Free
- Close to Schools
- Good Transport Links
- Great Investment Opportunity
- Popular Quiet Location



GROUND FLOOR
403 sq.ft. (37.4 sq.m.) approx.



1ST FLOOR
410 sq.ft. (38.1 sq.m.) approx.

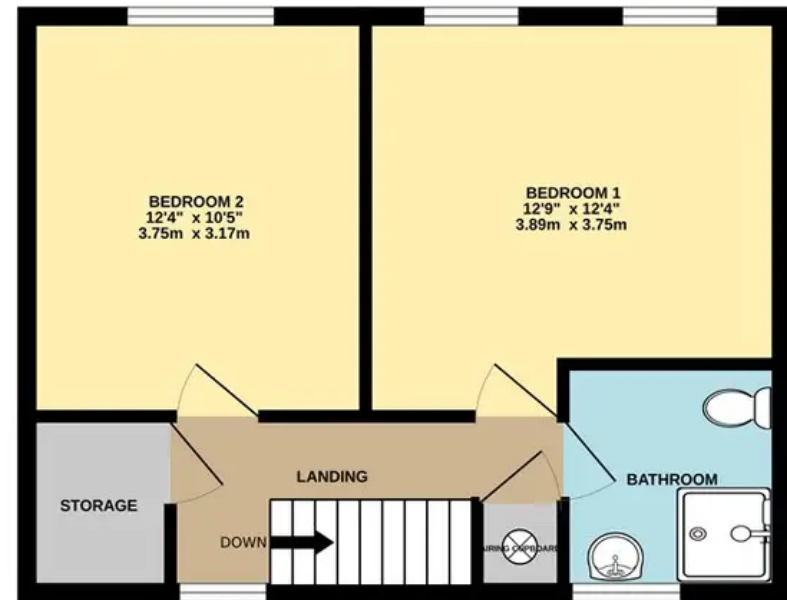

TOTAL FLOOR AREA : 813 sq.ft. (75.5 sq.m.) approx.

Whilst every attempt has been made to ensure the accuracy of the floorplan contained here, measurements of doors, windows, rooms and any other items are approximate and no responsibility is taken for any error, omission or mis-statement. This plan is for illustrative purposes only and should be used as such by any prospective purchaser. The services, systems and appliances shown have not been tested and no guarantee as to their operability or efficiency can be given.

Made with Metropix ©2023



Scan to
book a
viewing!



Scan to
view
online!

