

Home Farm Court

Castle Gresley,

DE11 9JA

£210,000

A modern SEMI DETACHED home located on Home Farm Court. Boasting THREE BEDROOMS and being very well presented throughout with a glorious kitchen diner with patio doors to the rear garden which is low maintenance. There is a fantastic frontage, being set back from the road and offering off road parking for two vehicles.



Property Features

- Semi Detached
- Popular Location
- Lounge
- Well Presented Throughout
- Kitchen Diner
- Shower Room
- Three Bedrooms
- Rear Garden
- Off Road Parking
- Low Maintenance Rear

Full Description

Home Farm Court is located just off Burton Road in a cul de sac. Built in 1999, Home Farm Court is not part of a large estate and is in fact just one road with a selection of detached and semi detached properties. This property is marketed for £210,000 and is well presented throughout with a low maintenance rear garden and off road parking to the front.

This property has had the love and attention from its current owners and its clear to see when you enter the front door of this property. On entry, you are welcomed into the entrance hall which provides access to the lounge and stairs to the first floor. The lounge, is well presented with neutral decor and ideal for anyone looking to move straight into. The lounge provides access to the kitchen. The kitchen offering a breakfast bar island, integrated appliances, pantry and patio double doors to the rear garden makes this a must see.

To the first floor, there are three bedrooms, which again, are neutrally decorated and offer a good size with the master bedroom facing the front aspect of the property. There is another double bedroom to the rear aspect and the third bedroom is currently being used dressing room and currently offering built in wardrobes. A shower room which has recently been improved just off the landing completes the first floor accommodation.

Externally, to the front of the property there is off road parking for a couple of vehicles and enough space to store a caravan or motorhome. There is a low maintenance front garden which offer artificial grass. The rear garden boasts a good sized patio area, flowered borders, artificial grass and shed to the bottom of the garden.

Home Farm Court is positioned off Burton Road and is ideally located with plenty of countryside walks on your doorstep you can enjoy the convenience of being quietly tucked away whilst being within very close proximity of all of Gresley and Swadlincotes excellent amenities. With schools of all grades, shops catering for all day to day needs, recreational amenities and regular bus services into both Swadlincote and Burton town centres, the National Forest is on your doorstep with conkers visitor centre close by, the M42 also provides easy access to many East & West midlands towns and cities including Tamworth, Birmingham & Ashby de la Zouch.

COUNCIL TAX BAND C





Ground Floor

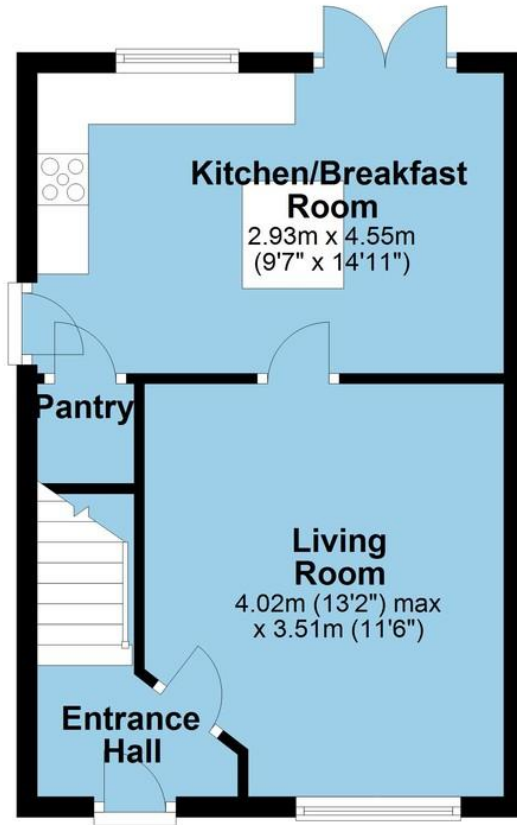

First Floor

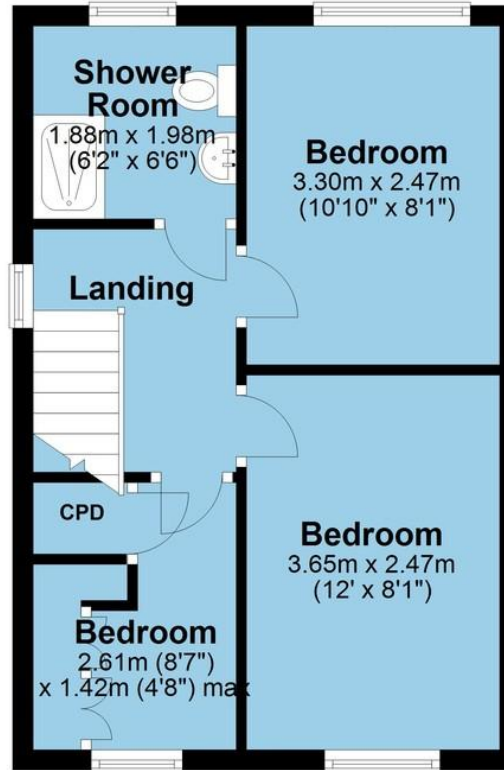

Total area: approx. 64.2 sq. metres (691.4 sq. feet)

Score	Energy rating	Current	Potential
92+	A		
81-91	B		85 B
69-80	C	80 C	
55-68	D		
39-54	E		
21-38	F		
1-20	G		

8 The Pass Courtyard
43 Market Street
Ashby-De-La-Zouch
Leicestershire
LE65 1AG

www.whiteheadsestates.co.uk
info@whiteheadsestates.co.uk
01530 353170

Agents Note: Whilst every care has been taken to prepare these sales particulars, they are for guidance purposes only. All measurements are approximate and for general guidance purposes only and whilst every care has been taken to ensure their accuracy, they should not be relied upon and potential buyers are advised to recheck the measurements