

Ford Way

Armitage, Rugeley, WS15 4BX



A superbly presented three bedroom dormer bungalow situated in the popular village of Armitage with Handsacre and being offered to the market with no upward chain.

£240,000

John German 

This delightful three bedroom bungalow is situated on Ford Way in Armitage With Handsacre, a popular village located approximately six miles from the Cathedral city of Lichfield and just four miles from the nearby market town of Rugeley. The village offers a range of amenities including village shops, post office plus a choice of takeaways and pubs. For local schooling it falls into the catchment area for Hayes Meadow Primary School, in the adjoining village of Handsacre, and for secondary is the Hart School in Rugeley. For commuters, nearby road links include the A51, A5 and M6 motorways, as well as the choice of train stations in the nearby city of Lichfield and market town of Rugeley, offering local and cross-country services.

The property has been tastefully decorated and finished to an excellent standard throughout. There is a spacious open plan living area with lounge-diner and newly fitted modern with a range of integrated kitchen appliances.

There is a welcoming open reception hallway, a modern fitted shower room and two double bedrooms on the ground floor. Upstairs there is a third double bedroom with two Velux skylights and a modern fitted shower room.

Outside the property features a delightful private low maintenance rear garden with large patio seating area and a generous range of plants, trees and shrubs. To the front of the property is a large driveway providing parking for several vehicles.

Tenure: Freehold (purchasers are advised to satisfy themselves as to the tenure via their legal representative).

Services: Mains water, drainage, electricity and gas are believed to be connected to the property but purchasers are advised to satisfy themselves as to their suitability.

Useful Websites:

www.gov.uk/government/organisations/environment-agency

Our Ref: JGA12092023

Local Authority/Tax Band: Lichfield / Tax Band B

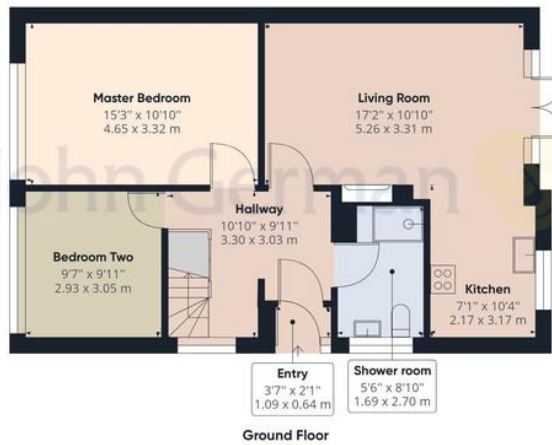

Ground Floor



Floor 1

John German

Approximate total area⁽¹⁾

935.62 ft²

86.92 m²

Reduced headroom

62.56 ft²

5.81 m²

(1) Excluding balconies and terraces

Reduced headroom (below 1.5m/4.92ft)

While every attempt has been made to ensure accuracy, all measurements are approximate, not to scale. This floor plan is for illustrative purposes only.

GIRAFFE360





Score	Energy rating	Current	Potential
92+	A		
81-91	B		
69-80	C		76 C
55-68	D	63 D	
39-54	E		
21-38	F		
1-20	G		



John German
 22 Bore Street, Lichfield, Staffordshire, WS13 6LL
 01543 419121
 lichfield@johngerman.co.uk

Agents' Notes
 These particulars do not constitute an offer or a contract neither do they form part of an offer or contract. The vendor does not make or give and Messrs. John German nor any person employed has any authority to make or give any representation or warranty, written or oral, in relation to this property. Whilst we endeavour to make our sales details accurate and reliable, if there is any point which is of particular importance to you, please contact the office and we will be pleased to check the information for you, particularly if contemplating travelling some distance to view the property. None of the services or appliances to the property have been tested and any prospective purchasers should satisfy themselves as to their adequacy prior to committing themselves to purchase.

Referral Fees
Mortgage Services - We routinely refer all clients to APR Money Limited. It is your decision whether you choose to deal with APR Money Limited. In making that decision, you should know that we receive on average £60 per referral from APR Money Limited.
Conveyancing Services - If we refer clients to recommended conveyancers, it is your decision whether you choose to deal with this conveyancer. In making that decision, you should know that we receive on average £150 per referral.
Survey Services - If we refer clients to recommended surveyors, it is your decision whether you choose to deal with this surveyor. In making that decision, you should know that we receive up to £90 per referral.

Ashbourne | Ashby de la Zouch | Barton under Needwood
 Burton upon Trent | Derby | East Leake | Lichfield
 Loughborough | Stafford | Uttoxeter

JohnGerman.co.uk Sales and Lettings Agent