



Property Summary

Immaculate and extended semi detached home in the ever popular area of Western Park. The accommodation comprises dining room, lounge, kitchen, three bedrooms and bathroom to the first floor and loft conversion providing a fourth bedroom to the second floor. Outside there is a driveway to the front of the property and a pleasant well maintained garden to the rear.



GROUND FLOOR
406 sq ft. (37.7 sq.m.) approx.

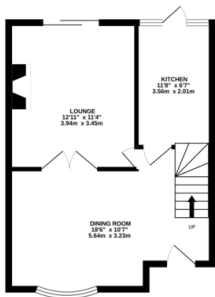

1ST FLOOR
403 sq ft. (37.5 sq.m.) approx.

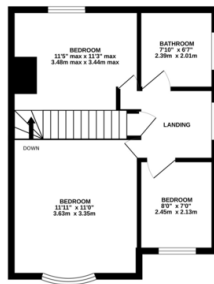

2ND FLOOR
180 sq ft. (16.8 sq.m.) approx.



TOTAL FLOOR AREA: 989 sq ft. (91.9 sq.m.) approx.

Whilst every attempt has been made to ensure the accuracy of the floorplan contained here, measurements of doors, windows, rooms and any other items are approximate and no responsibility is taken for any error, omission or mis-statement. This plan is for illustrative purposes only and should be used as such by any prospective purchaser. The services, systems and appliances shown have not been tested and no guarantee as to their operability or efficiency can be given.
Made with Metropac CS23

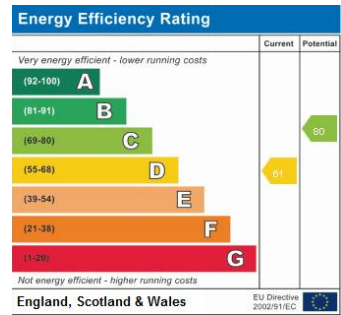

- Four Bedrooms
- Popular Location
- Immaculate Throughout
- Off Road Parking
- Well Maintained Rear Garden
- Ideal Family Home
- Semi Detached
- Two Reception Rooms

phillips george | sales & lettings

Agents Note: Whilst every care has been taken to prepare these sales particulars, they are for guidance purposes only. All measurements are approximate and for general guidance purposes only and whilst every care has been taken to ensure their accuracy, they should not be relied upon and potential buyers are advised to recheck the measurements

🏠 46 Long Street, Wigston, Leicestershire, LE18 2AH

✉ info@phillipsgeorge.co.uk
☎ 0116 216 8178

