



4 Darlington Street, Coppull

PR7 5AB



£675 pcm



Two bedroom end terrace property close to all village amenities and excellent schools. This spacious and well-presented property is ready to move in to and available immediately.

Step into the spacious reception room where a stone fireplace has been opened up and stairs lead off to the first floor and a door to the breakfast kitchen which comprises a range of wall and base units and integrated appliances including fridge, freezer, electric oven and grill, gas hob with extractor over and tiled flooring and splashbacks. A door leads to the private south facing courtyard garden which is a great place to relax at the end of the day.



To the first floor are two good sized bedrooms and the bathroom comprising tiled flooring and elevations, bath with mixer shower over, wc and pedestal wash hand basin.

The property is available now and requires a deposit of £778 including holding deposit of £155. The Zero Deposit Scheme is also available.

Council Tax Band: A

- TWO BEDROOMS
- MODERN BATHROOM AND KITCHEN
- PRIVATE YARD
- AVAILABLE NOW
- ZERO DEPOSIT SCHEME AVAILABLE



Eccleston Branch
265 The Green, Eccleston, PR7 5TF
01257 451673

Coppull Branch
244 Spendmore Lane, Coppull, PR7 5DE
01257 794588

www.hometruthslancs.co.uk
office@hometruthslancs.co.uk



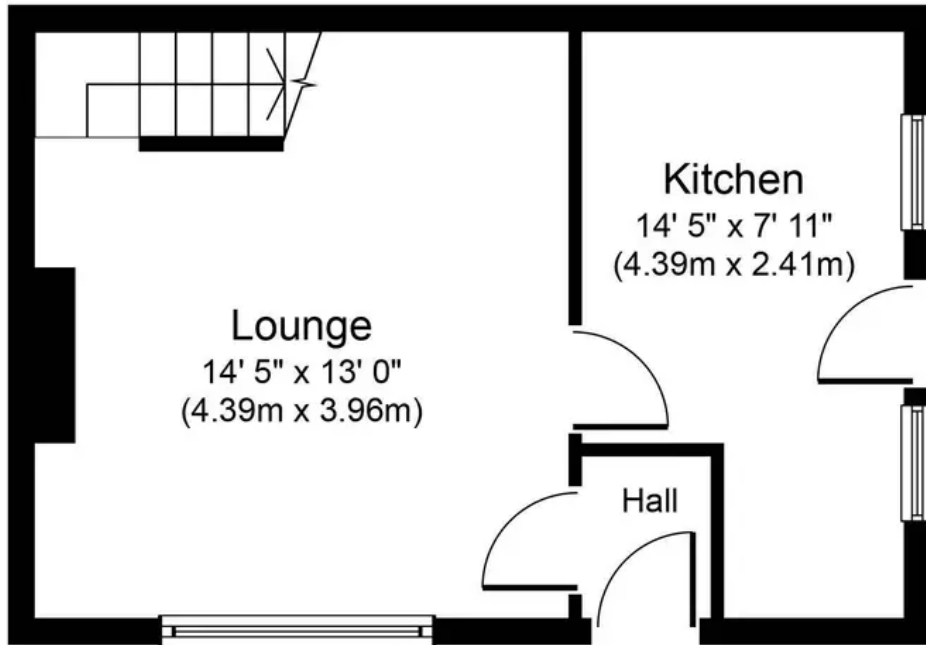

Ground Floor
Approximate Floor Area
308 sq. ft.
(28.6 sq. m.)

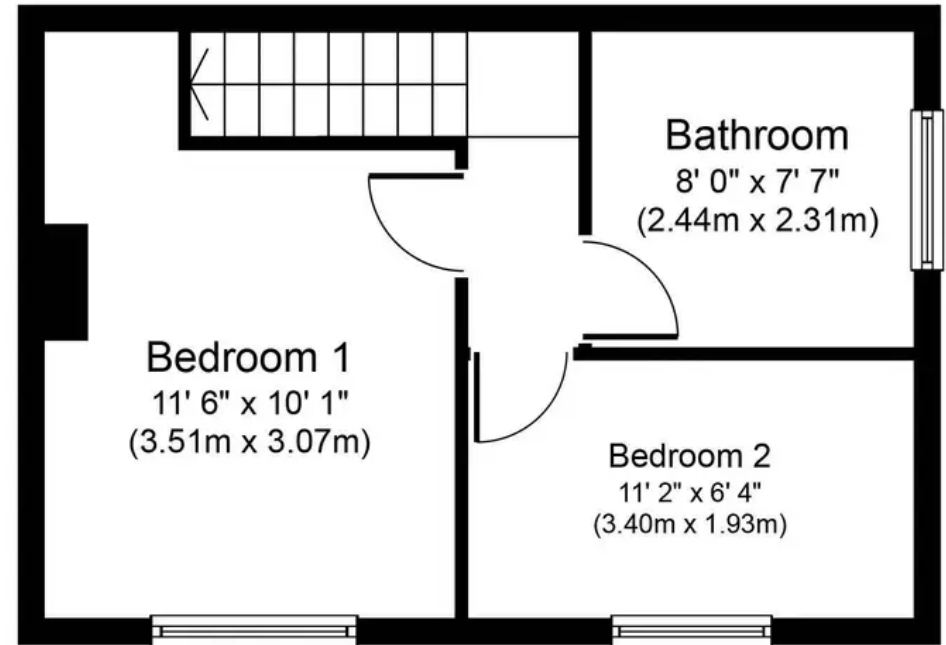

First Floor
Approximate Floor Area
308 sq. ft.
(28.6 sq. m.)

Whilst every attempt has been made to ensure the accuracy of the floor plan contained here, measurements of doors, windows, rooms and any other items are approximate and no responsibility is taken for any error, omission, or mis-statement. This plan is for illustrative purposes only and should be used as such by any prospective purchaser or tenant. The services, systems and appliances shown have not been tested and no guarantee as to their operability or efficiency can be given.